

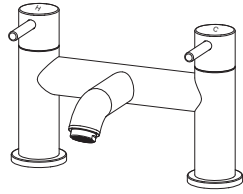

# Installation and operation instruction



Consult a qualified plumber if you have any problems installing this product

## Guarantee & Aftercare

When installing or using tools, extra care must be taken to avoid damaging the finish or fitting. To maintain the appearance, please ensure it is cleaned regularly using a clean soft damp cloth only. Abrasive cleaners or detergents must not be used as they may cause surface deterioration. The company provides a guarantee against faulty material or manufacture excluding serviceable parts, providing they have been installed, cared for and used in accordance with our instructions.

### What you receive is whole unit, please.

1. Remove Plastic nut 5 and Rubber washer 4 accessories in turn.
2. Put the two G3/4 inlet connector pipe of tap body into the mounting holes on the bathtub top.
3. Put two Rubber washer 4 on the G3/4 connector pipe 3, and then fix the tap body with plastic nut 5 .
4. Connect the two G3/4 inlet connector pipes to cold and hot water supply separately .
5. Connect cold and hot water, and check all water feed connections to ensure there are no leaks.

### Use and maintenance Figure II

1. After using for a period of time, if the handle is found to be loose or shaking, the maintenance can be carried out according to the following methods:
  - 1.1. Screw off the handle spindle by hand, and then tighten the M 6 screw with S 3 Allen Key.
  - 1.2. Turn the handle to check whether the handle still shakes. If not, install the handle spindle.
2. Turn the left handle clockwise to turn on the hot water, and turn the right handle counter clockwise to turn on the cold water.

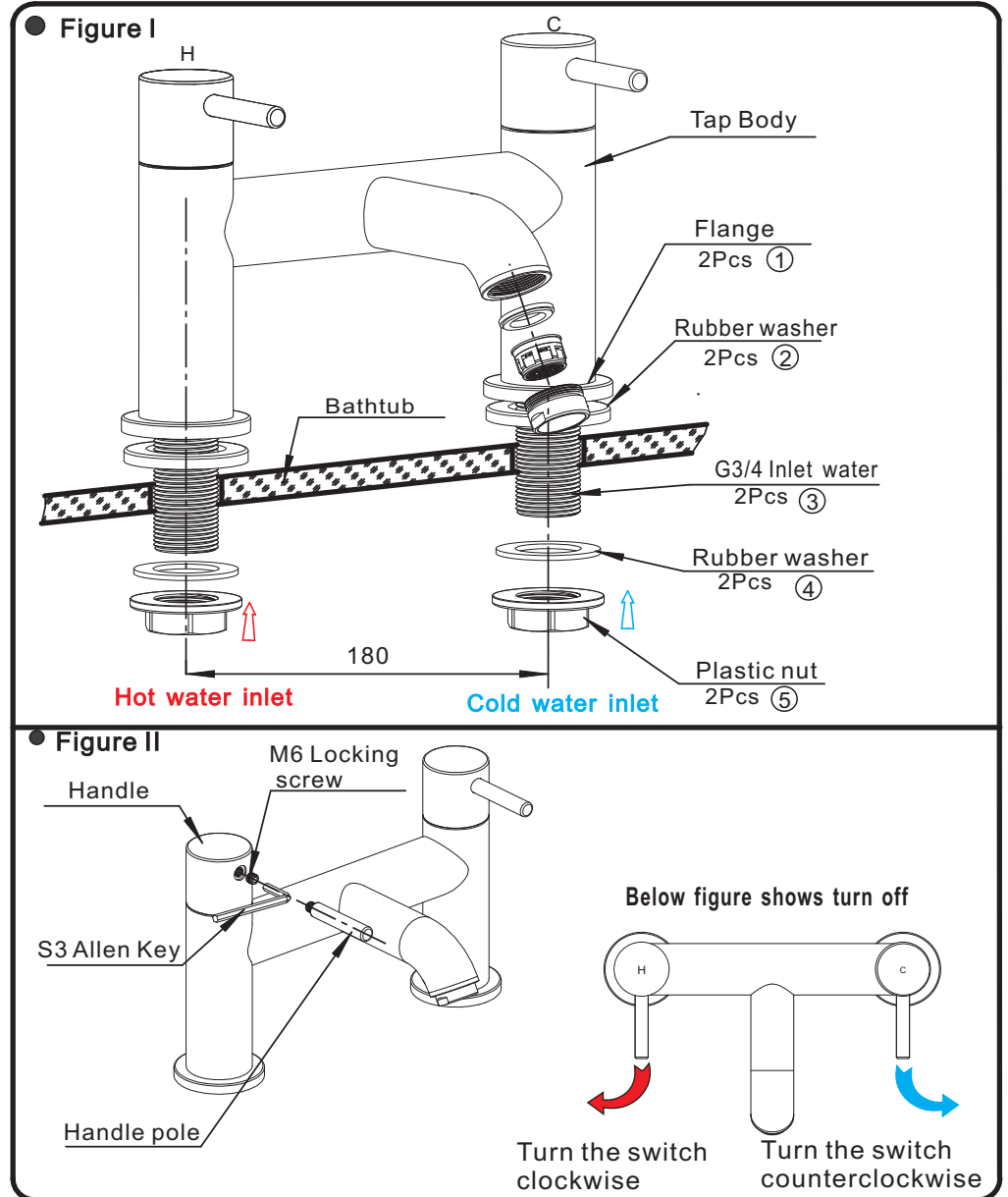

**All products must comply with regulations of Local Water Authority as contained in their by-laws.**

**If the product is not supplied with balanced pressure, the mixer will not function properly. Non-return valves should be fitted on both the hot and cold feeds as close to the tap as possible (non-return valves not provided).**