



Submittal Data Information

U Tube Heat Exchangers

201-019

30" DIAMETER LIQUID

EFFECTIVE: APRIL 15, 1995

Job: _____

Item No	Model No	Pass	GPM Tubes	Temp. In	Temp. Out	P.D. Tubes	Vel. Tubes	GPM Shell	Temp. In	Temp. Out	P.D. Shell	Vel. Shell

Tube Fluid _____ Shell Fluid _____

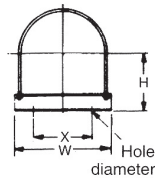

SADDLES
(Optional)

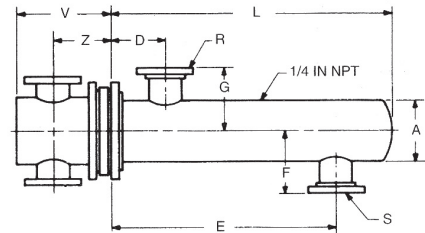
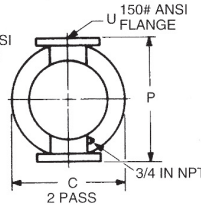
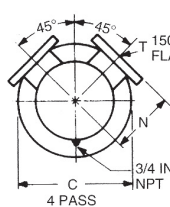

DIMENSIONS

30 Inch Diameter

Model Number		Fabricated Steel Heads								Dimensions (inches)								Heating Surface (sq. ft.)	Shipping Weight (lbs.)	
2 Pass	4 Pass	2 Pass				4 Pass				2 and 4 Pass										
		P	U	V	Z	N	T	V	Z	A	C	D	E	F	G	L	R	S		
G30210L	G30410L	42	14F	31 ⁷ / ₈	21 ¹ / ₈	20 ³ / ₄	10F	28 ⁷ / ₈	19 ⁵ / ₈	30	38 ³ / ₄	11	47	20 ³ / ₄	20 ³ / ₄	62	10F	10F	663.4	3205
G30212L	G30412L	42	14F	31 ⁷ / ₈	21 ¹ / ₈	20 ³ / ₄	10F	28 ⁷ / ₈	19 ⁵ / ₈	30	38 ³ / ₄	11	59	20 ³ / ₄	20 ³ / ₄	74	10F	10F	806.3	3524
G30214L	G30414L	42	14F	31 ⁷ / ₈	21 ¹ / ₈	20 ³ / ₄	10F	28 ⁷ / ₈	19 ⁵ / ₈	30	38 ³ / ₄	11	71	20 ³ / ₄	20 ³ / ₄	86	10F	10F	949.2	3843
G30216L	G30416L	42	14F	31 ⁷ / ₈	21 ¹ / ₈	20 ³ / ₄	10F	28 ⁷ / ₈	19 ⁵ / ₈	30	38 ³ / ₄	11	83	20 ³ / ₄	20 ³ / ₄	98	10F	10F	1092.0	4162
G30218L	G30418L	42	14F	31 ⁷ / ₈	21 ¹ / ₈	20 ³ / ₄	10F	28 ⁷ / ₈	19 ⁵ / ₈	30	38 ³ / ₄	11	95	20 ³ / ₄	20 ³ / ₄	110	10F	10F	1235.0	4481
G30220L	G30420L	42	14F	31 ⁷ / ₈	21 ¹ / ₈	20 ³ / ₄	10F	28 ⁷ / ₈	19 ⁵ / ₈	30	38 ³ / ₄	11	107	20 ³ / ₄	20 ³ / ₄	122	10F	10F	1378.0	4800

SADDLE DIMENSIONS: H-21; W-33; X-22; Hole Dia.-7/8.

MATERIALS OF CONSTRUCTION (Unless otherwise indicated, standard will be furnished.)

	Standard	Optional
Shell	Steel	304ss, 316ss
Head	Cast Iron 4-10" Fabricated Steel 12-30"	Fabricated Steel, Cast Bronze, Fabricated 304ss/316ss Cast Bronze, Fabricated 304ss/316ss
Tubes	3/4 x 20 BWG Copper	3/4 x 18 BWG Copper, Steel, 304ss, 316ss, 90/10 Cu Ni, Admiralty
Tube Sheet	Steel	Bronze, Brass, 304ss, 316ss, 90/10 Cu Ni
Separators	Steel	Bronze, Brass, 304ss, 316ss, 90/10 Cu Ni
Working Pressure	150 PSIG (ASME)	Consult Factory
Max. Temperature	375°F	Consult Factory

All dimensions shown are subject to change and should not be used for pre-piping. Contact your local Taco representative should certified dimensional drawings be required.

Do it Once. Do it Right.

Taco, Inc., 1160 Cranston Street, Cranston, RI 02920 Telephone: (401) 942-8000 Fax: (401) 942-2360
 Taco (Canada), Ltd., 6180 Ordan Drive, Mississauga, Ontario L5T 2B3 Telephone: (905) 564-9422 Fax: (905) 564-9436
 Visit our website at: www.taco-hvac.com

Printed in USA
 Copyright 2007
 TACO, Inc.



Submittal Data Information

U Tube Heat Exchangers

201-009

8" DIAMETER LIQUID

EFFECTIVE: APRIL 30, 2018

SUPERSEDES: APRIL 15, 1995

Job: _____

Item No	Model No	Pass	GPM Tubes	Temp. In	Temp. Out	P.D. Tubes	Vel. Tubes	GPM Shell	Temp. In	Temp. Out	P.D. Shell	Vel. Shell

Tube Fluid _____ Shell Fluid _____

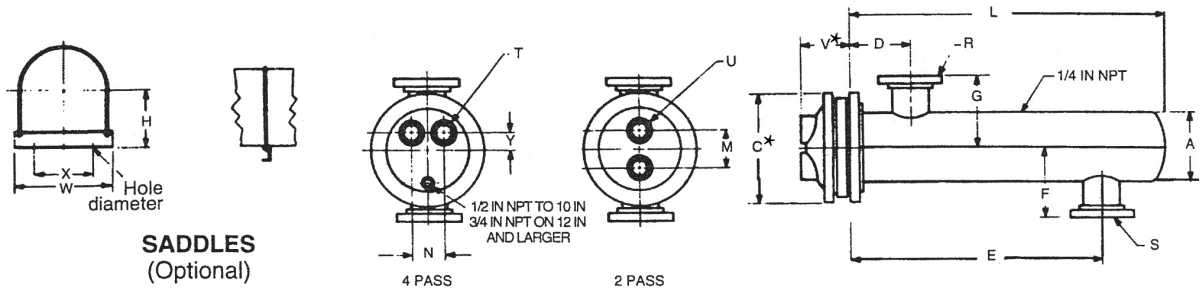

DIMENSIONS
8 Inch Diameter

Model Number		Cast Iron Heads						Dimensions (inches)										Heating Surface (sq. ft.)	Shipping Weight (lbs.)
2 Pass	4 Pass	2 Pass		4 Pass				2 and 4 Pass											
		M	U	N	T	Y	V*	A	C*	D	E	F	G	L	R	S			
G8204L	G8404L	5	3T	4	2T	2	4 1/4	8 5/8	13 1/2	7 1/4	17 1/4	9 1/4	9 1/4	24	4F	4F	16.5	192	
G8206L	G8406L	5	3T	4	2T	2	4 1/4	8 5/8	13 1/2	7 1/4	29 1/4	9 1/4	9 1/4	36	4F	4F	25.1	234	
G8208L	G8408L	5	3T	4	2T	2	4 1/4	8 5/8	13 1/2	7 1/4	41 1/4	9 1/4	9 1/4	48	4F	4F	33.7	283	
G8210L	G8410L	5	3T	4	2T	2	4 1/4	8 5/8	13 1/2	7 1/4	53 1/4	9 1/4	9 1/4	60	4F	4F	42.4	326	
G8212L	G8412L	5	3T	4	2T	2	4 1/4	8 5/8	13 1/2	7 1/4	65 1/4	9 1/4	9 1/4	72	4F	4F	51.0	369	
G8214L	G8414L	5	3T	4	2T	2	4 1/4	8 5/8	13 1/2	7 1/4	77 1/4	9 1/4	9 1/4	84	4F	4F	59.7	390	
G8216L	G8416L	5	3T	4	2T	2	4 1/4	8 5/8	13 1/2	7 1/4	89 1/4	9 1/4	9 1/4	96	4F	4F	68.3	453	
G8218L	G8418L	5	3T	4	2T	2	4 1/4	8 5/8	13 1/2	7 1/4	101 1/4	9 1/4	9 1/4	108	4F	4F	76.9	496	
G8220L	G8420L	5	3T	4	2T	2	4 1/4	8 5/8	13 1/2	7 1/4	113 1/4	9 1/4	9 1/4	120	4F	4F	85.6	540	

SADDLE DIMENSIONS: H-7 5/16; W-11 1/4; X-9; Hole Dia.-5/8.

MATERIALS OF CONSTRUCTION (Unless otherwise indicated, standard will be furnished.)

* When choosing any option with fabricated head type, refer to submittal 201-022 for head dimensions. Fabricated heads will feature flanged connections.

	Standard	Optional
Shell	Steel	304ss, 316ss
Head	Cast Iron 4-10" Fabricated Steel 12-30"	* Cast Bronze, Fabricated Steel, Fabricated 304ss/316ss Fabricated 304ss/316ss
Tubes	3/4 x 20 BWG Copper	3/4 x 18 BWG Copper, Steel, 304ss, 316ss, 90/10 Cu Ni
Tube Sheet	Steel	Brass, 304ss, 316ss, 90/10 Cu Ni
Separators	Steel	Brass, 304ss, 316ss, 90/10 Cu Ni
Working Pressure	150 PSIG (ASME)	Consult Factory
Max. Temperature	375°F	Consult Factory

All dimensions shown are subject to change and should not be used for pre-piping. Contact your local Taco representative should certified dimensional drawings be required.



Taco, Inc., 1160 Cranston Street, Cranston, RI 02920 | Tel: (401) 942-8000 | FAX: (401) 942-2360
 Taco (Canada), Ltd., 8450 Lawson Road, Suite #3, Milton, Ontario L9T 0J8 | Tel: (905) 564-9422 | FAX: (905) 564-9436
 Visit our web site: www.TacoComfort.com | Printed in USA | ©2017 Taco, Inc.





Submittal Data Information

U Tube Heat Exchangers

201-010

10" DIAMETER LIQUID

EFFECTIVE: APRIL 30, 2018

SUPERSEDES: APRIL 15, 1995

Job: _____

Item No	Model No	Pass	GPM Tubes	Temp. In	Temp. Out	P.D. Tubes	Vel. Tubes	GPM Shell	Temp. In	Temp. Out	P.D. Shell	Vel. Shell

Tube Fluid _____ Shell Fluid _____

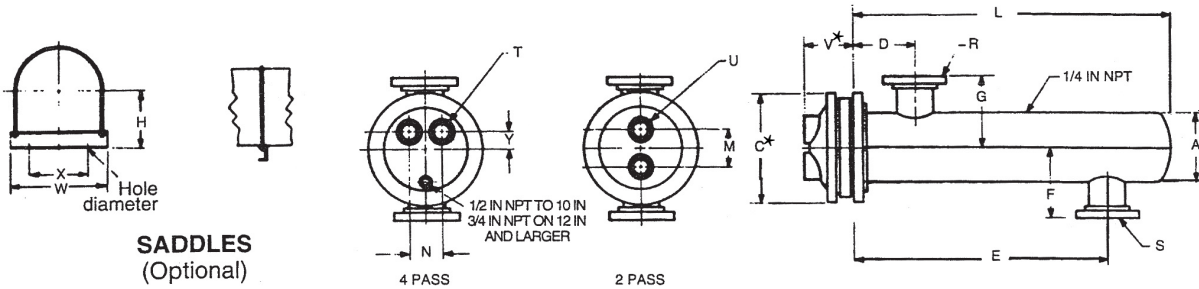

DIMENSIONS

10 Inch Diameter

Model Number		Cast Iron Heads						Dimensions (inches)										Heating Surface (sq. ft.)	Shipping Weight (lbs.)
2 Pass	4 Pass	2 Pass		4 Pass		2 and 4 Pass													
		M	U	N	T	Y	V*	A	C*	D	E	F	G	L	R	S			
G10204L	G10404L	6 1/4	3T	5 1/2	3T	2 1/4	4 7/8	10 3/4	16	7 1/4	16 1/2	10 1/2	10 1/2	24	4F	4F	26.8	300	
G10206L	G10406L	6 1/4	3T	5 1/2	3T	2 1/4	4 7/8	10 3/4	16	7 1/4	28 1/2	10 1/2	10 1/2	36	4F	4F	40.9	353	
G10208L	G10408L	6 1/4	3T	5 1/2	3T	2 1/4	4 7/8	10 3/4	16	7 1/4	40 1/2	10 1/2	10 1/2	48	4F	4F	55.0	415	
G10210L	G10410L	6 1/4	3T	5 1/2	3T	2 1/4	4 7/8	10 3/4	16	7 1/4	52 1/2	10 1/2	10 1/2	60	4F	4F	69.2	476	
G10212L	G10412L	6 1/4	3T	5 1/2	3T	2 1/4	4 7/8	10 3/4	16	7 1/4	64 1/2	10 1/2	10 1/2	72	4F	4F	83.3	537	
G10214L	G10414L	6 1/4	3T	5 1/2	3T	2 1/4	4 7/8	10 3/4	16	7 1/4	76 1/2	10 1/2	10 1/2	84	4F	4F	97.5	598	
G10216L	G10416L	6 1/4	3T	5 1/2	3T	2 1/4	4 7/8	10 3/4	16	7 1/4	88 1/2	10 1/2	10 1/2	96	4F	4F	111.6	660	
G10218L	G10418L	6 1/4	3T	5 1/2	3T	2 1/4	4 7/8	10 3/4	16	7 1/4	100 1/2	10 1/2	10 1/2	108	4F	4F	125.7	721	
G10220L	G10420L	6 1/4	3T	5 1/2	3T	2 1/4	4 7/8	10 3/4	16	7 1/4	112 1/2	10 1/2	10 1/2	120	4F	4F	139.9	782	

SADDLE DIMENSIONS: H-8³/₈; W-13⁵/₈; X-10; Hole Dia.-³/₄.

MATERIALS OF CONSTRUCTION (Unless otherwise indicated, standard will be furnished.)

	Standard	Optional
Shell	Steel	304ss, 316ss
Head	Cast Iron 4-10" Fabricated Steel 12-30"	* Cast Bronze, Fabricated Steel, Fabricated 304ss/316ss Fabricated 304ss/316ss
Tubes	3/4 x 20 BWG Copper	3/4 x 18 BWG Copper, Steel, 304ss, 316ss, 90/10 Cu Ni
Tube Sheet	Steel	Brass, 304ss, 316ss, 90/10 Cu Ni
Separators	Steel	Brass, 304ss, 316ss, 90/10 Cu Ni
Working Pressure	150 PSIG (ASME)	Consult Factory
Max. Temperature	375°F	Consult Factory

* When choosing any option with fabricated head type, refer to submittal 201-022 for head dimensions. Fabricated heads will feature flanged connections.

All dimensions shown are subject to change and should not be used for pre-piping. Contact your local Taco representative should certified dimensional drawings be required.



Taco, Inc., 1160 Cranston Street, Cranston, RI 02920 | Tel: (401) 942-8000 | FAX: (401) 942-2360
 Taco (Canada), Ltd., 8450 Lawson Road, Suite #3, Milton, Ontario L9T 0J8 | Tel: (905) 564-9422 | FAX: (905) 564-9436
 Visit our web site: www.TacoComfort.com | Printed in USA | ©2017 Taco, Inc.





Submittal Data Information

U Tube Heat Exchangers

201-011

12" DIAMETER LIQUID

SUPERSEDES: NEW

EFFECTIVE APRIL 15, 1995

Job: _____

Item No	Model No	Pass	GPM Tubes	Temp. In	Temp. Out	P.D. Tubes	Vel. Tubes	GPM Shell	Temp. In	Temp. Out	P.D. Shell	Vel. Shell

Tube Fluid _____ Shell Fluid _____

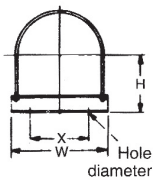

SADDLES
(Optional)

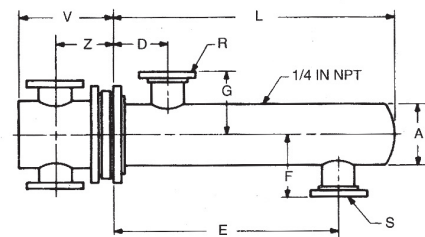
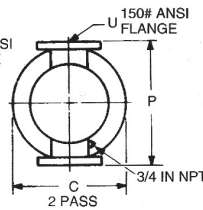
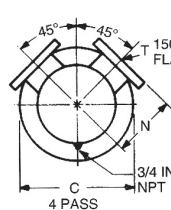

DIMENSIONS

12 Inch Diameter

Model Number		Fabricated Steel Heads								Dimensions (inches)										Heating Surface (sq. ft.)	Shipping Weight (lbs.)
2 Pass	4 Pass	2 Pass				4 Pass				2 and 4 Pass											
		P	U	V	Z	N	T	V	Z	A	C	D	E	F	G	L	R	S			
G12206L	G12406L	24	4F	14 ⁷ / ₈	10 ¹ / ₈	12	3F	14 ⁵ / ₈	10 ³ / ₈	12 ³ / ₄	19	8	27 ¹ / ₄	12	12	36 ¹ / ₄	5F	5F	58.6	510	
G12208L	G12408L	24	4F	14 ⁷ / ₈	10 ¹ / ₈	12	3F	14 ⁵ / ₈	10 ³ / ₈	12 ³ / ₄	19	8	39 ¹ / ₄	12	12	48 ¹ / ₄	5F	5F	79.0	596	
G12210L	G12410L	24	4F	14 ⁷ / ₈	10 ¹ / ₈	12	3F	14 ⁵ / ₈	10 ³ / ₈	12 ³ / ₄	19	8	51 ¹ / ₄	12	12	60 ¹ / ₄	5F	5F	99.5	681	
G12212L	G12412L	24	4F	14 ⁷ / ₈	10 ¹ / ₈	12	3F	14 ⁵ / ₈	10 ³ / ₈	12 ³ / ₄	19	8	63 ¹ / ₄	12	12	72 ¹ / ₄	5F	5F	119.9	772	
G12214L	G12414L	24	4F	14 ⁷ / ₈	10 ¹ / ₈	12	3F	14 ⁵ / ₈	10 ³ / ₈	12 ³ / ₄	19	8	75 ¹ / ₄	12	12	84 ¹ / ₄	5F	5F	140.3	857	
G12216L	G12416L	24	4F	14 ⁷ / ₈	10 ¹ / ₈	12	3F	14 ⁵ / ₈	10 ³ / ₈	12 ³ / ₄	19	8	87 ¹ / ₄	12	12	96 ¹ / ₄	5F	5F	160.8	941	
G12218L	G12418L	24	4F	14 ⁷ / ₈	10 ¹ / ₈	12	3F	14 ⁵ / ₈	10 ³ / ₈	12 ³ / ₄	19	8	99 ¹ / ₄	12	12	108 ¹ / ₄	5F	5F	181.2	1027	
G12220L	G12420L	24	4F	14 ⁷ / ₈	10 ¹ / ₈	12	3F	14 ⁵ / ₈	10 ³ / ₈	12 ³ / ₄	19	8	111 ¹ / ₄	12	12	120 ¹ / ₄	5F	5F	201.6	1111	

SADDLE DIMENSIONS: H-9³/₈; W-15⁵/₈; X-11; Hole Dia.-³/₄.

MATERIALS OF CONSTRUCTION (Unless otherwise indicated, standard will be furnished.)

	Standard	Optional
Shell	Steel	304ss, 316ss
Head	Cast Iron 4-10"	Fabricated Steel, Cast Bronze, Fabricated 304ss/316ss
	Fabricated Steel 12-30"	Cast Bronze, Fabricated 304ss/316ss
Tubes	3/4 x 20 BWG Copper	3/4 x 18 BWG Copper, Steel, 304ss, 316ss, 90/10 Cu Ni, Admiralty
Tube Sheet	Steel	Bronze, Brass, 304ss, 316ss, 90/10 Cu Ni
Separators	Steel	Bronze, Brass, 304ss, 316ss, 90/10 Cu Ni
Working Pressure	150 PSIG (ASME)	Consult Factory
Max. Temperature	375°F	Consult Factory

All dimensions shown are subject to change and should not be used for pre-piping. Contact your local Taco representative should certified dimensional drawings be required.

Do it Once. Do it Right.

Taco, Inc., 1160 Cranston Street, Cranston, RI 02920 Telephone: (401) 942-8000 Fax: (401) 942-2360
 Taco (Canada), Ltd., 6180 Ordan Drive, Mississauga, Ontario L5T 2B3 Telephone: (905) 564-9422 Fax: (905) 564-9436
 Visit our website at: www.taco-hvac.com

Printed in USA
 Copyright 2007
 TACO, Inc.



Submittal Data Information

U Tube Heat Exchangers

201-012

14" DIAMETER LIQUID

EFFECTIVE: APRIL 15, 1995

Job: _____

Item No	Model No	Pass	GPM Tubes	Temp. In	Temp. Out	P.D. Tubes	Vel. Tubes	GPM Shell	Temp. In	Temp. Out	P.D. Shell	Vel. Shell

Tube Fluid _____ Shell Fluid _____

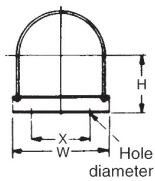

SADDLES (Optional)

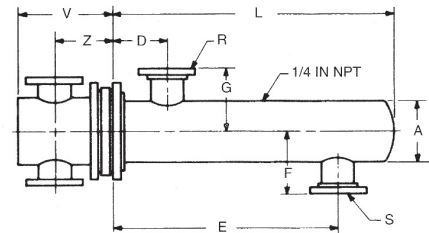
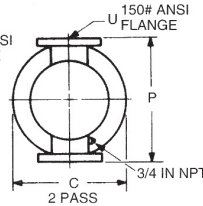
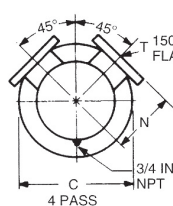

DIMENSIONS

14 Inch Diameter

Model Number		Fabricated Steel Heads								Dimensions (inches)										Heating Surface (sq. ft.)	Shipping Weight (lbs.)
2 Pass	4 Pass	2 Pass				4 Pass				2 and 4 Pass											
		P	U	V	Z	N	T	V	Z	A	C	D	E	F	G	L	R	S			
G14206L	G14406L	26	6F	18 ³ / ₈	12 ³ / ₈	13	4F	16 ⁵ / ₈	11 ⁵ / ₈	14	21	8 ¹ / ₂	27 ¹ / ₂	13 ¹ / ₄	13 ¹ / ₄	37 ¹ / ₄	6F	6F	75.7	568	
G14208L	G14408L	26	6F	18 ³ / ₈	12 ³ / ₈	13	4F	16 ⁵ / ₈	11 ⁵ / ₈	14	21	8 ¹ / ₂	39 ¹ / ₂	13 ¹ / ₄	13 ¹ / ₄	49 ¹ / ₄	6F	6F	102.4	664	
G14210L	G14410L	26	6F	18 ³ / ₈	12 ³ / ₈	13	4F	16 ⁵ / ₈	11 ⁵ / ₈	14	21	8 ¹ / ₂	51 ¹ / ₂	13 ¹ / ₄	13 ¹ / ₄	61 ¹ / ₄	6F	6F	129.1	756	
G14212L	G14412L	26	6F	18 ³ / ₈	12 ³ / ₈	13	4F	16 ⁵ / ₈	11 ⁵ / ₈	14	21	8 ¹ / ₂	63 ¹ / ₂	13 ¹ / ₄	13 ¹ / ₄	73 ¹ / ₄	6F	6F	155.8	847	
G14214L	G14414L	26	6F	18 ³ / ₈	12 ³ / ₈	13	4F	16 ⁵ / ₈	11 ⁵ / ₈	14	21	8 ¹ / ₂	75 ¹ / ₂	13 ¹ / ₄	13 ¹ / ₄	85 ¹ / ₄	6F	6F	182.5	937	
G14216L	G14416L	26	6F	18 ³ / ₈	12 ³ / ₈	13	4F	16 ⁵ / ₈	11 ⁵ / ₈	14	21	8 ¹ / ₂	87 ¹ / ₂	13 ¹ / ₄	13 ¹ / ₄	97 ¹ / ₄	6F	6F	209.2	1029	
G14218L	G14418L	26	6F	18 ³ / ₈	12 ³ / ₈	13	4F	16 ⁵ / ₈	11 ⁵ / ₈	14	21	8 ¹ / ₂	99 ¹ / ₂	13 ¹ / ₄	13 ¹ / ₄	109 ¹ / ₄	6F	6F	236.0	1120	
G14220L	G14420L	26	6F	18 ³ / ₈	12 ³ / ₈	13	4F	16 ⁵ / ₈	11 ⁵ / ₈	14	21	8 ¹ / ₂	111 ¹ / ₂	13 ¹ / ₄	13 ¹ / ₄	121 ¹ / ₄	6F	6F	262.7	1212	

SADDLE DIMENSIONS: H-10; W-17; X-12; Hole Dia. -³/₄.

MATERIALS OF CONSTRUCTION (Unless otherwise indicated, standard will be furnished.)

	Standard	Optional
Shell	Steel	304ss, 316ss
Head	Cast Iron 4-10"	Fabricated Steel, Cast Bronze, Fabricated 304ss/316ss
	Fabricated Steel 12-30"	Cast Bronze, Fabricated 304ss/316ss
Tubes	3/4 x 20 BWG Copper	3/4 x 18 BWG Copper, Steel, 304ss, 316ss, 90/10 Cu Ni, Admiralty
Tube Sheet	Steel	Bronze, Brass, 304ss, 316ss, 90/10 Cu Ni
Separators	Steel	Bronze, Brass, 304ss, 316ss, 90/10 Cu Ni
Working Pressure	150 PSIG (ASME)	Consult Factory
Max. Temperature	375°F	Consult Factory

Do it Once. Do it Right.

Taco, Inc., 1160 Cranston Street, Cranston, RI 02920 Telephone: (401) 942-8000 Fax: (401) 942-2360
 Taco (Canada), Ltd., 6180 Ordan Drive, Mississauga, Ontario L5T 2B3 Telephone: (905) 564-9422 Fax: (905) 564-9436

Printed in USA
 Copyright 2004
 TACO, Inc.

Visit our website at: www.taco-hvac.com



Submittal Data Information

U Tube Heat Exchangers

201-013

16" DIAMETER LIQUID

EFFECTIVE: APRIL 15, 1995

Job: _____

Item No	Model No	Pass	GPM Tubes	Temp. In	Temp. Out	P.D. Tubes	Vel. Tubes	GPM Shell	Temp. In	Temp. Out	P.D. Shell	Vel. Shell

Tube Fluid _____

Shell Fluid _____

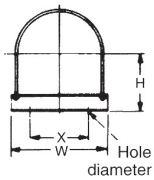

SADDLES
(Optional)

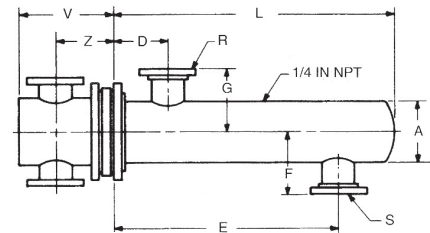
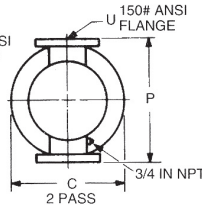
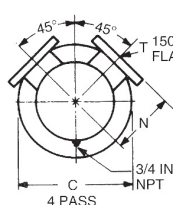

DIMENSIONS

16 Inch Diameter

Model Number		Fabricated Steel Heads								Dimensions (inches)								Heating Surface (sq. ft.)	Shipping Weight (lbs.)	
2 Pass	4 Pass	2 Pass				4 Pass				2 and 4 Pass										
		P	U	V	Z	N	T	V	Z	A	C	D	E	F	G	L	R			S
G16206L	G16406L	28 1/2	6F	19 5/8	13 3/8	14 1/4	4F	17 3/8	12 1/8	16	23 1/2	9 3/4	25 1/2	14 1/2	14 1/2	37	8F	8F	104.5	745
G16208L	G16408L	28 1/2	6F	19 5/8	13 3/8	14 1/4	4F	17 3/8	12 1/8	16	23 1/2	9 3/4	37 1/2	14 1/2	14 1/2	49	8F	8F	141.4	863
G16210L	G16410L	28 1/2	6F	19 5/8	13 3/8	14 1/4	4F	17 3/8	12 1/8	16	23 1/2	9 3/4	49 1/2	14 1/2	14 1/2	61	8F	8F	178.4	981
G16212L	G16412L	28 1/2	6F	19 5/8	13 3/8	14 1/4	4F	17 3/8	12 1/8	16	23 1/2	9 3/4	61 1/2	14 1/2	14 1/2	73	8F	8F	215.3	1105
G16214L	G16414L	28 1/2	6F	19 5/8	13 3/8	14 1/4	4F	17 3/8	12 1/8	16	23 1/2	9 3/4	73 1/2	14 1/2	14 1/2	85	8F	8F	252.2	1187
G16216L	G16416L	28 1/2	6F	19 5/8	13 3/8	14 1/4	4F	17 3/8	12 1/8	16	23 1/2	9 3/4	85 1/2	14 1/2	14 1/2	97	8F	8F	289.1	1305
G16218L	G16418L	28 1/2	6F	19 5/8	13 3/8	14 1/4	4F	17 3/8	12 1/8	16	23 1/2	9 3/4	97 1/2	14 1/2	14 1/2	109	8F	8F	326.0	1424
G16220L	G16420L	28 1/2	6F	19 5/8	13 3/8	14 1/4	4F	17 3/8	12 1/8	16	23 1/2	9 3/4	109 1/2	14 1/2	14 1/2	121	8F	8F	363.0	1541

SADDLE DIMENSIONS: H-12; W-19; X-13; Hole Dia.-3/4.

MATERIALS OF CONSTRUCTION (Unless otherwise indicated, standard will be furnished.)

	Standard	Optional
Shell	Steel	304ss, 316ss
Head	Cast Iron 4-10" Fabricated Steel 12-30"	Fabricated Steel, Cast Bronze, Fabricated 304ss/316ss Cast Bronze, Fabricated 304ss/316ss
Tubes	3/4 x 20 BWG Copper	3/4 x 18 BWG Copper, Steel, 304ss, 316ss, 90/10 Cu Ni, Admiralty
Tube Sheet	Steel	Bronze, Brass, 304ss, 316ss, 90/10 Cu Ni
Separators	Steel	Bronze, Brass, 304ss, 316ss, 90/10 Cu Ni
Working Pressure	150 PSIG (ASME)	Consult Factory
Max. Temperature	375°F	Consult Factory

All dimensions shown are subject to change and should not be used for pre-piping. Contact your local Taco representative should certified dimensional drawings be required.

Do it Once. Do it Right.

Taco, Inc., 1160 Cranston Street, Cranston, RI 02920 Telephone: (401) 942-8000 Fax: (401) 942-2360
 Taco (Canada), Ltd., 6180 Ordan Drive, Mississauga, Ontario L5T 2B3 Telephone: (905) 564-9422 Fax: (905) 564-9436
 Visit our website at: www.taco-hvac.com

Printed in USA
 Copyright 2007
 TACO, Inc.



Submittal Data Information

U Tube Heat Exchangers

201-014

18" DIAMETER LIQUID

SUPERSEDES: NEW

EFFECTIVE OCTOBER 1, 1994

Job: _____

Item No	Model No	Pass	GPM Tubes	Temp. In	Temp. Out	P.D. Tubes	Vel. Tubes	GPM Shell	Temp. In	Temp. Out	P.D. Shell	Vel. Shell

Tube Fluid _____

Shell Fluid _____

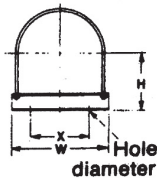

SADDLES
(Optional)

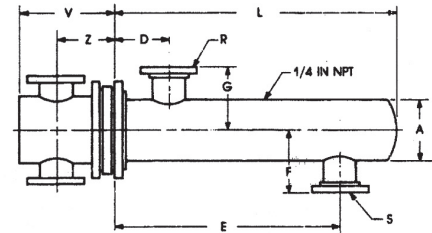
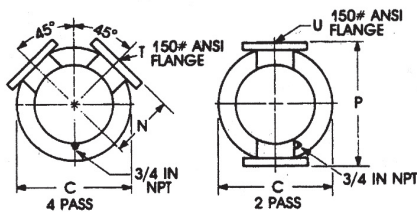

DIMENSIONS
18 Inch Diameter



Model Number		Fabricated Steel Heads								Dimension (inches)								Heating Surface (sq. ft.)	Shipping Weight (lbs.)	
2 Pass	4 Pass	2 Pass				4 Pass				2 and 4 Pass										
		P	U	V	Z	N	T	V	Z	A	C	D	E	F	G	L	R	S		
G18206L	G18406L	30	6F	20 1/4	14	15	4F	18	12 3/4	18	25	10	24 1/2	15 1/4	15 1/4	36 1/2	8F	8F	130.7	902
G18208L	G18408L	30	6F	20 1/4	14	15	4F	18	12 3/4	18	25	10	36 1/2	15 1/4	15 1/4	48 1/2	8F	8F	177.0	1044
G18210L	G18410L	30	6F	20 1/4	14	15	4F	18	12 3/4	18	25	10	48 1/2	15 1/4	15 1/4	60 1/2	8F	8F	223.4	1183
G18212L	G18412L	30	6F	20 1/4	14	15	4F	18	12 3/4	18	25	10	60 1/2	15 1/4	15 1/4	72 1/2	8F	8F	269.7	1326
G18214L	G18414L	30	6F	20 1/4	14	15	4F	18	12 3/4	18	25	10	72 1/2	15 1/4	15 1/4	84 1/2	8F	8F	316.1	1445
G18216L	G18416L	30	6F	20 1/4	14	15	4F	18	12 3/4	18	25	10	84 1/2	15 1/4	15 1/4	96 1/2	8F	8F	362.4	1586
G18218L	G18418L	30	6F	20 1/4	14	15	4F	18	12 3/4	18	25	10	96 1/2	15 1/4	15 1/4	108 1/2	8F	8F	408.8	1732
G18220L	G18420L	30	6F	20 1/4	14	15	4F	18	12 3/4	18	25	10	108 1/2	15 1/4	15 1/4	120 1/2	8F	8F	455.1	1871

SADDLE DIMENSIONS: H-13; W-21; X-14; Hole Dia. - 3/4.

MATERIALS OF CONSTRUCTION (Unless otherwise indicated, standard will be furnished.)

Shell	Standard Steel	Optional 304ss, 316ss
Head	Cast Iron 4-10" Fabricated Steel 12-30"	Fabricated Steel, Cast Bronze, Fabricated 304ss/316ss Cast Bronze, Fabricated 304ss/316ss
Tubes	3/4 x 20 BWG Copper	3/4 x 18 BWG Copper, Steel, 304ss, 316ss, 90/10 Cu Ni, Admiralty
Tube Sheet	Steel	Bronze, Brass, 304ss, 316ss, 90/10 Cu Ni
Separators	Steel	Bronze, Brass, 304ss, 316ss, 90/10 Cu Ni
Working Pressure	150 PSIG (ASME)	Consult Factory
Max. Temperature	375°F	Consult Factory

All dimensions shown are subject to change and should not be used for pre-piping. Contact your local Taco representative should certified dimensional drawings be required.

Do it Once. Do it Right.

Taco, Inc., 1160 Cranston Street, Cranston, RI 02920 Telephone: (401) 942-8000 Fax: (401) 942-2360
 Taco (Canada), Ltd., 6180 Ordan Drive, Mississauga, Ontario L5T 2B3 Telephone: (905) 564-9422 Fax: (905) 564-9436
 Visit our website at: www.taco-hvac.com

Printed in USA
 Copyright 2007
 TACO, Inc.



Submittal Data Information

U Tube Heat Exchangers

201-015

20" DIAMETER LIQUID

EFFECTIVE: APRIL 15, 1995

Job: _____

Item No	Model No	Pass	GPM Tubes	Temp. In	Temp. Out	P.D. Tubes	Vel. Tubes	GPM Shell	Temp. In	Temp. Out	P.D. Shell	Vel. Shell

Tube Fluid _____

Shell Fluid _____

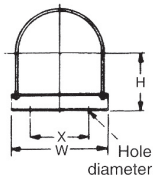

SADDLES
(Optional)

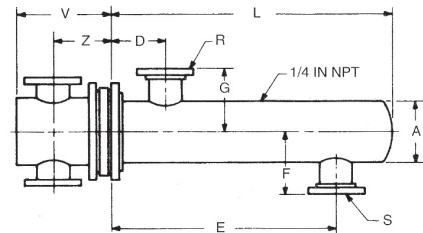
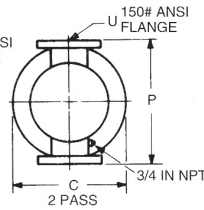
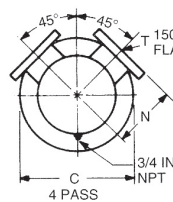
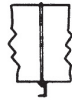

DIMENSIONS

20 Inch Diameter

Model Number		Fabricated Steel Heads								Dimensions (inches)								Heating Surface (sq. ft.)	Shipping Weight (lbs.)	
2 Pass 4 Pass		2 Pass				4 Pass				2 and 4 Pass										
P	U	V	Z	N	T	V	Z	A	C	D	E	F	G	L	R	S				
G20208L	G20408L	32 ¹ / ₂	6F	21 ⁵ / ₈	15 ¹ / ₈	16 ¹ / ₄	4F	19 ⁵ / ₈	14 ¹ / ₈	20	27 ¹ / ₂	11 ¹ / ₄	35	16 ¹ / ₂	16 ¹ / ₂	48 ³ / ₄	10F	10F	223.6	1226
G20210L	G20410L	32 ¹ / ₂	6F	21 ⁵ / ₈	15 ¹ / ₈	16 ¹ / ₄	4F	19 ⁵ / ₈	14 ¹ / ₈	20	27 ¹ / ₂	11 ¹ / ₄	47	16 ¹ / ₂	16 ¹ / ₂	60 ³ / ₄	10F	10F	283.3	1386
G20212L	G20412L	32 ¹ / ₂	6F	21 ⁵ / ₈	15 ¹ / ₈	16 ¹ / ₄	4F	19 ⁵ / ₈	14 ¹ / ₈	20	27 ¹ / ₂	11 ¹ / ₄	59	16 ¹ / ₂	16 ¹ / ₂	72 ³ / ₄	10F	10F	343.0	1547
G20214L	G20414L	32 ¹ / ₂	6F	21 ⁵ / ₈	15 ¹ / ₈	16 ¹ / ₄	4F	19 ⁵ / ₈	14 ¹ / ₈	20	27 ¹ / ₂	11 ¹ / ₄	71	16 ¹ / ₂	16 ¹ / ₂	84 ³ / ₄	10F	10F	402.7	1706
G20216L	G20416L	32 ¹ / ₂	6F	21 ⁵ / ₈	15 ¹ / ₈	16 ¹ / ₄	4F	19 ⁵ / ₈	14 ¹ / ₈	20	27 ¹ / ₂	11 ¹ / ₄	83	16 ¹ / ₂	16 ¹ / ₂	96 ³ / ₄	10F	10F	462.4	1867
G20218L	G20418L	32 ¹ / ₂	6F	21 ⁵ / ₈	15 ¹ / ₈	16 ¹ / ₄	4F	19 ⁵ / ₈	14 ¹ / ₈	20	27 ¹ / ₂	11 ¹ / ₄	95	16 ¹ / ₂	16 ¹ / ₂	108 ³ / ₄	10F	10F	522.2	2041
G20220L	G20420L	32 ¹ / ₂	6F	21 ⁵ / ₈	15 ¹ / ₈	16 ¹ / ₄	4F	19 ⁵ / ₈	14 ¹ / ₈	20	27 ¹ / ₂	11 ¹ / ₄	107	16 ¹ / ₂	16 ¹ / ₂	120 ³ / ₄	10F	10F	581.9	2202

SADDLE DIMENSIONS: H-14; W-23; X-14; Hole Dia.-3/4.

MATERIALS OF CONSTRUCTION (Unless otherwise indicated, standard will be furnished.)

	Standard	Optional
Shell	Steel	304ss, 316ss
Head	Cast Iron 4-10"	Fabricated Steel, Cast Bronze, Fabricated 304ss/316ss
	Fabricated Steel 12-30"	Cast Bronze, Fabricated 304ss/316ss
Tubes	3/4 x 20 BWG Copper	3/4 x 18 BWG Copper, Steel, 304ss, 316ss, 90/10 Cu Ni, Admiralty
Tube Sheet	Steel	Bronze, Brass, 304ss, 316ss, 90/10 Cu Ni
Separators	Steel	Bronze, Brass, 304ss, 316ss, 90/10 Cu Ni
Working Pressure	150 PSIG (ASME)	Consult Factory
Max. Temperature	375°F	Consult Factory

All dimensions shown are subject to change and should not be used for pre-piping. Contact your local Taco representative should certified dimensional drawings be required.

Do it Once. Do it Right.

Taco, Inc., 1160 Cranston Street, Cranston, RI 02920 Telephone: (401) 942-8000 Fax: (401) 942-2360
 Taco (Canada), Ltd., 6180 Ordan Drive, Mississauga, Ontario L5T 2B3 Telephone: (905) 564-9422 Fax: (905) 564-9436
 Visit our website at: www.taco-hvac.com

Printed in USA
 Copyright 2007
 TACO, Inc.



Submittal Data Information

U Tube Heat Exchangers

201-016

EFFECTIVE: JULY 25, 2018

SUPERSEDES: APRIL 15, 1995

22" DIAMETER LIQUID

Job: _____

Item No	Model No	Pass	GPM Tubes	Temp. In	Temp. Out	P.D. Tubes	Vel. Tubes	GPM Shell	Temp. In	Temp. Out	P.D. Shell	Vel. Shell

Tube Fluid _____ Shell Fluid _____

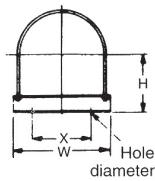

SADDLES
(Optional)

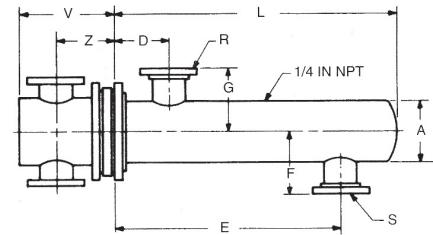
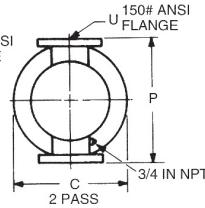
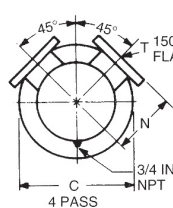

Model Number		Fabricated Steel Heads								Dimensions (inches)								Heating Surface (sq. ft.)	Shipping Weight (lbs.)	
2 Pass	4 Pass	2 Pass				4 Pass				2 and 4 Pass										
		P	U	V	Z	N	T	V	Z	A	C	D	E	F	G	L	R	S		
G22208L	G22408L	35	10F	26 1/2	17 3/4	17 1/4	8F	25 5/8	17	22	29 1/2	11 1/2	34 3/8	17 1/2	17 1/2	48 1/2	10F	10F	241.6	1396
G22210L	G22410L	35	10F	26 1/2	17 3/4	17 1/4	8F	25 5/8	17	22	29 1/2	11 1/2	46 3/8	17 1/2	17 1/2	60 1/2	10F	10F	313.0	1580
G22212L	G22412L	35	10F	26 1/2	17 3/4	17 1/4	8F	25 5/8	17	22	29 1/2	11 1/2	58 3/8	17 1/2	17 1/2	72 1/2	10F	10F	384.5	1764
G22214L	G22414L	35	10F	26 1/2	17 3/4	17 1/4	8F	25 5/8	17	22	29 1/2	11 1/2	70 3/8	17 1/2	17 1/2	84 1/2	10F	10F	455.9	1918
G22216L	G22416L	35	10F	26 1/2	17 3/4	17 1/4	8F	25 5/8	17	22	29 1/2	11 1/2	82 3/8	17 1/2	17 1/2	96 1/2	10F	10F	527.3	2132
G22218L	G22418L	35	10F	26 1/2	17 3/4	17 1/4	8F	25 5/8	17	22	29 1/2	11 1/2	94 3/8	17 1/2	17 1/2	108 1/2	10F	10F	598.8	2316
G22220L	G22420L	35	10F	26 1/2	17 3/4	17 1/4	8F	25 5/8	17	22	29 1/2	11 1/2	106 3/8	17 1/2	17 1/2	120 1/2	10F	10F	670.2	2500

MATERIALS OF CONSTRUCTION (Unless otherwise indicated, standard will be furnished.)

	Standard	Optional
Shell	Steel	304ss, 316ss
Head	Cast Iron 4-10"	Fabricated Steel, Cast Bronze, Fabricated 304ss/316ss
Tubes	Fabricated Steel 12-30"	Cast Bronze, Fabricated 304ss/316ss
Tube Sheet	3/4 x 20 BWG Copper	3/4 x 18 BWG Copper, Steel, 304ss, 316ss, 90/10 Cu Ni, Admiralty
Separators	Steel	Bronze, Brass, 304ss, 316ss, 90/10 Cu Ni
Working Pressure	Steel	Bronze, Brass, 304ss, 316ss, 90/10 Cu Ni
Max. Temperature	150 PSIG (ASME)	Consult Factory
	375°F	Consult Factory

All dimensions shown are subject to change and should not be used for pre-piping. Contact your local Taco representative should certified dimensional drawings be required.



Taco, Inc., 1160 Cranston Street, Cranston, RI 02920 | Tel: (401) 942-8000 | FAX: (401) 942-2360

Taco (Canada), Ltd., 8450 Lawson Road, Suite #3, Milton, Ontario L9T 0J8 | Tel: (905) 564-9422 | FAX: (905) 564-9436

Visit our web site: www.TacoComfort.com | Printed in USA | ©2017 Taco, Inc.





Submittal Data Information

U Tube Heat Exchangers

201-017

24" DIAMETER LIQUID

EFFECTIVE: APRIL 15, 1995

Job: _____

Item No	Model No	Pass	GPM Tubes	Temp. In	Temp. Out	P.D. Tubes	Vel. Tubes	GPM Shell	Temp. In	Temp. Out	P.D. Shell	Vel. Shell

Tube Fluid _____

Shell Fluid _____

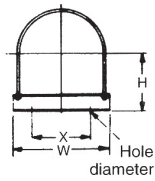

SADDLES
(Optional)

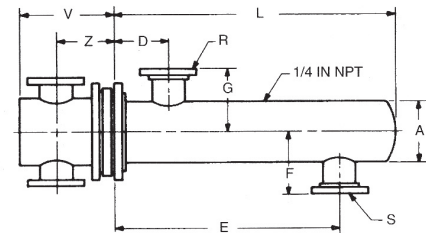
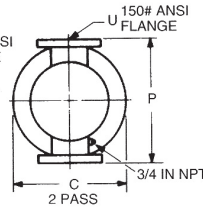
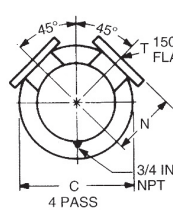

DIMENSIONS

24 Inch Diameter

Model Number		Fabricated Steel Heads							Dimensions (inches)										Heating Surface (sq. ft.)	Shipping Weight (lbs.)
2 Pass	4 Pass	2 Pass				4 Pass			2 and 4 Pass											
		P	U	V	Z	N	T	V	Z	A	C	D	E	F	G	L	R	S		
G24208L	G24408L	37 1/2	10F	27 5/8	18 7/8	18 1/2	8F	25 5/8	17 7/8	24	32	11 1/2	36	18 3/4	18 3/4	50	10F	10F	324.0	1710
G24210L	G24410L	37 1/2	10F	27 5/8	18 7/8	18 1/2	8F	25 5/8	17 7/8	24	32	11 1/2	48	18 3/4	18 3/4	62	10F	10F	412.0	1928
G24212L	G24412L	37 1/2	10F	27 5/8	18 7/8	18 1/2	8F	25 5/8	17 7/8	24	32	11 1/2	60	18 3/4	18 3/4	74	10F	10F	500.0	2146
G24214L	G24414L	37 1/2	10F	27 5/8	18 7/8	18 1/2	8F	25 5/8	17 7/8	24	32	11 1/2	72	18 3/4	18 3/4	86	10F	10F	588.0	2364
G24216L	G24416L	37 1/2	10F	27 5/8	18 7/8	18 1/2	8F	25 5/8	17 7/8	24	32	11 1/2	84	18 3/4	18 3/4	98	10F	10F	676.0	2582
G24218L	G24418L	37 1/2	10F	27 5/8	18 7/8	18 1/2	8F	25 5/8	17 7/8	24	32	11 1/2	96	18 3/4	18 3/4	110	10F	10F	764.0	2800
G24220L	G24420L	37 1/2	10F	27 5/8	18 7/8	18 1/2	8F	25 5/8	17 7/8	24	32	11 1/2	108	18 3/4	18 3/4	122	10F	10F	852.0	3018

SADDLE DIMENSIONS: H-18; W-27; X-19; Hole Dia.-7/8.

MATERIALS OF CONSTRUCTION (Unless otherwise indicated, standard will be furnished.)

	Standard	Optional
Shell	Steel	304ss, 316ss
Head	Cast Iron 4-10" Fabricated Steel 12-30"	Fabricated Steel, Cast Bronze, Fabricated 304ss/316ss Cast Bronze, Fabricated 304ss/316ss
Tubes	3/4 x 20 BWG Copper	3/4 x 18 BWG Copper, Steel, 304ss, 316ss, 90/10 Cu Ni, Admiralty
Tube Sheet	Steel	Bronze, Brass, 304ss, 316ss, 90/10 Cu Ni
Separators	Steel	Bronze, Brass, 304ss, 316ss, 90/10 Cu Ni
Working Pressure	150 PSIG (ASME)	Consult Factory
Max. Temperature	375°F	Consult Factory

All dimensions shown are subject to change and should not be used for pre-piping. Contact your local Taco representative should certified dimensional drawings be required.

Do it Once. Do it Right.

Taco, Inc., 1160 Cranston Street, Cranston, RI 02920 Telephone: (401) 942-8000 Fax: (401) 942-2360
 Taco (Canada), Ltd., 6180 Ordan Drive, Mississauga, Ontario L5T 2B3 Telephone: (905) 564-9422 Fax: (905) 564-9436
 Visit our website at: www.taco-hvac.com

Printed in USA
 Copyright 2007
 TACO, Inc.



Submittal Data Information

U Tube Heat Exchangers

201-018

26" DIAMETER LIQUID

SUPERSEDES: NEW

EFFECTIVE APRIL 15, 1995

Job: _____

Item No	Model No	Pass	GPM Tubes	Temp. In	Temp. Out	P.D. Tubes	Vel. Tubes	GPM Shell	Temp. In	Temp. Out	P.D. Shell	Vel. Shell

Tube Fluid _____ Shell Fluid _____

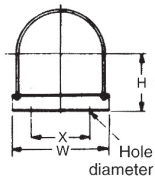

SADDLES
(Optional)

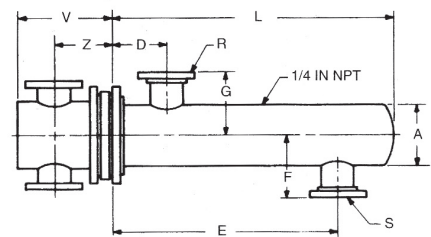
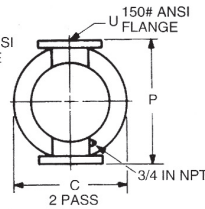
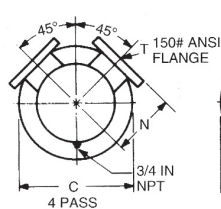

DIMENSIONS

26 Inch Diameter

Model Number		Fabricated Steel Heads								Dimensions (inches)								Heating Surface (sq. ft.)	Shipping Weight (lbs.)	
2 Pass	4 Pass	2 Pass				4 Pass				2 and 4 Pass										
		P	U	V	Z	N	T	V	Z	A	C	D	E	F	G	L	R	S		
G26208L	G26408L	37	12F	28 ³ / ₄	19	18 ¹ / ₄	8F	24 ³ / ₄	17	26	34 ¹ / ₄	11	35 ³ / ₄	18 ¹ / ₂	18 ¹ / ₂	48	10F	10F	393.4	2036
G26210L	G26410L	37	12F	28 ³ / ₄	19	18 ¹ / ₄	8F	24 ³ / ₄	17	26	34 ¹ / ₄	11	47 ³ / ₄	18 ¹ / ₂	18 ¹ / ₂	60	10F	10F	500.2	2280
G26212L	G26412L	37	12F	28 ³ / ₄	19	18 ¹ / ₄	8F	24 ³ / ₄	17	26	34 ¹ / ₄	11	59 ³ / ₄	18 ¹ / ₂	18 ¹ / ₂	72	10F	10F	607.0	2524
G26214L	G26414L	37	12F	28 ³ / ₄	19	18 ¹ / ₄	8F	24 ³ / ₄	17	26	34 ¹ / ₄	11	71 ³ / ₄	18 ¹ / ₂	18 ¹ / ₂	84	10F	10F	713.8	2768
G26216L	G26416L	37	12F	28 ³ / ₄	19	18 ¹ / ₄	8F	24 ³ / ₄	17	26	34 ¹ / ₄	11	83 ³ / ₄	18 ¹ / ₂	18 ¹ / ₂	96	10F	10F	820.6	3012
G26218L	G26418L	37	12F	28 ³ / ₄	19	18 ¹ / ₄	8F	24 ³ / ₄	17	26	34 ¹ / ₄	11	95 ³ / ₄	18 ¹ / ₂	18 ¹ / ₂	108	10F	10F	927.4	3256
G26220L	G26420L	37	12F	28 ³ / ₄	19	18 ¹ / ₄	8F	24 ³ / ₄	17	26	34 ¹ / ₄	11	107 ³ / ₄	18 ¹ / ₂	18 ¹ / ₂	120	10F	10F	1034.0	3500

SADDLE DIMENSIONS: H-19; W-30; X-20; Hole Dia.-7/8.

MATERIALS OF CONSTRUCTION (Unless otherwise indicated, standard will be furnished.)

	Standard	Optional
Shell	Steel	304ss, 316ss
Head	Cast Iron 4-10"	Fabricated Steel, Cast Bronze, Fabricated 304ss/316ss
	Fabricated Steel 12-30"	Cast Bronze, Fabricated 304ss/316ss
Tubes	3/4 x 20 BWG Copper	3/4 x 18 BWG Copper, Steel, 304ss, 316ss, 90/10 Cu Ni, Admiralty
Tube Sheet	Steel	Bronze, Brass, 304ss, 316ss, 90/10 Cu Ni
Separators	Steel	Bronze, Brass, 304ss, 316ss, 90/10 Cu Ni
Working Pressure	150 PSIG (ASME)	Consult Factory
Max. Temperature	375°F	Consult Factory

All dimensions shown are subject to change and should not be used for pre-piping. Contact your local Taco representative should certified dimensional drawings be required.

Do it Once. Do it Right.

Taco, Inc., 1160 Cranston Street, Cranston, RI 02920 Telephone: (401) 942-8000 Fax: (401) 942-2360
 Taco (Canada), Ltd., 6180 Ordan Drive, Mississauga, Ontario L5T 2B3 Telephone: (905) 564-9422 Fax: (905) 564-9436
 Visit our website at: www.taco-hvac.com

Printed in USA
 Copyright 2007
 TACO, Inc.



Submittal Data Information

U Tube Heat Exchangers

201-008

6" DIAMETER LIQUID

EFFECTIVE: APRIL 30, 2018

SUPERSEDES: APRIL 15, 1995

Job: _____

Item No	Model No	Pass	GPM Tubes	Temp. In	Temp. Out	P.D. Tubes	Vel. Tubes	GPM Shell	Temp. In	Temp. Out	P.D. Shell	Vel. Shell

Tube Fluid _____

Shell Fluid _____

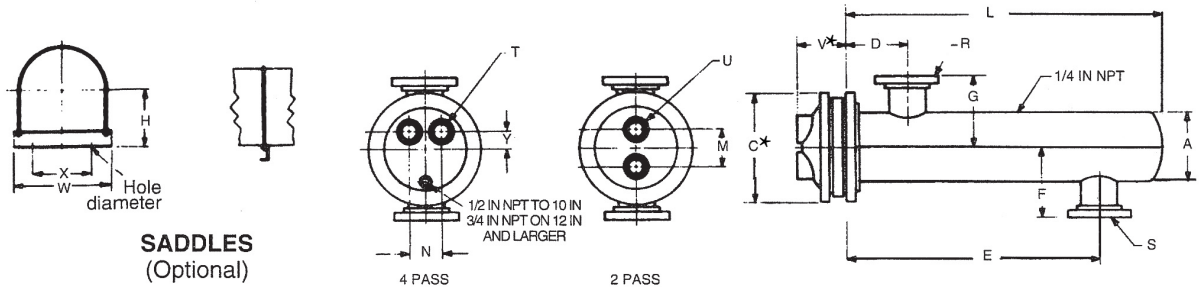

DIMENSIONS

6 Inch Diameter

Model Number		Cast Iron Heads						Dimensions (inches)										Heating Surface (sq. ft.)	Shipping Weight (lbs.)
2 Pass	4 Pass	2 Pass		4 Pass				2 and 4 Pass											
		M	U	N	T	Y	V*	A	C*	D	E	F	G	L	R	S			
G6204L	G6404L	4	2T	3 ³ / ₄	1 ¹ / ₂ T	1 ¹ / ₄	3 ⁷ / ₁₆	6 ⁵ / ₈	11	5	18	5 ⁷ / ₈	5 ⁷ / ₈	25	2 ¹ / ₂ T	2 ¹ / ₂ T	9.1	120	
G6206L	G6406L	4	2T	3 ³ / ₄	1 ¹ / ₂ T	1 ¹ / ₄	3 ⁷ / ₁₆	6 ⁵ / ₈	11	5	30	5 ⁷ / ₈	5 ⁷ / ₈	37	2 ¹ / ₂ T	2 ¹ / ₂ T	13.8	148	
G6208L	G6408L	4	2T	3 ³ / ₄	1 ¹ / ₂ T	1 ¹ / ₄	3 ⁷ / ₁₆	6 ⁵ / ₈	11	5	42	5 ⁷ / ₈	5 ⁷ / ₈	49	2 ¹ / ₂ T	2 ¹ / ₂ T	18.5	182	
G6210L	G6410L	4	2T	3 ³ / ₄	1 ¹ / ₂ T	1 ¹ / ₄	3 ⁷ / ₁₆	6 ⁵ / ₈	11	5	54	5 ⁷ / ₈	5 ⁷ / ₈	61	2 ¹ / ₂ T	2 ¹ / ₂ T	23.2	207	
G6212L	G6412L	4	2T	3 ³ / ₄	1 ¹ / ₂ T	1 ¹ / ₄	3 ⁷ / ₁₆	6 ⁵ / ₈	11	5	66	5 ⁷ / ₈	5 ⁷ / ₈	73	2 ¹ / ₂ T	2 ¹ / ₂ T	27.9	235	
G6214L	G6414L	4	2T	3 ³ / ₄	1 ¹ / ₂ T	1 ¹ / ₄	3 ⁷ / ₁₆	6 ⁵ / ₈	11	5	78	5 ⁷ / ₈	5 ⁷ / ₈	85	2 ¹ / ₂ T	2 ¹ / ₂ T	32.6	262	
G6216L	G6416L	4	2T	3 ³ / ₄	1 ¹ / ₂ T	1 ¹ / ₄	3 ⁷ / ₁₆	6 ⁵ / ₈	11	5	90	5 ⁷ / ₈	5 ⁷ / ₈	97	2 ¹ / ₂ T	2 ¹ / ₂ T	37.3	290	
G6218L	G6418L	4	2T	3 ³ / ₄	1 ¹ / ₂ T	1 ¹ / ₄	3 ⁷ / ₁₆	6 ⁵ / ₈	11	5	102	5 ⁷ / ₈	5 ⁷ / ₈	109	2 ¹ / ₂ T	2 ¹ / ₂ T	42.1	318	
G6220L	G6420L	4	2T	3 ³ / ₄	1 ¹ / ₂ T	1 ¹ / ₄	3 ⁷ / ₁₆	6 ⁵ / ₈	11	5	114	5 ⁷ / ₈	5 ⁷ / ₈	121	2 ¹ / ₂ T	2 ¹ / ₂ T	46.8	346	

SADDLE DIMENSIONS: H-6⁵/₁₆; W-9¹/₄; X-7¹/₂; Hole Dia. -⁵/₈

MATERIALS OF CONSTRUCTION (Unless otherwise indicated, standard will be furnished.)

Standard
 Shell Steel
 Head Cast Iron 4-10"
 Fabricated Steel 12-30"
 Tubes 3/4 x 20 BWG Copper
 Tube Sheet Steel
 Separators Steel
 Working Pressure 150 PSIG (ASME)
 Max. Temperature 375°F

Optional
 304ss, 316ss
 * Cast Bronze, Fabricated Steel, Fabricated 304ss/316ss
 Fabricated 304ss/316ss
 3/4 x 18 BWG Copper, Steel, 304ss, 316ss, 90/10 Cu Ni
 Brass, 304ss, 316ss, 90/10 Cu Ni
 Brass, 304ss, 316ss, 90/10 Cu Ni
 Consult Factory
 Consult Factory

* When choosing any option with fabricated head type, refer to submittal 201-022 for head dimensions. Fabricated heads will feature flanged connections.

All dimensions shown are subject to change and should not be used for pre-piping. Contact your local Taco representative should certified dimensional drawings be required.



Taco, Inc., 1160 Cranston Street, Cranston, RI 02920 | Tel: (401) 942-8000 | FAX: (401) 942-2360
 Taco (Canada), Ltd., 8450 Lawson Road, Suite #3, Milton, Ontario L9T 0J8 | Tel: (905) 564-9422 | FAX: (905) 564-9436
 Visit our web site: www.TacoComfort.com | Printed in USA | ©2017 Taco, Inc.



Submittal Data Information

U Tube Heat Exchangers

201-007

4" DIAMETER LIQUID

EFFECTIVE: APRIL 30, 2018

SUPERSEDES: APRIL 15, 1995

Job: _____

Item No	Model No	Pass	GPM Tubes	Temp. In	Temp. Out	P.D. Tubes	Vel. Tubes	GPM Shell	Temp. In	Temp. Out	P.D. Shell	Vel. Shell

Tube Fluid _____

Shell Fluid _____

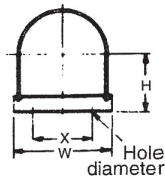

SADDLES
(Optional)

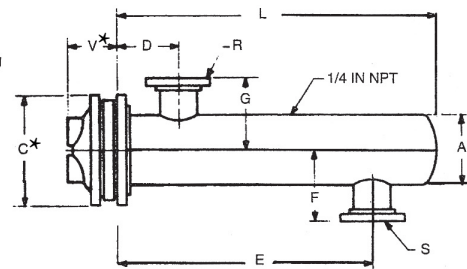
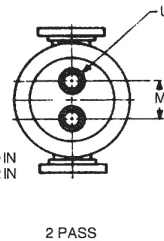
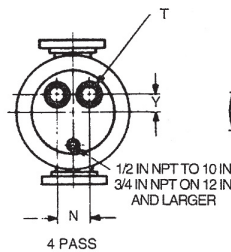

DIMENSIONS

4 Inch Diameter

Model Number		Cast Iron Heads						Dimensions (inches)										Heating Surface (sq. ft.)	Shipping Weight (lbs.)
2 Pass	4 Pass	2 Pass		4 Pass				2 and 4 Pass											
		M	U	N	T	Y	V*	A	C*	D	E	F	G	L	R	S			
G4204L	G4404L	2 1/2	1 1/2 T	2 3/8	1 T	7/8	2 7/8	4 1/2	9	5	19 1/2	3 7/8	3 7/8	24 1/2	1 1/2 T	1 1/2 T	4.6	65	
G4206L	G4406L	2 1/2	1 1/2 T	2 3/8	1 T	7/8	2 7/8	4 1/2	9	5	31 1/2	3 7/8	3 7/8	36 1/2	1 1/2 T	1 1/2 T	7.0	75	
G4208L	G4408L	2 1/2	1 1/2 T	2 3/8	1 T	7/8	2 7/8	4 1/2	9	5	43 1/2	3 7/8	3 7/8	48 1/2	1 1/2 T	1 1/2 T	9.3	84	
G4210L	G4410L	2 1/2	1 1/2 T	2 3/8	1 T	7/8	2 7/8	4 1/2	9	5	55 1/2	3 7/8	3 7/8	60 1/2	1 1/2 T	1 1/2 T	11.7	94	
G4212L	G4412L	2 1/2	1 1/2 T	2 3/8	1 T	7/8	2 7/8	4 1/2	9	5	67 1/2	3 7/8	3 7/8	72 1/2	1 1/2 T	1 1/2 T	14.1	104	
G4214L	G4414L	2 1/2	1 1/2 T	2 3/8	1 T	7/8	2 7/8	4 1/2	9	5	79 1/2	3 7/8	3 7/8	84 1/2	1 1/2 T	1 1/2 T	16.4	114	
G4216L	G4416L	2 1/2	1 1/2 T	2 3/8	1 T	7/8	2 7/8	4 1/2	9	5	91 1/2	3 7/8	3 7/8	96 1/2	1 1/2 T	1 1/2 T	18.8	124	
G4218L	G4418L	2 1/2	1 1/2 T	2 3/8	1 T	7/8	2 7/8	4 1/2	9	5	103 1/2	3 7/8	3 7/8	108 1/2	1 1/2 T	1 1/2 T	21.1	134	
G4220L	G4420L	2 1/2	1 1/2 T	2 3/8	1 T	7/8	2 7/8	4 1/2	9	5	115 1/2	3 7/8	3 7/8	120 1/2	1 1/2 T	1 1/2 T	23.5	144	

SADDLE DIMENSIONS: H-5 1/4; W-6 15/16; X-5 1/2; Hole Dia. - 1/2

MATERIALS OF CONSTRUCTION (Unless otherwise indicated, standard will be furnished.)

Shell	Standard Steel
Head	Cast Iron 4-10" Fabricated Steel 12-30"
Tubes	3/4 x 20 BWG Copper
Tube Sheet	Steel
Separators	Steel
Working Pressure	150 PSIG (ASME)
Max. Temperature	375°F

Optional 304ss, 316ss * Cast Bronze, Fabricated Steel, Fabricated 304ss/316ss Fabricated 304ss/316ss 3/4 x 18 BWG Copper, Steel, 304ss, 316ss, 90/10 Cu Ni Brass, 304ss, 316ss, 90/10 Cu Ni Brass, 304ss, 316ss, 90/10 Cu Ni Consult Factory Consult Factory

* When choosing any option with fabricated head type, refer to submittal 201-022 for head dimensions. Fabricated heads will feature flanged connections.

All dimensions shown are subject to change and should not be used for pre-piping. Contact your local Taco representative should certified dimensional drawings be required.





Enhanced Surface U Tube Heat Exchangers

30" DIAMETER LIQUID

SUPERSEDES: New

EFFECTIVE: May 16, 2014

Job: _____

Item No.	Model No.	Pass	GPM Tubes	Temp. In	Temp. Out	Pressure Drop Tubes	Velocity Tubes	GPM Shell	Temp. In	Temp. Out	Pressure Drop Shell	Velocity Shell

Tube Fluid: _____

Shell Fluid: _____

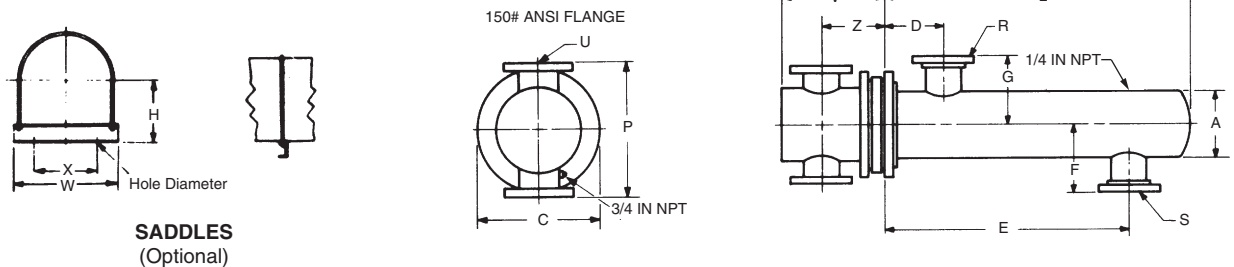

DIMENSIONS: 30 Inch Diameter

Model Number	Fabricated Steel Heads			Dimensions (Inches)										Heating Surface (sq. ft.)	Shipping Weight (lbs)
	C	P	U	A	D	E	F	G	L	R	S	V	Z		
E30210L	35 $\frac{3}{4}$	42	14F	30	11	47	20 $\frac{3}{4}$	20 $\frac{3}{4}$	62	10F	10F	32	21 $\frac{1}{4}$	663.4	3205
E30212L	35 $\frac{3}{4}$	42	14F	30	11	59	20 $\frac{3}{4}$	20 $\frac{3}{4}$	74	10F	10F	32	21 $\frac{1}{4}$	806.3	3524
E30214L	35 $\frac{3}{4}$	42	14F	30	11	71	20 $\frac{3}{4}$	20 $\frac{3}{4}$	86	10F	10F	32	21 $\frac{1}{4}$	949.2	3843
E30216L	35 $\frac{3}{4}$	42	14F	30	11	83	20 $\frac{3}{4}$	20 $\frac{3}{4}$	98	10F	10F	32	21 $\frac{1}{4}$	1092.0	4162
E30218L	35 $\frac{3}{4}$	42	14F	30	11	95	20 $\frac{3}{4}$	20 $\frac{3}{4}$	110	10F	10F	32	21 $\frac{1}{4}$	1235.0	4481
E30220L	35 $\frac{3}{4}$	42	14F	30	11	107	20 $\frac{3}{4}$	20 $\frac{3}{4}$	122	10F	10F	32	21 $\frac{1}{4}$	1378.0	4800

SADDLE DIMENSIONS: H-19; W-33; X-22; Hole Dia.- $\frac{3}{4}$."

MATERIALS OF CONSTRUCTION (Unless otherwise indicated, standard will be furnished.)

	Standard	Optional
Shell	Steel	304ss, 316ss
Head	Cast Iron 4-10" Fabricated Steel 12-30"	Fabricated Steel, Cast Bronze, Fabricated 304ss/316ss Cast Bronze, Fabricated 304ss/316ss
Tubes	3/4 x 20 BWG Copper	3/4 x 18 BWG Copper, Steel, 304ss, 316ss, 90/10 Cu Ni, Admiralty
Tube Sheet	Steel	Bronze, Brass, 304ss, 316ss, 90/10 Cu Ni
Separators	Steel	Bronze, Brass, 304ss, 316ss, 90/10 Cu Ni
Working Pressure	150 PSIG (ASME)	Consult Factory
Max. Temperature	375°F	Consult Factory

All dimensions shown are subject to change and should not be used for pre-piping. Contact your local Taco representative should certified dimensional drawings be required.

Do it Once. Do it Right.

TACO, INC., 1160 Cranston Street, Cranston, RI 02920 Telephone: (401) 942-8000 FAX: (401) 942-2360.
 TACO (Canada), Ltd., 6180 Ordan Drive, Mississauga, Ontario L5T 2B3. Telephone: 905/564-9422. FAX: 905/564-9436.
 Visit our web site at: <http://www.taco-hvac.com>

Printed in USA
 Copyright 2014
 TACO, Inc.



Enhanced Surface U Tube Heat Exchangers

26" DIAMETER LIQUID

SUPERSEDES: New

EFFECTIVE: May 16, 2014

Job: _____

Item No.	Model No.	Pass	GPM Tubes	Temp. In	Temp. Out	Pressure Drop Tubes	Velocity Tubes	GPM Shell	Temp. In	Temp. Out	Pressure Drop Shell	Velocity Shell

Tube Fluid: _____

Shell Fluid: _____

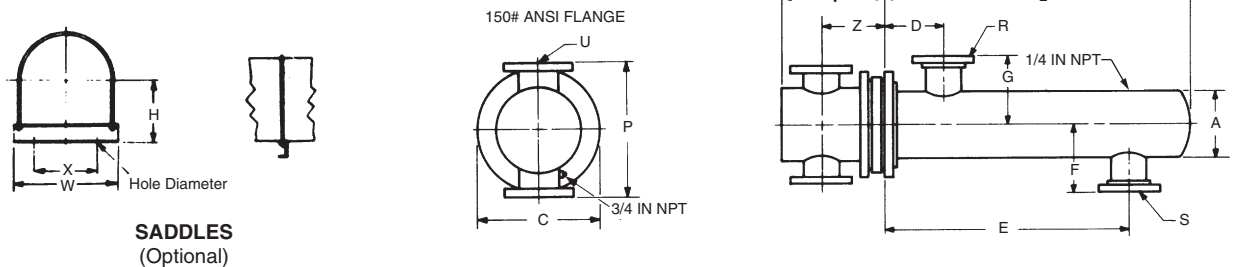

DIMENSIONS: 26 Inch Diameter

Model Number	Fabricated Steel Heads			Dimensions (Inches)										Heating Surface (sq. ft.)	Shipping Weight (lbs)
	C	P	U	A	D	E	F	G	L	R	S	V	Z		
E26208L	31½	37	12F	26	11	35¾	18½	18½	48	10F	10F	28¾	19	393.4	2036
E26210L	31½	37	12F	26	11	47¾	18½	18½	60	10F	10F	28¾	19	500.2	2280
E26212L	31½	37	12F	26	11	59¾	18½	18½	72	10F	10F	28¾	19	607.0	2524
E26214L	31½	37	12F	26	11	71¾	18½	18½	84	10F	10F	28¾	19	713.8	2768
E26216L	31½	37	12F	26	11	83¾	18½	18½	96	10F	10F	28¾	19	820.6	3012
E26218L	31½	37	12F	26	11	95¾	18½	18½	108	10F	10F	28¾	19	927.4	3256
E26220L	31½	37	12F	26	11	107¾	18½	18½	120	10F	10F	28¾	19	1034.0	3500

SADDLE DIMENSIONS: H-17; W-29; X-20; Hole Dia.-¾.

MATERIALS OF CONSTRUCTION (Unless otherwise indicated, standard will be furnished.)

	Standard	Optional
Shell	Steel	304ss, 316ss
Head	Cast Iron 4-10" Fabricated Steel 12-30"	Fabricated Steel, Cast Bronze, Fabricated 304ss/316ss Cast Bronze, Fabricated 304ss/316ss
Tubes	¾ x 20 BWG Copper	¾ x 18 BWG Copper, Steel, 304ss, 316ss, 90/10 Cu Ni, Admiralty
Tube Sheet	Steel	Bronze, Brass, 304ss, 316ss, 90/10 Cu Ni
Separators	Steel	Bronze, Brass, 304ss, 316ss, 90/10 Cu Ni
Working Pressure	150 PSIG (ASME)	Consult Factory
Max. Temperature	375°F	Consult Factory

All dimensions shown are subject to change and should not be used for pre-piping. Contact your local Taco representative should certified dimensional drawings be required.

Do it Once. Do it Right.

TACO, INC., 1160 Cranston Street, Cranston, RI 02920 Telephone: (401) 942-8000 FAX: (401) 942-2360.
TACO (Canada), Ltd., 6180 Ordan Drive, Mississauga, Ontario L5T 2B3. Telephone: 905/564-9422. FAX: 905/564-9436.

Visit our web site at: <http://www.taco-hvac.com>

Printed in USA
Copyright 2014
TACO, Inc.