

# Vogue Booth

## Product Parts

- Top panles
- Side panles
- Back side panles
- Feets and connector
- LED LIGHTS - 23PCS
- Controller with power supply
- Wires
- Remote control
- Graphic

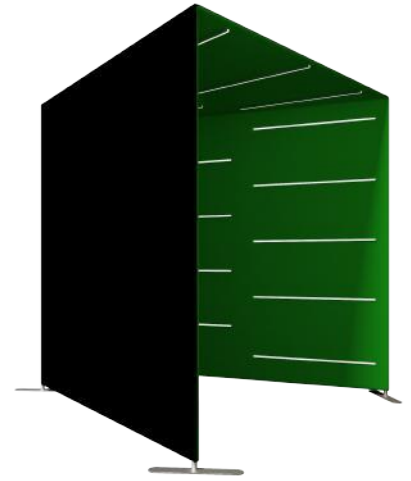

## Display Set-Up

### Step 1

Begin by removing all parts from the carry case and place on a clean, flat surface. Ensure you have all the components listed above.

### Step 2

Assemble all the poles by connecting the corresponding numbers together while pressing the snap button as shown.

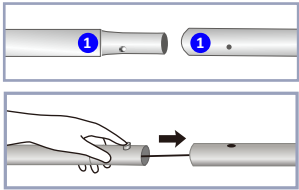

### Step 3

Step 3, Continue to connect the poles illustrated in the image below. each frame connect by 2 pins feet and connector



### Step 4

Drape the Graphic over the hardware as shown (Notice: Keep Bottom Zipper Open)



### Step 5

Attached the LED light to stand as shown



### Step 6

Connect the wires as shown, and then hidden the wires through the holes

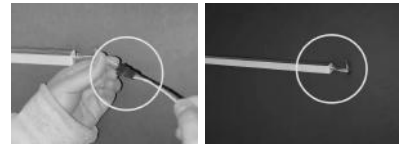

### Step 7

Take all the wires out from the bottom and then close the zipper

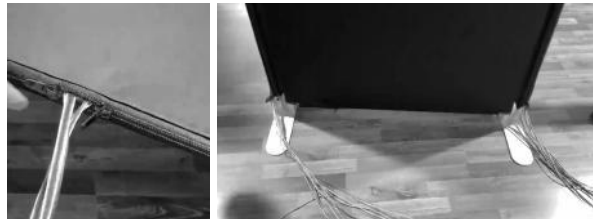

### Step 8

Connect all the wires to the controller



### Step 9

Connect the power and control the lights with the remote



## Storage & Care

Place all product parts into Carry Case and store in a cool dry location. Recommended for indoor use only. Machine wash on gentle cycle using mild detergent. Tumble Dry No Heat. Do NOT dry clean, Do NOT Iron.