

### **Model 0013 Cartridge Circulator**

The High Velocity series Taco 0013 Cartridge Circulator is designed for quiet, efficient operation in high head / high flow applications for Large Residential / Light Commercial Hydronic heating, Radiant heating, Chilled Water cooling and Domestic fresh water systems. The exclusive ACB anti-condensate baffle with ambient air flow prevents the build up of condensate on the motor windings when pumping chilled water. Its unique field-serviceable cartridge contains all moving parts. Replacing the cartridge rebuilds the circulator. With no mechanical seal, the self-lubricating, maintenance free design provides unmatched reliability. Compact and lightweight, with excellent performance characteristics, the 0013 is ideal for high efficiency jobs where space is a premium. Available in Cast Iron or Stainless Steel construction.



Low-Lead  
Compliant



# Submittal Data Information Model 0013 Cartridge Circulator

Submittal Data # 101-064  
Supersedes: 06/13/13

Effective: 01/12/15

## Features

- Exclusive ACB Anti-Condensate Baffle with Ambient Air Flow-Protects motor windings against condensate buildup
- High Velocity Performance — Compact design
- Quiet, Efficient operation
- Direct Drive-Low Power consumption
- Unique Replaceable Cartridge design-field serviceable
- Self lubricating
- No Mechanical Seal
- Unmatched reliability - Maintenance free
- Universal Flange to Flange dimensions
- Cast Iron or Stainless Steel Construction

## Materials of Construction

ACB Baffle..... Non-Ferrous  
Casing (Volute):..... Cast Iron or Stainless Steel  
Stator Housing:..... Aluminum  
Cartridge:..... Stainless Steel  
Impeller:..... Non-Metallic  
Shaft:..... Ceramic  
Bearings:..... Carbon  
O-Ring & Gaskets:.... EPDM

## Model Nomenclature

F – Cast Iron, Flanged  
SF – Stainless Steel, Flanged

## Performance Data

Max. Flow: 34 GPM  
Max. Head: 33 Feet  
Min. Fluid Temperature: 40°F (4°C)  
Max. Fluid Temperature: 230°F (110°C)  
Max. Working Pressure: 150 psi  
Connection Sizes:  
3/4", 1", 1-1/4", 1-1/2" Flanged

## Certifications & Listings



## Application

The Taco 0013 is specifically designed for high head / high flow applications in Large Residential and Light Commercial systems. Ideal for high pressure drop Boilers, Fan Coil units, Heat Exchangers, larger Radiant systems, Heat Recovery and Geothermal systems. The Stainless Steel 0013 should be used on open loop systems. The unique replaceable cartridge contains all of the moving parts and allows for easy service instead of replacing the entire circulator. Universal flange to flange dimensions and orientation allows the 0013 to easily replace other models. Compact, low power consumption design makes it ideal for high-efficiency jobs.

## Pump Dimensions & Weights

Models	Casing	A		B		C		D		F		G		Ship Wt.	
		in.	mm	in.	mm	in.	mm	in.	mm	in.	mm	in.	mm	lbs.	Kg
0013-F3	Cast Iron	7-1/2	191	6-1/8	156	3-1/2	89	3-3/8	86	6	152	6-1/2	165	12.0	5.5
0013-SF3	St. Steel	7-1/2	191	6-1/8	156	3-1/2	89	3-3/8	86	6	152	6-1/2	165	11.5	5.2

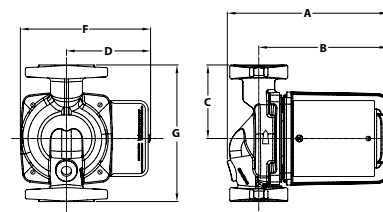

## Mounting Positions

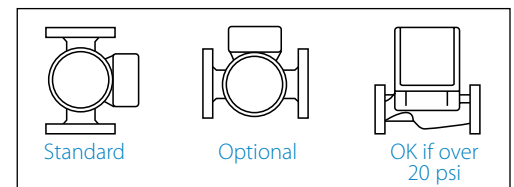

## Electrical Data

Model	Volts	Hz	Ph	Amps	RPM	HP
All Models	115	60	1	2.0	3250	1/6
Motor Type	Permanent Split Capacitor Impedance Protected					
Motor Options	220/50/1, 220/60/1, 230/60/1, 100/110/50/60/1					

## Flange Orientation

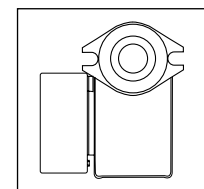

## Performance Field - 60Hz

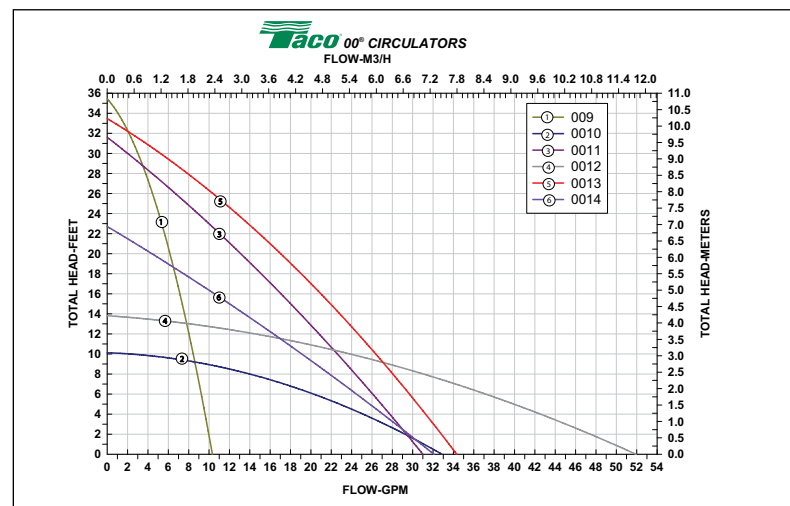

Taco Inc., 1160 Cranston Street, Cranston, RI 02920 / (401) 942-8000 / Fax (401) 942-2360  
Taco (Canada) Ltd., 8450 Lawson Road, Unit #3, Milton, Ontario L9T 0J8 / (905) 564-9422 / Fax (905) 564-9436  
[www.taco-hvac.com](http://www.taco-hvac.com)