



Submittal Data Information

101-100

Model 0012-IFC® Cartridge Circulator

Effective: January 12, 2015

Supersedes: June 12, 2013

Job: _____ Engineer: _____ Contractor: _____ Rep: _____

ITEM NO.	MODEL NO.	IMP. DIA.	G.P.M.	HEAD/FT.	H.P.	ELEC. CHAR.

Features

- Integral Flow Check (IFC)
 - Prevents gravity flow
 - Eliminates separate in-line flow check
 - Reduces installed cost, easy to service
 - Improved performance vs. In-line flow checks
- Unique replaceable cartridge
 - Field serviceable
- Unmatched reliability
 - Maintenance free
- Quiet, efficient operation
- Direct drive-Low power consumption
- Self lubricating, No mechanical seal
- Standard high capacity output
 - Compact design
- Wide range of applications
- Cast Iron or Stainless Steel construction, Flanged connections

Materials of Construction

Casing (Volute): Cast Iron or Stainless Steel
 Integral Flow Check:
 Body, Plunger.....Acetal
 O-ring SealsEPDM
 Spring.....Stainless Steel
 Stator Housing:.....Aluminum
 Cartridge:.....Stainless Steel
 Impeller:.....Non-Metallic
 Shaft:.....Ceramic
 Bearings:.....Carbon
 O-Ring & Gaskets:.....EPDM

Model Nomenclature

F – Cast Iron, Flanged
 SF – Stainless Steel, Flanged
 IFC – Integral Flow Check

Performance Data

Max. Flow: 42 GPM
 Max. Head: 13 Feet
 Min. Fluid Temperature: 40°F (4°C)
 Max. Fluid Temperature: 230°F (110°C)
 Max. Working Pressure: 150 psi
 Connection Sizes: 1-1/2" or 2", Flanged

Certifications & Listings

Application

The Taco 0012-IFC with Integral Flow Check (IFC) is designed to reduce installation costs when zoning with 00" circulators on high flow / medium head applications in large residential and light commercial systems. Ideal for large BTUH Boilers, 2" recirculation loops, primary/secondary loops, commercial water heaters and light commercial heating and cooling systems. The Stainless Steel 0012-IFC can be used on open loop systems. The unique replaceable cartridge contains all of the moving parts and allows for easy service instead of replacing the entire circulator.

Pump Dimensions & Weights FLANGES INCLUDED

Models	Casing	Flange Size	Flange Code	A		B		C		D		F		G		Ship Wt.	
				in.	mm	in.	mm	in.	mm	in.	mm	in.	mm	in.	mm	lbs.	Kg
0012-F4-IFC	Cast Iron	1-1/2"	R	8-1/16	205	6-3/8	162	4-1/4	108	3-5/16	84	6	152	8-1/2	216	14.0	6.3
0012-F4-2 IFC	Cast Iron	1-1/2"	S	8-5/8	219	6-3/8	162	4-1/4	108	3-5/16	84	6	152	8-1/2	216	14	6.3
0012-F4-1 IFC	Cast Iron	2"	S	9	229	6-3/8	162	4-1/4	108	3-5/16	84	6	152	8-1/2	216	14	6.3
0012-SF4-IFC	St. Steel	1-1/2"	S	8-5/8	219	6-3/8	162	4-1/4	108	3-5/16	84	6	152	8-1/2	216	14	6.3
0012-SF4-2 IFC	St. Steel	1-1/2"	R	8-1/16	205	6-3/8	162	4-1/4	108	3-5/16	84	6	152	8-1/2	216	14	6.3

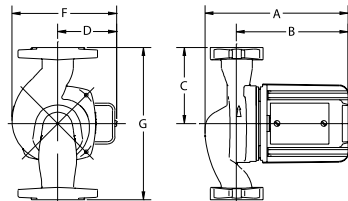

Mounting Positions

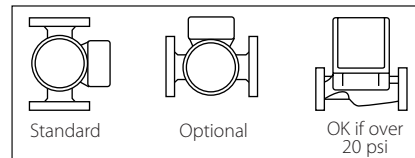

Electrical Data

Model	Volts	Hz	Ph	Amps	RPM	HP
All Models	115	60	1	1.33	3250	1/8
Motor Type	Permanent Split Capacitor Impedance Protected					
Motor Options	220/50/1, 220/60/1, 230/60/1, 100/110/50/60/1					

Flange Orientation

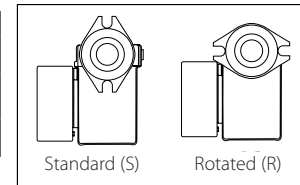

Performance Field - 60Hz

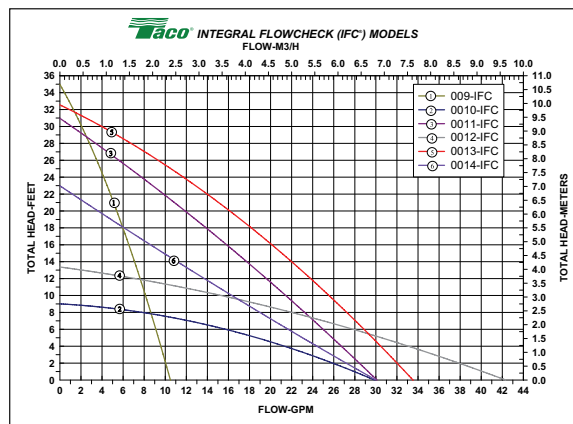

Do your best work.®

TACO INC., 1160 Cranston Street, Cranston, RI 02920 Telephone: (401) 942-8000 Fax: 942-2360
 TACO (Canada), Ltd., 6180 Ordan Drive, Mississauga, Ontario L5T 2B3 Telephone: (905) 564-9422 Fax: (905) 564-9436
 Visit our website at: www.taco-hvac.com

Printed in USA
 Copyright 2015
 TACO, Inc.