



# Submittal Data Information

101-064

## Model 0013 Cartridge Circulators

Effective: October 29, 2008

Supersedes: October 1, 2002

Job: \_\_\_\_\_ Engineer: \_\_\_\_\_ Contractor: \_\_\_\_\_ Rep: \_\_\_\_\_

ITEM NO.	MODEL NO.	IMP. DIA.	G.P.M.	HEAD/FT.	H.P.	ELEC. CHAR.

### Features

- Exclusive ACB Anti-Condensate Baffle with Ambient Air Flow-Protects motor windings against condensate buildup
- High Velocity Performance-Compact design
- Quiet, Efficient operation
- Direct Drive-Low Power consumption
- Unique Replaceable Cartridge design-field serviceable
- Self lubricating
- No Mechanical Seal
- Unmatched reliability - Maintenance free
- Universal Flange to Flange dimensions
- Cast Iron, Bronze or Stainless Steel Construction

### Materials of Construction

ACB Baffle	Non-Ferrous
Casing (Volute):	Cast Iron, Bronze or 304 Stainless Steel
Stator Housing:	Aluminum
Cartridge:	Stainless Steel
Impeller:	Non-Metallic
Shaft:	Ceramic
Bearings:	Carbon
O-Ring & Gaskets:	EPDM

### Model Nomenclature

- F – Cast Iron, Flanged
- BF – Bronze, Flanged
- SF – 304 Stainless Steel, Flanged

### Variations:

- Z – Zoning Circulator
- J – Bronze Cartridge with Cast Iron Casing

### Performance Data

- Flow Range: 0 – 34 GPM
- Head Range: 0 – 33 Feet
- Minimum Fluid Temperature: 40°F (4°C)
- Maximum Fluid Temperature: 230°F (110°C)
- Maximum Working Pressure: 125 psi
- Connection Sizes: 3/4", 1", 1-1/4", 1-1/2" Flanged



**FOR INDOOR USE ONLY**

### Application

The Taco 0013 is specifically designed for high head / high flow applications in Large Residential and Light Commercial systems. Ideal for high pressure drop Boilers, Fan Coil units, Heat Exchangers, larger Radiant systems, Heat Recovery and Geothermal systems. The Bronze or Stainless Steel 0013 should be used on open loop systems. The unique replaceable cartridge contains all of the moving parts and allows for easy service instead of replacing the entire circulator. Universal flange to flange dimensions and orientation allows the 0013 to easily replace other models. Compact, low power consumption design makes it ideal for high-efficiency jobs.

### Pump Dimensions & Weights

Model	Casing	A		B		C		D		F		G		Ship Wt.	
		in.	mm	in.	mm	in.	mm	in.	mm	in.	mm	in.	mm	lbs.	Kg
0013-F3	Cast Iron	7-1/2	191	6-3/8	162	3-1/2	89	3-7/8	98	6	152	6-1/2	165	12.0	5.5
0013-BF3	Bronze	7-1/2	191	6-3/8	162	3-1/2	89	3-7/8	98	6	152	6-1/2	165	12.0	5.5
0013-SF3	St. Steel	7-1/2	191	6-3/8	162	3-1/2	89	3-7/8	98	6	152	6-1/2	165	11.5	5.2

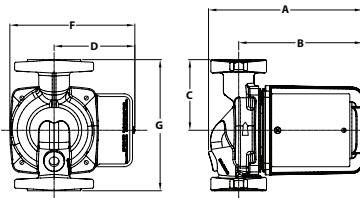

### Mounting Positions

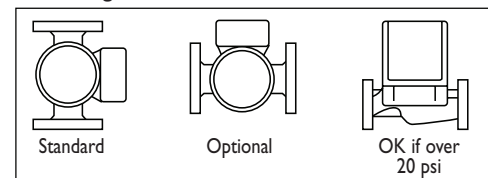

### Electrical Data

Model	Volts	Hz	Ph	Amps	RPM	HP
All Models	115	60	1	2.0	3250	1/6
Motor Type	Permanent Split Capacitor Impedance Protected					
Motor Options	220/50/1, 220/60/1, 230/60/1, 100/110/50/60/1					

### Flange Orientation

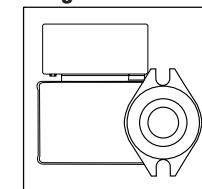

### Performance Field - 60Hz

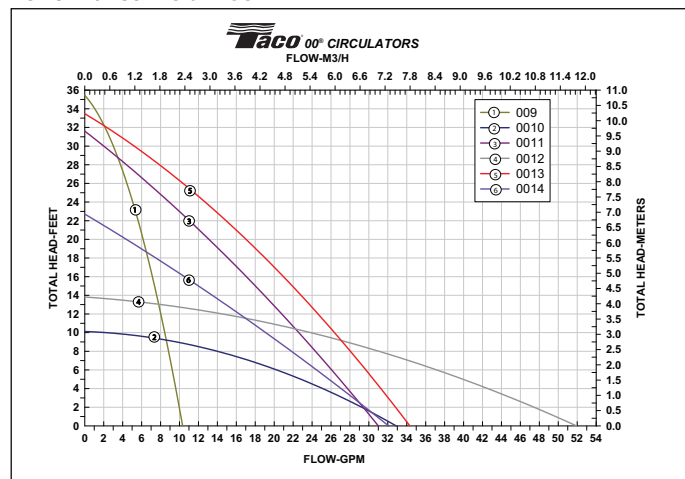

## Do it Once. Do it Right.®

TACO INC., 1160 Cranston Street, Cranston, RI 02920 Telephone: (401) 942-8000 Fax: 942-2360

TACO (Canada), Ltd., 6180 Ordan Drive, Mississauga, Ontario L5T 2B3 Telephone: (905) 564-9422 Fax: (905) 564-9436

Visit our website at: [www.taco-hvac.com](http://www.taco-hvac.com)

Printed in USA

Copyright 2007

TACO, Inc.