

My CrossWave HF3 brush is not turning | Support

CrossWave HF3™ Cordless Multi-Surface Wet Dry Vac

Clean brush roll

- Turn machine OFF
- Remove brush roll cover > Pinch tabs and lift up
- Remove brush roll > Pull tab on right of brush roll

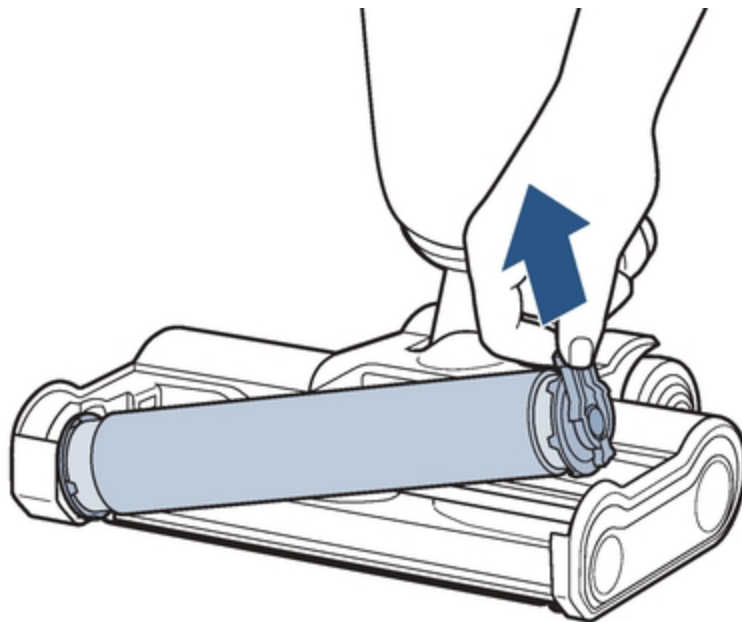
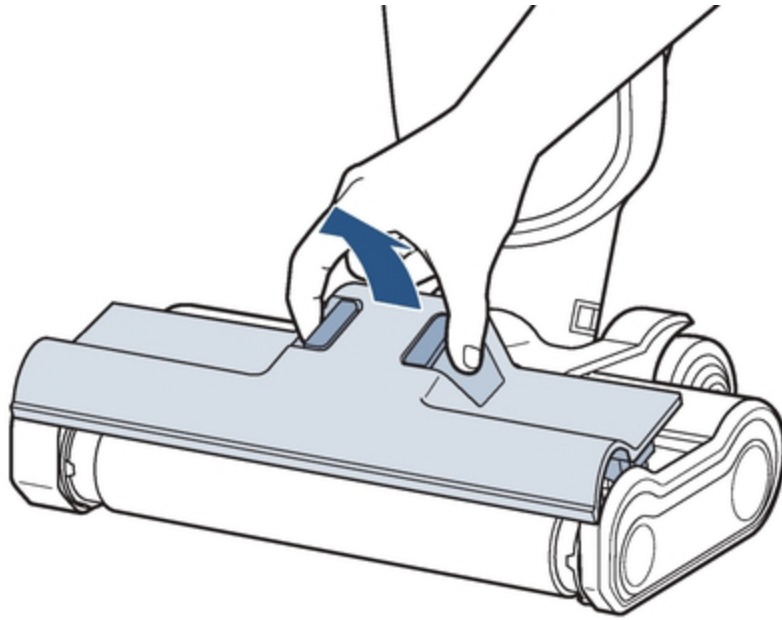

- Clean brush roll area with cloth or brush
- Ensure all wrapping & debris on ends of brush roll is removed
- Test brush roll for damage
 - Hold brush roll by end tab
 - Spin brush roll
 - Brush should spin several times with one flick
- If brush roll does not spin freely > Go to **Parts & Supplies** to order replacement

Reinstall parts

- Replace brush roll > Insert end without tab into machine
- Then press end with tab into place

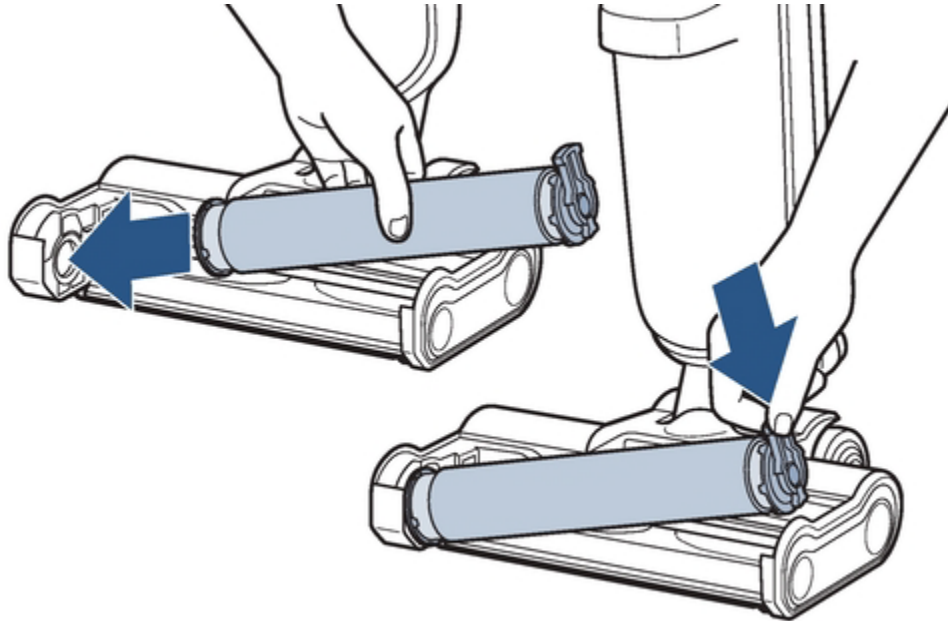

- Install brush roll window
 - Ensure there is NO space between cover & foot
 - If there is a space here > Suction will be impacted
 - Press down on front of window until you hear a click

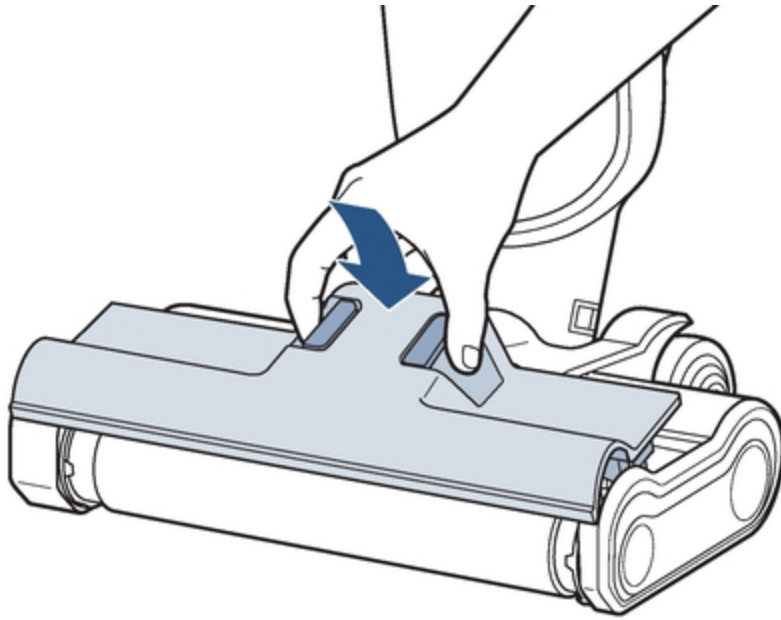

- Confirm there's NO gaps around window

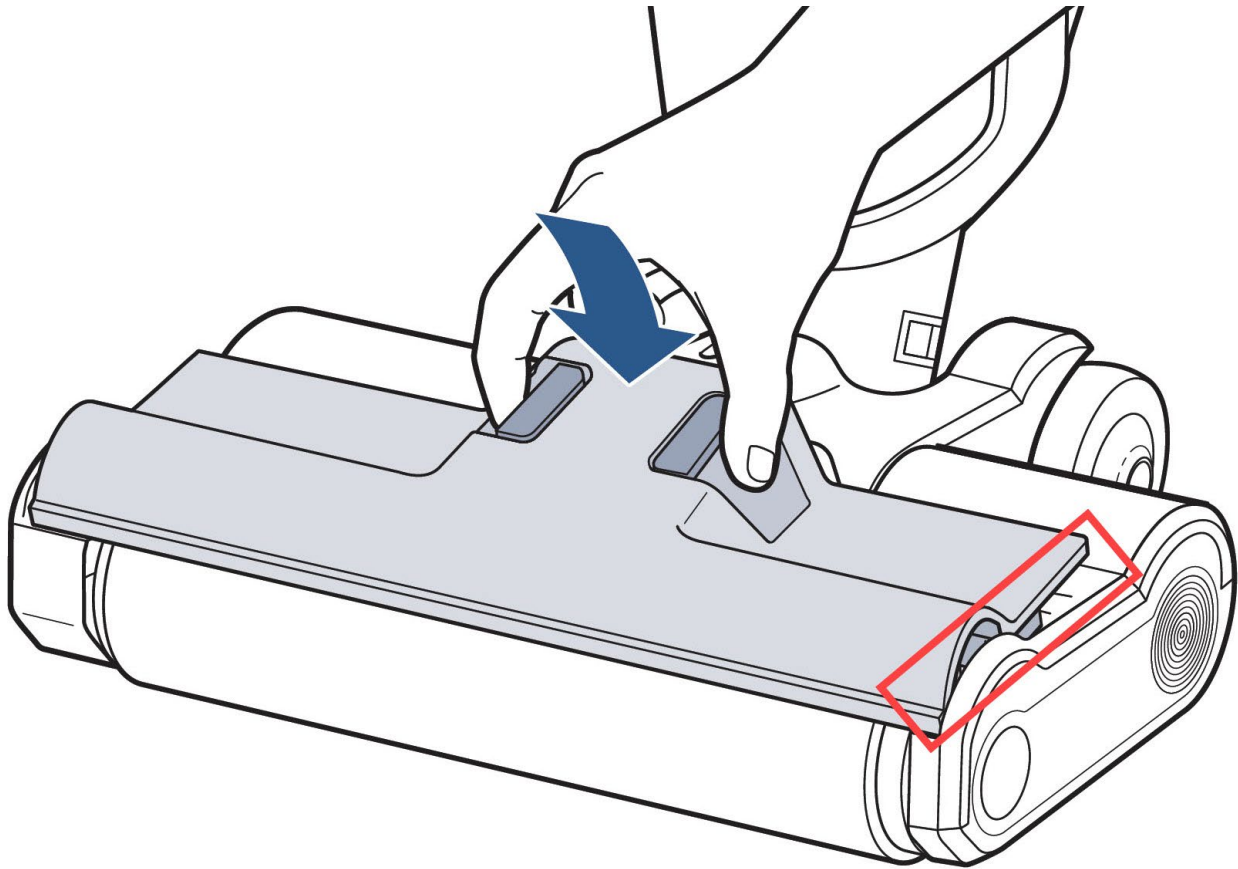

Test machine

- Recline machine and turn ON

Did this resolve your issue?

- If you still need assistance > [Contact Us](#)
 -