



FUSION BATTERY

LITHIUM PULSE

250 SERIES

LFP24-250P

LITHIUM IRON PHOSPHATE BATTERY

PERFORMANCE

- Long Cycle Life >2000 cycles @ 100% DOD.
- High Density, High Discharge Current, High Temperature Range.
- Maintenance Free.
- Fast Charging.
- Environment Friendly.

FEATURES

- Lithium Iron Phosphate (LiFePO4)
- Integrated Battery Management System (BMS)
- BMS with Intelligent Cell Balancing
- Strong Metal Housing

BATTERY DATA SHEET

Electrical Parameters

Nominal Voltage	25.6V
Rated Capacity	250Ah
Energy	6400Wh
Resistance	≤30m Ω
Efficiency	99%
Cycle Life	>2000 cycles @ 1C, 100% DOD
Self Discharge	2% per Month
Max. Battery connected in Series	2 PCS
Max. Battery connected in Parallel	20 PCS

Discharge Parameters

Continuous Discharge Current	250A
Pulse Discharge Current	1000A (5 seconds)
Recommended Volt. Disconnect	20V
BMS Discharge Cut-off Voltage	16V
Reconnect Voltage	18.4V
Short Circuit Protection	200~800 us

Compliance Certificate

Certifications	UL1642 CELL
	CE
	IEC 62133 - 2:2017
	EN 61000-6-3:2007+A1:2011
	EN 61000-6-1:2007
Shipping Classification	UN3480, Class 9, UN38.3

Mechanical Parameters

Dimension (L x W x H)	630 x 215 x 380 mm
	24.8 x 8.46 x 14.96"
Weight	65kg (143.3lbs)
Terminal Type	M8
Battery Housing	Metal case
Housing Protection	IP67
Cell Type-Chemistry	LiFePO4 Cylindrical Cell
SOC Display (Optional)	None

Charge Parameters

Charge Method	CC-CV
Charge Voltage	28.8~29.6V
Recommended Float Voltage	27.6V
Recommended Charge Current	100A
Maximum Charge Current	250A
Minimum Charge Current	25A
BMS Charge Cut-off Voltage	31.2V

Temperature Parameters

Discharge Temperature	-20 to 60°C (-4 to 140°F)
Charge Temperature	0 to 45°C (32 to 113°F)
Storage Temperature	-20 to 60°C (-4 to 140°F)
BMS Low Temperature Cut-off	-10°C (14°F)
BMS Low Temperature Turn-On	0°C (32°F)
BMS High Temperature Cut-off	80°C (176°F)
BMS High Temperature Turn-On	70°C (158°F)

Performance Characteristics

CYCLE LIFE vs. DEPTH OF DISCHARGE(DOD)
DISCHARGE@1C, 25°C

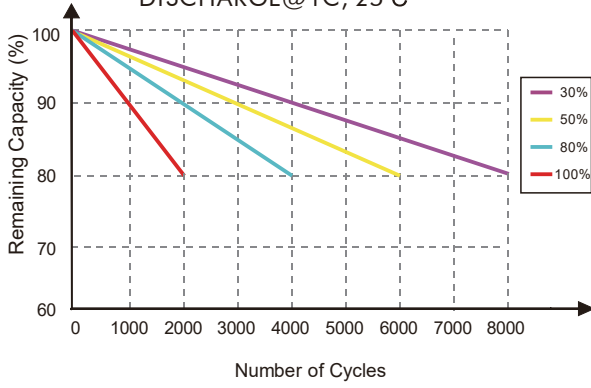

DISCHARGE CAPACITY at VARIOUS TEMPERATURES
DISCHARGE @1C, 25°C

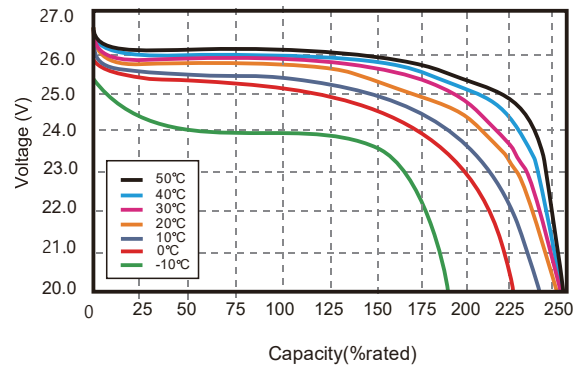

STATE OF CHARGE CURVE @0.5C, 25°C

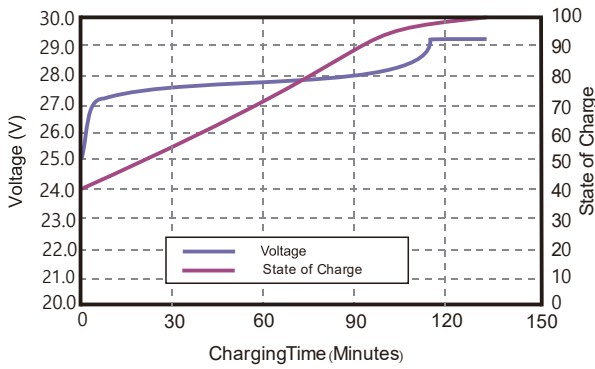

CHARGING CHARACTERISTICS @0.5C, 25°C

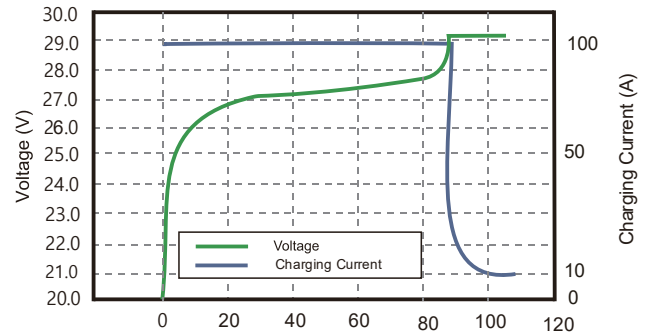

Battery Dimension

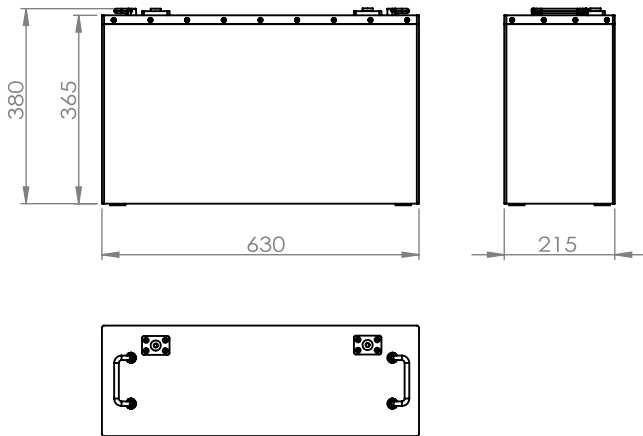

M8 - 1.0x 8mm
Threaded Hole

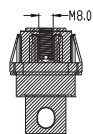
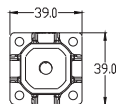

Battery Applications

- + Marine (House Batteries)
- + RV / Camping (Automotive)
- + High-Capacity Inverters
- + Electric Boats



NOTE:

Do Not Mix With Sealed Lead Acid Batteries When Recycling. See FUSION User's Manual for Proper Operation. Fusion Lithium BATTERIES. All Rights Reserved.



TRADING SINCE 1995



QUALITY ASSURANCE
ISO 9001