

**phil&teds**<sup>®</sup>  
adapt&survive!<sup>™</sup>

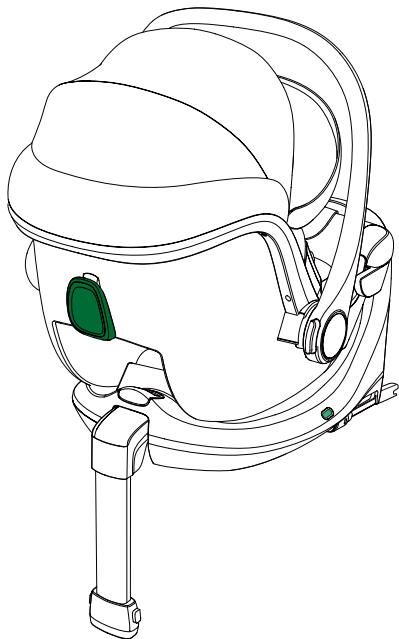

**alpha<sup>™</sup> i-size infant car seat**  
**instructions**

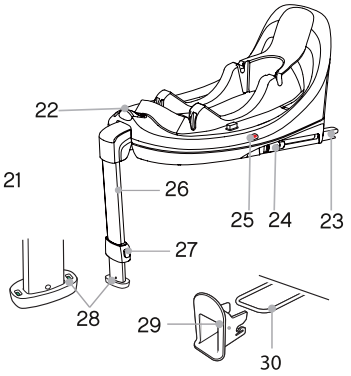
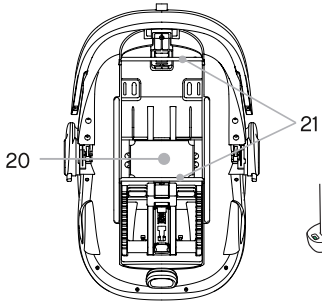
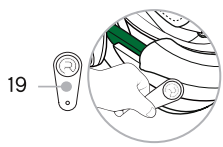
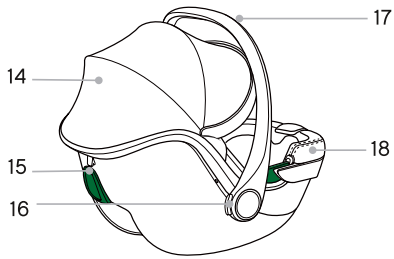
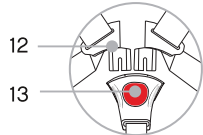
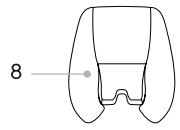
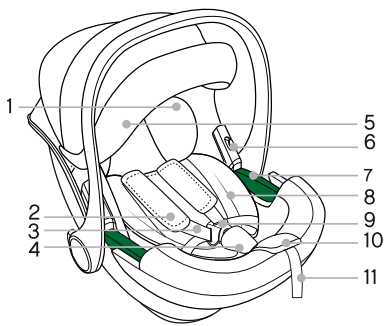

 **warning**

Read the instructions carefully before use and keep for future reference.

- |  |  |
|--|--|
| 1. Headrest  | 18. Seat Cover                           |
| 2. Shoulder pads                                       | 19. Fabric elf                           |
| 3. Shoulder straps                                     | 20. Instruction Storage                  |
| 4. Crotch pad  | 21. Metal Bars                           |
| 5. Headrest Height Adjuster                            | 22. Release Button                       |
| 6. Separate Adapter Buttons<br>(optional for stroller) | 23. ISOFIX Locking Arms                  |
| 7. Vehicle Lap Belt Guidance                           | 24. ISOFIX Buttons                       |
| 8. Newborn insert                                      | 25. Base Indicators                      |
| 9. Harness Buckle                                      | 26. Support Leg                          |
| 10. Adjustment Button                                  | 27. Adjustment Buttons                   |
| 11. Adjustment Strap                                   | 28. Support Leg Indicators               |
| 12. Buckle Tongues                                     | 29. ISOFIX Insertion Aids (optional)     |
| 13. Red Release Button                                 | 30. ISOFIX Fastening Points<br>(vehicle) |
| 14. Sunhood  |  |
| 15. Vehicle Diagonal Belt Guidance                     |  |
| 16. Swivel Buttons                                     |  |
| 17. Handle   |  |

## **warranty**

All of our products have a one year warranty from date of purchase against defects in material and workmanship.\*

Additionally, when you register your product online within 30 days of purchase, you are eligible for a 2 year warranty free of charge.

Once registered, you can further extend the warranty to 3 years by purchasing an extended warranty within 30 days of purchase.

The warranty period starts from the purchase and is valid for a period of 12 months.

The warranty is only applicable to the original owner and is not transferable. The warranty is only applicable to products which have not been modified by the user. In the case of any defects, the owner is required to return the product to the retailer.

## **no warranty given if:**

There is no purchase receipt.

Defects are caused by misuse or maintenance which differs from that indicated in the instruction manual.

Repairs are carried out by third parties.

Defects are caused by neglect.

Damage or removal of any serial number is found.

For normal wear and tear which may be expected in daily use.

The stated warranty terms and conditions have not been satisfied.

Please register your product purchase online now.

\*you may be entitled to other rights in some countries.

1. handle

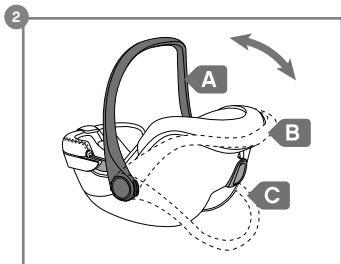
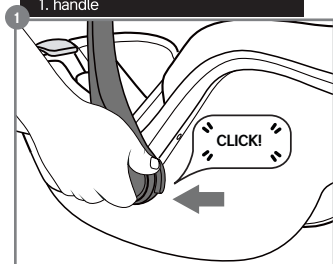

2. sunhood

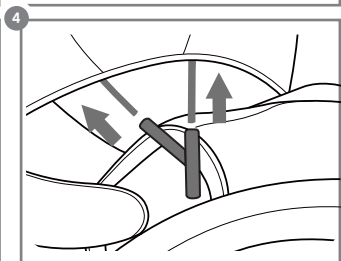
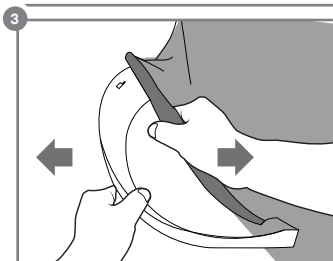
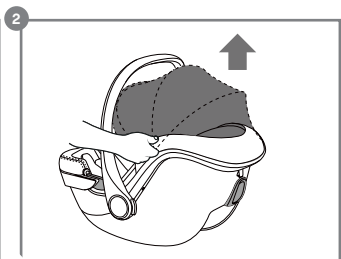
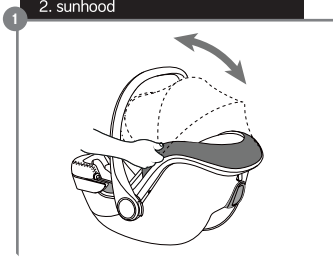

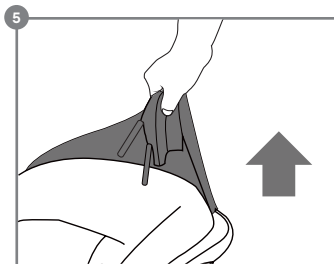

3. securing your baby

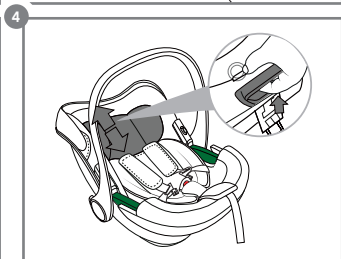
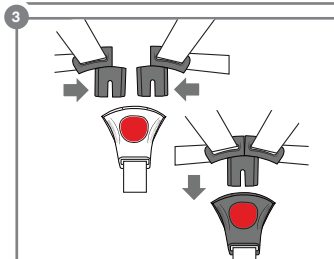
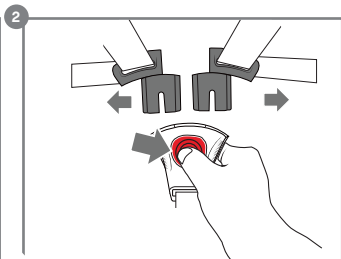
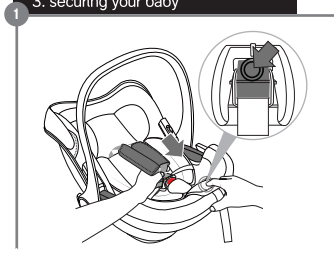

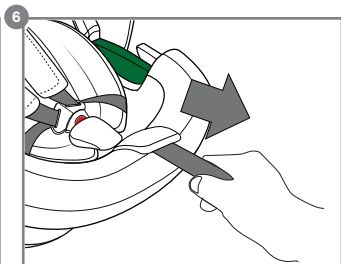
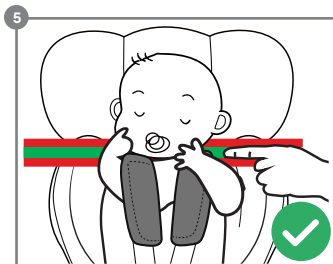

1 4. preparation

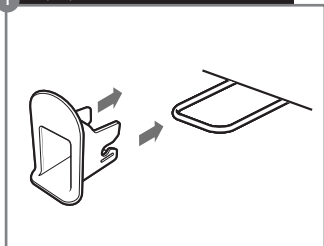

1 5. installation of the ISOFIX base

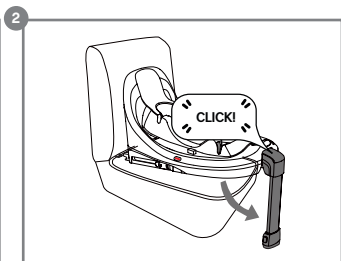
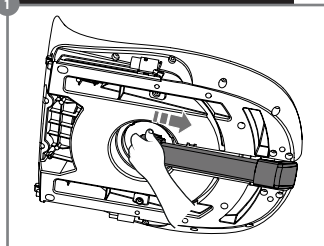



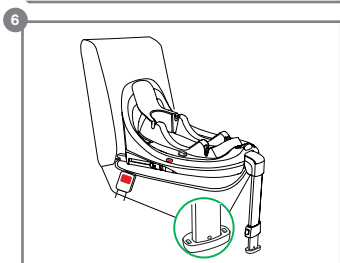
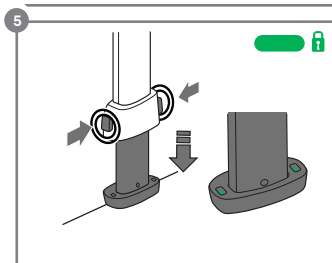
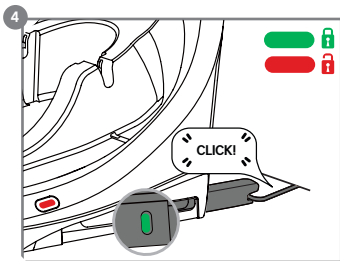
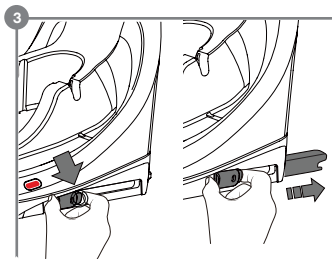

6. installation of the infant carrier

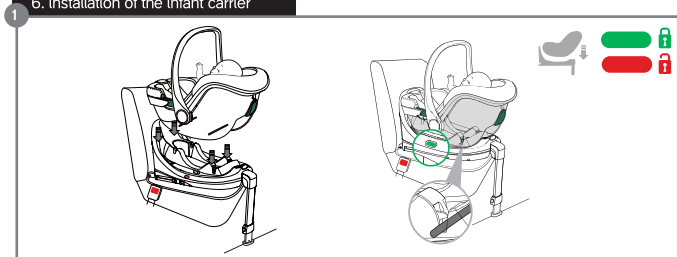

7. remove from vehicle

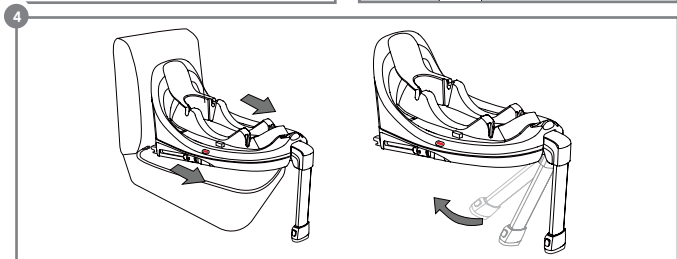
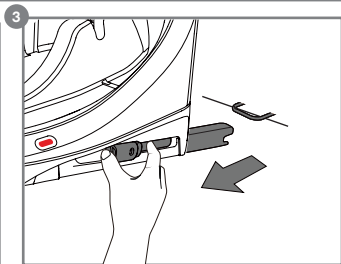
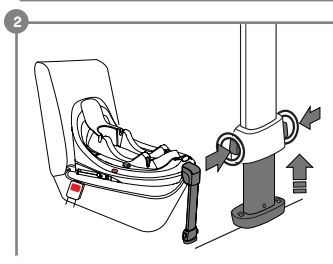
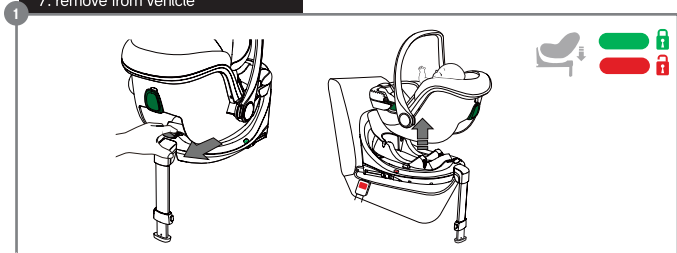

8. seat cover

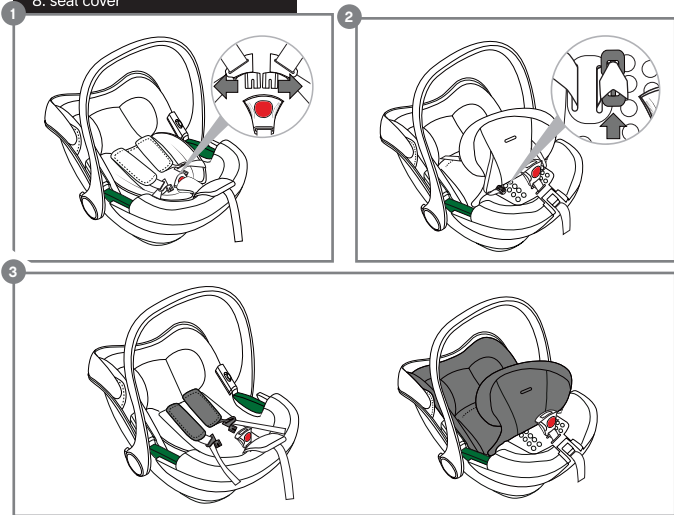



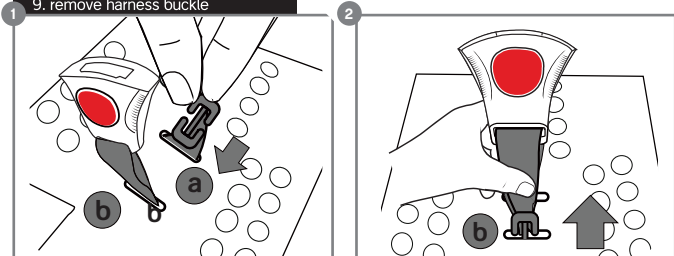

9. remove harness buckle



## approval

These instructions use the following symbols:

Symbol	Keyword	Explanation
	<b>DANGER!</b>	RISK of severe personal injury
	<b>WARNING!</b>	RISK of minor personal injury
	<b>CAUTION!</b>	RISK of material damage
	<b>TIP!</b>	Useful notes

The alpha® with ISOFIX base is exclusively intended to secure your child in your vehicle.

i-SIZE		
Body size	40 - 87cm ≤ 13kg	Never use the infant carrier facing forwards.
Installation method	Isofix+Support leg	

This infant carrier has been designed, tested and approved according to the requirements of the European Standard for Child Safety Equipment R129/03. This infant carrier may only be used to secure a child in the vehicle.

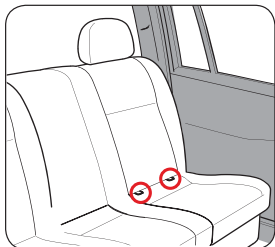

rearward facing

40-87cm ≤ 13kg

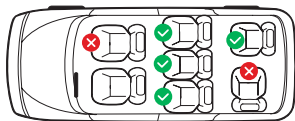

This Enhanced Child Restraint System (ECRS) is suitable for vehicles equipped with the ECE R14 requirements. The car seat base is only for use with an ISOFIX anchorage system.

## 1. handle

- 1 Hold down both swivel buttons (16). Move handle (17) to desired position, then release swivel buttons (16).  
Ensure that the handle locks(17) with a clicking sound as shown.
- 2 You can adjust the handle (17) in three positions: A, B and C as shown:  
A - For carrying and for transport in your car.  
B - For placing your child inside.  
C - For setting the infant carrier down safely outside the car.

## 2. sunhood

The extendable sunhood (14) protects your child's head from sunlight.

- 1 Pull the sunhood (14) to the suitable location as shown.
- 2 Remove sunhood (14).
  - 3 Remove cover directly from plastic front edge.
  - 4 Draw out sunhood (14) strut from black tube on both sides.
  - 5 Detach sunhood (14) from infant carrier.



**TIP!** If you need to clean the sunhood, please pull out the plastic support pipe in the sunhood.

---

Attach sunhood:

Follow the steps to remove sunhood in reverse order.

### 3. securing your baby

- 1 Loosen the shoulder straps (3) by pressing the adjustment button (10) and pull both shoulder straps (3) forwards.
- 2 Press red release button (13) to open the harness buckle (9)  
Move the harness straps to the side to place the child in the seat.
- 3 Bring both buckle tongues (12) together. Lock buckle tongues (12) in harness buckle (9) until they engage with a clicking sound.
- 4 Pull headrest height adjuster (5) from back with your thumb hold the top of the adjuster. Move the headrest (1) freely up and down to find a suitable position and then release the headrest height adjuster (5). Now the headrest is fixed in the position you want.
- 5 Adjust the headrest (1) to proper position. Make sure the distance between child's shoulder and the bottom of the headrest is less than one finger.
- 6 Pull the adjustment strap (11) until the strap lies flat and snug on your child's body. Make sure shoulder straps are slightly higher or equal to child's shoulders.



#### **WARNING!**

Place shoulder straps tight to the child's body.

---

## 4. preparation

- 1 If your vehicle is not fitted with ISOFIX insertion aids (29) as standard, clamp the two ISOFIX insertion aids (29), which are included, with the opening pointing upwards, to the two ISOFIX fastening points (30) of your vehicle. If you don't have ISOFIX insertion aids (29), please ignore this step.



**TIP!** The ISOFIX fastening points (30) are located between the surface and the backrest of the vehicle seat.

---

## 5. installation of the isofix base



### **WARNING!**

Note and follow the vehicle handbook during use, be sure to observe any restrictions relating to airbags.

---

- 1 Pull the support leg (26) away from the bottom of the base of the child safety seat.
- 2 When you hear a clicking sound, the support leg (26) is fully extended.
- 3 Press the ISOFIX buttons (24) to push out the two ISOFIX locking arms (23) from the seat base.
- 4 Push back the base until the base rests firmly against the vehicle seat, then you will hear a clicking sound. Ensure the



ISOFIX indicators turn from red to green safety colour on both sides.

- 5 Press both adjustment buttons (27) and pull out the support leg (26) until it makes firm contact with vehicle floor and the support leg indicators (28) are green as shown, then you will hear a clicking sound.
- 6 Make sure the base is installed well.

## 6. installation of the infant carrier

- 1 Put the infant carrier on the base, insert the metal bars (21) into slot, then you will hear a clicking sound. Ensure that both sides of the base indicators (25) turn from red to green safety colour. Never use the infant carrier facing forwards.



**WARNING! Before each car journey, in order to ensure your child's safety, make sure that...**

- The seat base is fastened in the ISOFIX fastening points (30) on both sides with the ISOFIX locking arms (23) and both ISOFIX buttons (24) are fully green;
- The infant carrier is securely fastened;
- The harness of the infant carrier is fitted snugly to the child's body without being constricting and should not be twisted;

- The shoulder straps (3) are correctly adjusted and the straps are not twisted;
- The shoulder pads (2) are in the correct position on your child's body;
- The infant carrier is facing in the right direction for your child's age/size;
- The buckle tongues (12) are inserted into the harness buckle (9).

## **7. remove from vehicle**

- 1 Pulling the release button (22), remove the infant carrier.
- 2 Tuck your support leg (26) in: Press the adjustment buttons (27) to push back into support leg (26).
- 3 Release ISOFIX button (24) towards each other to loosen the ISOFIX fastening points (30) on both sides. Move the ISOFIX locking arms (23) back into the seat base.
- 4 Remove the base and put the support leg (26) into the base.

## 8. seat cover

Only use authentic seat covers. The seat cover (18) is an integral part of the child safety seat and is key to ensure the trouble-free functionality of the system. Replacement seat covers are available from your retailer.

- 1 Open the harness buckle (9), refer to (3.2) as shown.
- 2 Open the cloth cover. Remove the metal plate from shoulder strap (3).
- 3 Remove shoulder pads (2) and buckle tongues (12). Remove seat cover (18).



**TIP!** Please keep the buckle tongues and metal plate safe for further use.

---



**TIP!** Follow above steps in reverse order with fabric elf (19), which can help you assemble cover more easily.

---



**TIP!** When you use infant carrier, make sure newborn insert sits underneath the shoulder straps. Make sure that the newborn insert is in contact with the backrest of the infant carrier.

---



**WARNING!** Use the newborn insert when your baby is 40-75cm. Remove the newborn insert when your baby is >75cm.

---

## 9. remove harness buckle

- 1 Rotate the metal plate on crotch strap by 90° vertically. Slide the metal plate downward through the harness slot (a) as shown. Pull crotch strap and slide the metal plate by 90° vertically
- 2 upward through the harness slot (b) as shown. Remove harness buckle (9) from base.



### **CAUTION!**

Make sure the metal plate is above slot (a), crotch strap goes through slot (b).

---

To install harness buckle, follow the steps above in reverse order.

## care and maintenance

The cover can be removed and washed with a mild detergent in a washing machine.

The newborn insert (8) can be washed in the same way as the cover. Remove all foam parts from the top and bottom sections before washing. These must not be washed.

The shoulder pads (2) can be removed and washed in lukewarm

soapy water.

The plastic parts and the harnesses can be cleaned with soapy water. Do not use any caustic cleaning agents (such as solvents).



---

**TIP!** Use seat cover fabric elf (19) to assemble cover more easily.

---

## harness buckle

To ensure the safety of your child, it is absolutely essential that the harness buckle continues to function correctly. Harness buckle malfunctions are usually caused by a build-up of soiling or by external objects:

- When you press the red release button (13), it takes a long time for the buckle tongues (12) to be ejected.
- The buckle tongues (12) no longer engage i.e. when you try to push them in, they pop out again).
- The buckle tongues (12) engage without a clicking sound.
- The buckle tongues (12) are difficult to push in (If you feel a

certain amount of resistance).

- The harness buckle (9) only opens if extreme force is applied.

---

Remedy: Soak the harness buckle in warm water containing washing-up liquid for at least an hour. Rinse the buckle thoroughly and dry it.

---

## disposal

Please observe the waste disposal regulations in your country.

Disposal of packaging	Container for cardboard boxes
Seat cover	Residual waste, waste incineration
Plastic parts	To be placed in the corresponding container according to labelling
Metal parts	Container for metals
Belt straps	Container for polyester
Buckle and tongue	Residual waste

## safety notes

---

### notice

---

This is an i-Size Enhanced Child Restraint System. It is approved according to UN Regulation No. 129, for use in, i-Size compatible vehicle seating positions as indicated by vehicle manufacturers in the vehicle user's manual.

If in doubt, consult either the Enhanced Child Restraint System manufacturer or the retailer.

---

### DANGER!

---

Please carefully read and make sure you understand all instructions in this manual and in the vehicle handbook relating to child safety seats. Install and use the child safety seat as described in the instruction manual. Failure to do this could result in serious injury even death of your child. Keep the instructions together with the ECRS for future reference.

---

### DANGER!

---

Because of potential medical issues inherent to low birth weight and premature infants, always have a trained professional doctor or hospital staff assess the suitability of the ECRS prior to leaving the hospital or using the ECRS.

**MAKE SURE** any straps restraining the child are adjusted to the child's body. Make sure straps are not twisted and any support-leg is in contact with the vehicle floor.

**HOT!** The child seat should be kept away from sunlight if the seat is not provided with a textile cover, otherwise it may be too hot for the child's skin.

**DO NOT** leave your child unattended in this restraint even for a short time.

**DO NOT** leave your child unsupervised in the vehicle, for the temperature in a vehicle can rise dangerously quickly. Take breaks and take the child out of the infant carrier as often as possible, if you are on long journeys. It will be good for your child's spine.

**MAKE SURE** any luggage or other objects liable to cause injuries in the event of a collision are properly secured.

**A) DO NOT** use the ECRS without the cover.

**B) DO NOT** replace seat cover with any other than the one recommended by the manufacturer, because the cover constitutes an integral part of the restraint performance.

**ONLY** use rearward facing installation. (refer to instruction)

**MAKE SURE** the rigid items and plastic parts of a ECRS are located and installed so that they are not liable, during everyday use of the vehicle, to become trapped by a movable seat or in a door of the vehicle.



**MAKE SURE** the ECRS is replaced when it has been subject to violent stresses in an accident.

**DO NOT** make any alterations or additions to the ECRS without the approval of the Type Approval Authority, and it may be dangerous if you do not closely follow the installation instructions provided by the ECRS manufacturer.

---

 **WARNING!**

---

The safest place for your baby is the rear of your car. Airbags are designed to protect adults. The use of a front airbag with an infant carrier can lead to fatal injuries.



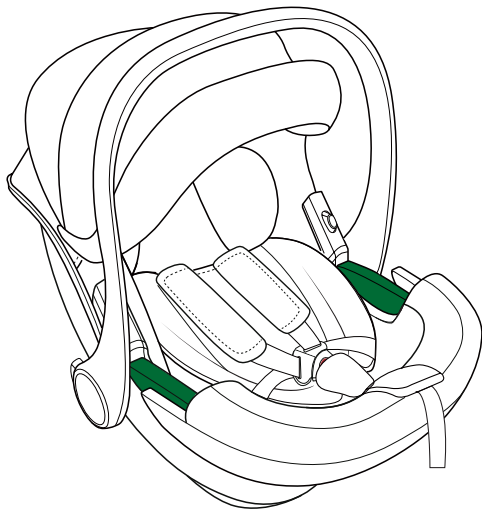

## **secure infant carrier with belt (universal belted)**

If you do not have ISOFIX base, the alpha® infant car seat can be installed by using the 3-point safety belt of your car.

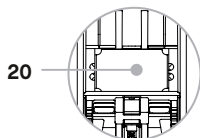
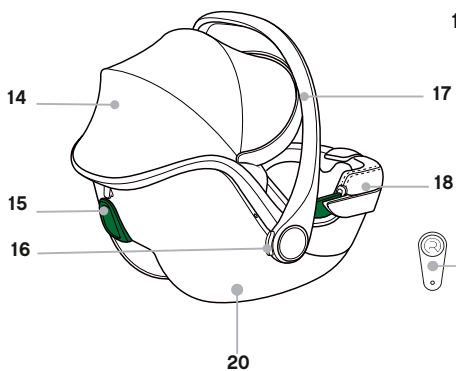
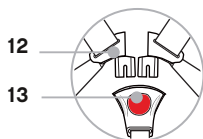
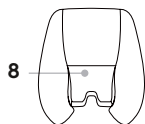
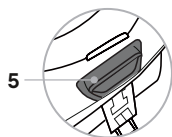
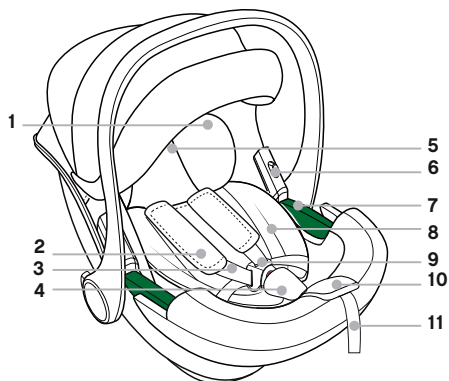

## **warning**

Read the instructions carefully before use and keep for future reference.

1. Headrest
2. Shoulder pads
3. Shoulder straps
4. Crotch pad
5. Headrest Height Adjuster
6. Separate Adapter Buttons  
(optional for stroller)
7. Vehicle Lap Belt Guidance
8. Newborn insert
9. Harness Buckle
10. Adjustment Button
11. Adjustment Strap
12. Buckle Tongues
13. Red Release Button
14. Sunhood
15. Vehicle Diagonal Belt Guidance
16. Swivel Buttons
17. Handle
18. Seat Cover
20. Fabric elf
21. Instruction Storage

1. handle

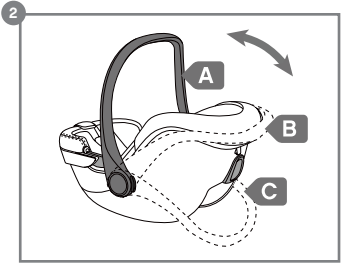
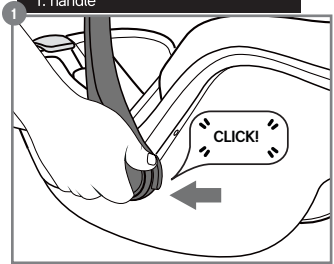

2. securing your baby

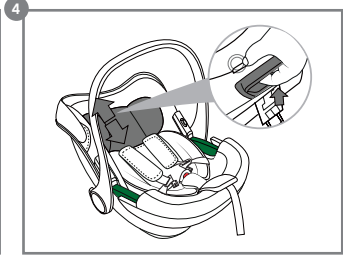
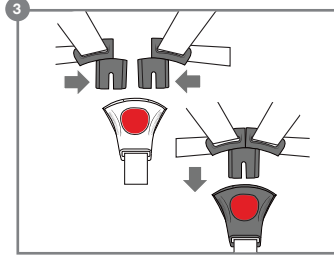
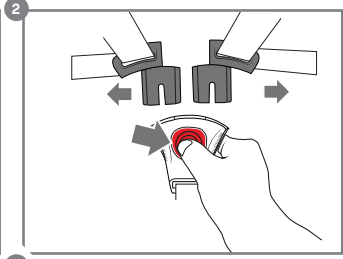
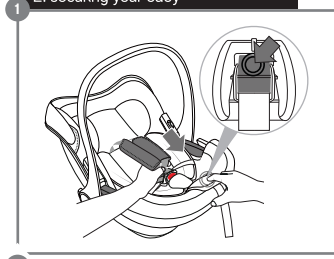

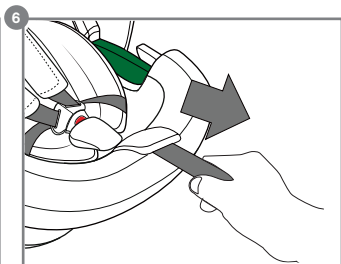
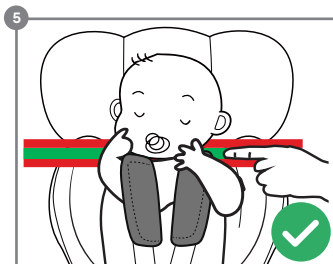

3. installation of the infant carrier

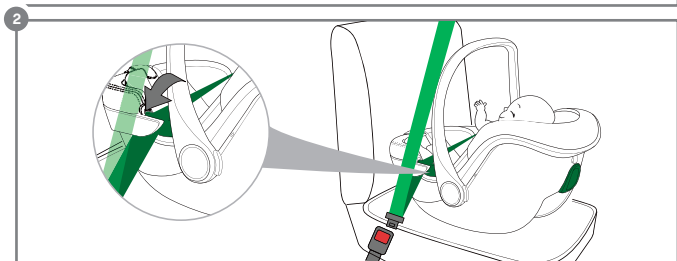
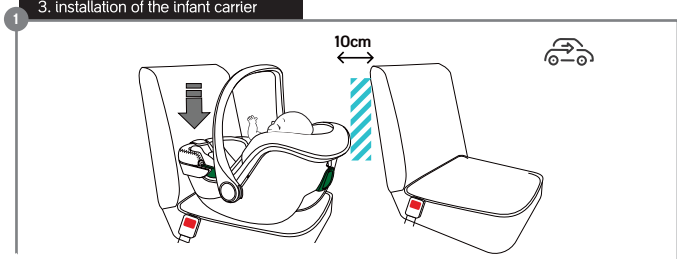

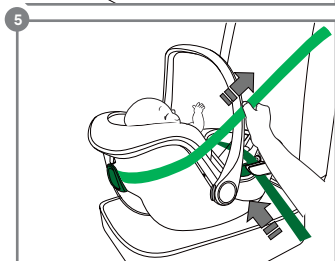
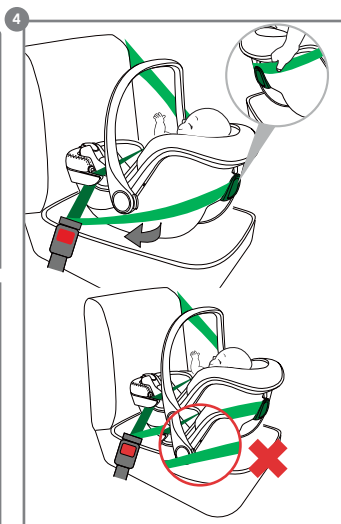
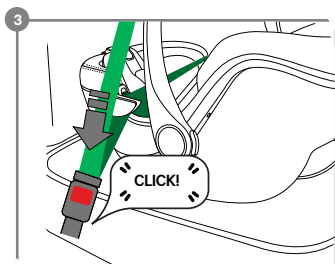







## approval

These instructions use the following symbols:

Symbol	Keyword	Explanation
	<b>DANGER!</b>	RISK of severe personal injury
	<b>WARNING!</b>	RISK of minor personal injury
	<b>CAUTION!</b>	RISK of material damage
	<b>TIP!</b>	Useful notes

The alpha® is exclusively intended to secure your child in your vehicle.

	rear-facing	never use the infant carrier facing forwards.
<b>body height</b>	40 - 87cm	
<b>body weight</b>	maximum 13kg	

This infant carrier has been designed, tested and approved according to the requirements of the European Standard for Child Safety Equipment R129/03. This infant carrier may only be used to secure a child in the vehicle.

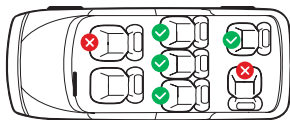
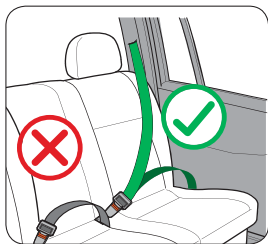

The alpha® ECRS can be installed on ISOFIX base. Please make sure you read the user manual of this base carefully.

This alpha® ECRS is suitable for seat belt models equipped with the 3-point seat belts that has passed the ECE R16 requirement and is not suitable for models only equipped with 2-point seat belts.

## 1. handle

- 1 Hold down both swivel buttons (16). Move handle (17) to desired position, then release swivel buttons (16).  
Ensure that the handle locks (17) with a clicking sound as shown.
- 2 You can adjust the handle (17) in three positions: A, B and C as shown:  
A - For carrying and for transport in your car.  
B - For placing your child inside.  
C - For setting the infant carrier down safely outside the car.

## 2. securing your baby

- 1 Loosen the shoulder straps (3) by pressing the adjustment button (10) and pull both shoulder straps (3) forwards.
- 2 Press red release button (13) to open the harness buckle (9)  
Move the harness straps to the side to place the child in the seat.
- 3 Bring both buckle tongues (12) together. Lock buckle tongues (12) in harness buckle (9) until they engage with a clicking sound.

- 4 Pull headrest height adjuster (5) from back with your thumb hold the top of the adjuster. Move the headrest (1) freely up and down to find a suitable position and then release the headrest height adjuster (5). Now the headrest is fixed in the position you want.
- 5 Adjust the headrest (1) to proper position. Make sure the distance between child's shoulder and the bottom of the headrest is less than one finger.
- 6 Pull the adjustment strap (11) until the strap lies flat and snug on your child's body. Make sure shoulder straps are slightly higher or equal to child's shoulders.



**WARNING!**

Place shoulder straps tight to the child's body.

---

### 3. installation of the infant carrier

Secure infant carrier with belt (Universal Belted)



#### **WARNING!**

Note and follow the vehicle handbook during use, be sure to observe any restrictions relating to airbags.

---



#### **WARNING!**

Never secure the infant carrier with a 2-point seat belt.

---

- 1 Position infant carrier on the car seat facing backwards against the direction of travel. Front seat distance must be more than 10cm as shown.
- 2 Pass the seat belt over the infant carrier. Let the lap belt go through the vehicle lap belt guidance (7) on both sides of the infant carrier edge.
- 3 Lock the tip of the buckle into the vehicle seat buckle with a clicking sound.
- 4 Pull the diagonal belt to the back of the infant carrier. Let the diagonal belt go through the vehicle diagonal belt guidance (15).
- 5 Follow the direction of arrow to tighten diagonal belt and lap belt.



**WARNING!** Before each car journey, in order to ensure your child's safety, make sure that...

- The infant carrier is securely fastened;
- The harness of the infant carrier is fitted snugly to the child's body without being constricted and should not be twisted;
- The shoulder straps (3) are correctly adjusted and the straps are not twisted;
- The shoulder pads (2) are in the correct position on your child's body;
- The infant carrier is facing in the right direction for your child's age/size;
- The buckle tongues (12) are inserted into the harness buckle (9).

## safety notes

---

### notice

---

This is a Universal Belted Enhanced Child Restraint System. It is approved according to UN Regulation No. 129, for use primarily in "Universal seating positions" as indicated by vehicle manufacturers in the vehicle user's manual.

If in doubt, consult either the Enhanced Child Restraint System manufacturer or the retailer.

---

### DANGER!

---

Please carefully read and make sure you understand all instructions in this manual and in the vehicle handbook relating to child safety seats. Install and use the child safety seat as described in the instruction manual. Failure to do this could result in serious injury even death of your child. Keep the instructions together with the ECRS for future reference.

### DANGER!

---

Because of potential medical issues inherent to low birth weight and premature infants, always have a trained professional doctor or hospital staff assess the suitability of the ECRS prior to leaving the hospital or using the ECRS.

**MAKE SURE** any straps holding the ECRS to the vehicle are tight. Any straps restraining the child should be adjusted to the child's body. Make sure the straps are not twisted.

**HOT!** The child seat should be kept away from sunlight if the seat is not provided with a textile cover, otherwise it may be too hot for the child's skin.

**DO NOT** leave your child unattended in this restraint even for a short time.

**DO NOT** leave your child unsupervised in the vehicle, for the temperature in a vehicle can rise dangerously quickly. Take breaks and take the child out of the infant carrier as often as possible, if you are on long journeys. It will be good for your child's spine.

**MAKE SURE** any luggage or other objects liable to cause injuries in the event of a collision are properly secured.

**A) DO NOT** use the ECRS without the cover.

**B) DO NOT** replace seat cover with any other than the one recommended by the manufacturer, because the cover constitutes an integral part of the restraint performance.

**ONLY** use rearward facing installation. (refer to instruction)

**MAKE SURE** the rigid items and plastic parts of a ECRS are located and installed so that they are not liable, during everyday use of the vehicle, to become trapped by a movable seat or in a door of the vehicle.



**MAKE SURE** the ECRS is replaced when it has been subject to violent stresses in an accident.

**DO NOT** make any alterations or additions to the ECRS without the approval of the Type Approval Authority, and it may be dangerous if you do not closely follow the installation instructions provided by the ECRS manufacturer.

---

 **WARNING!**

---

The safest place for your baby is the rear of your car. Airbags are designed to protect adults. The use of a front airbag with an infant carrier can lead to fatal injuries.

© 2023 Phil and Teds Design Limited.

Phil and Teds Design Limited owns the intellectual property rights in the brands, designs and inventions featured in this publication as licensed to Phil and Teds Most Excellent Buggy Company Limited. These include, without limitation, the phil&teds, adapt&survive!, &, INLINE trade marks, product names and INLINE double buggy shape and product names. phil&teds actively pursue people who infringe on its intellectual property.





## AUS/NZL

phil&teds Australasia  
102-112 Daniell Street  
Newtown, Wellington 6021  
New Zealand  
+ 64 4 3800 833

## USA/CAN

phil&teds USA  
323 S. College Avenue  
Fort Collins, CO 80524  
USA  
+1 800 839 4985

## GBR

phil&teds UK  
71-73 Victoria St  
Windsor, Berkshire  
SL4 1EH, United Kingdom  
+44 20 3051 9264

## EUR/FRA

phil&teds Spain  
Calle Linaje, 3  
Malaga 29001,  
Spain  
+34 91 290 14 82

## CHN

phil&teds China  
No.10 East Chuangyeyuan  
Road, Yangzhou  
China  
+86 514 8763 4533