

# Quick Start Guide

## Priming The Cartridges

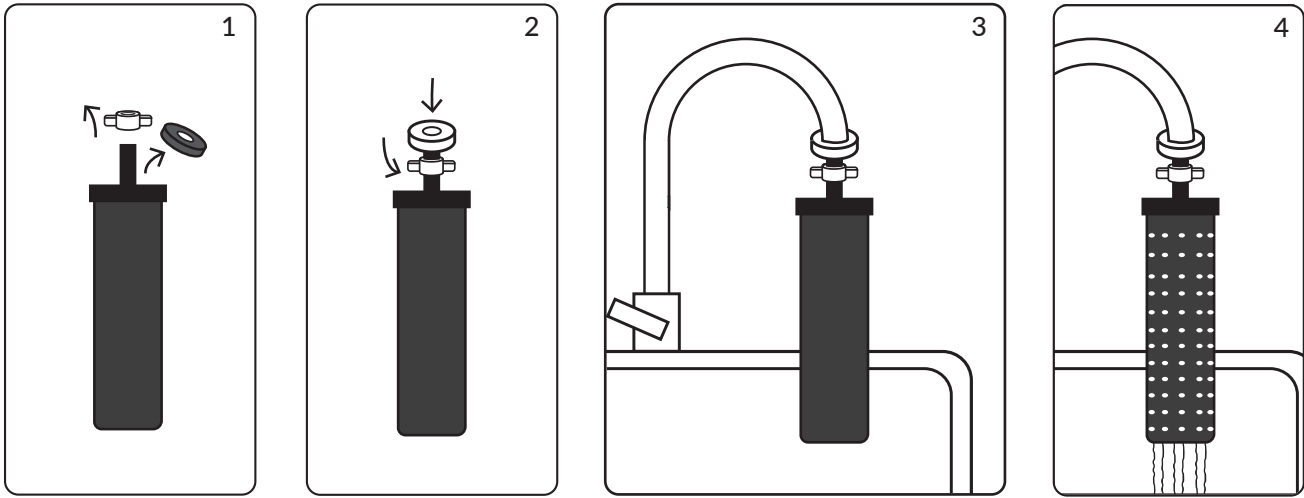

1. Remove both the wingnut and the washer.
2. Insert the wingnut back and screw it down 1/4<sup>th</sup> the way. Make sure there is enough space to insert your fingers under it. Next insert the priming washer to the end of the cartridge. The priming washer should be pushed down only till the beginning of the thread.
3. Hold the cartridge tightly against the faucet. Press the priming washer upwards against the faucet to ensure a tight seal. Use your fingers under wingnut for support if needed.
4. Open the water and let the cartridge flush for 2-3 minutes.

## Assembling The Purifier

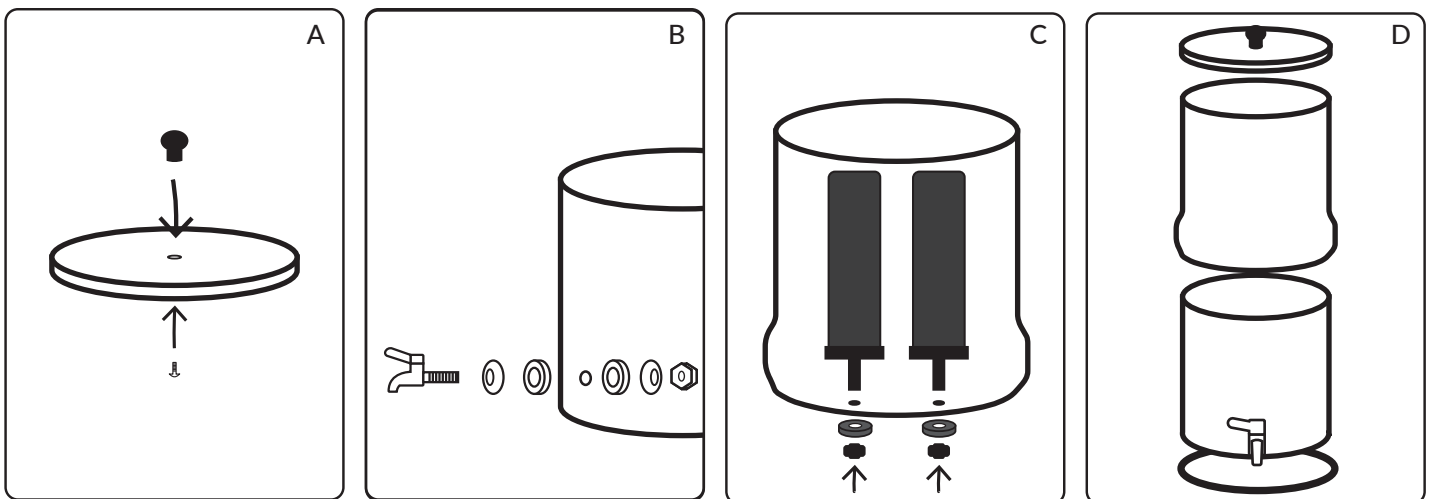

- A. Screw-on the knob to the lid. You will need a screwdriver.
- B. Assemble the tap as shown in the diagram.
- C. Insert the cartridges into the top tank and fasten them using the wingnut.
- D. Place the bottom housing into the rubber base. Place the top tank and lid over it as shown.



Fill the top tank with water and let it drip into the bottom tank. Throw away the first tank of water and don't drink it.