

retrospec

**Breeze** **PLUS**

iSUP Electric Pump



**OWNER'S MANUAL**

## Before You Start

This manual contains safety, assembly, use, and maintenance instructions. Read these instructions carefully before use and keep them for future reference. Do not discard.

---

### **⚠ WARNING**

This manual contains important safety, assembly, use, and maintenance instructions. Read all instructions carefully before using this product and retain this manual for future reference. Failure to follow these instructions may result in injury or damage.

## 1. Introduction

The Retrospec **Breeze Plus Rechargeable Electric Pump** is an intelligent, battery-powered electric air pump designed for inflatable paddleboards and other high-pressure inflatable products. Featuring a preset pressure system with an LCD display, the pump automatically stops inflating once the selected pressure is reached for safe, accurate, and convenient use.

The Breeze Plus also supports deflation, allowing quick air removal for easy folding and storage.

## 2. What's in the box

Please ensure all items are included before use:

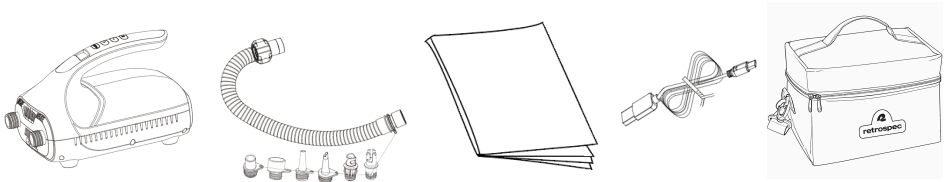

- Breeze Plus Rechargeable Electric Pump
- Carry bag
- Flex hose with fittings
- Valve adapters (multiple sizes)
- Type-C USB charging cable
- Owner's Manual

If any parts are missing, contact Retrospec customer service before use.

# 3. Parts, Features & Controls

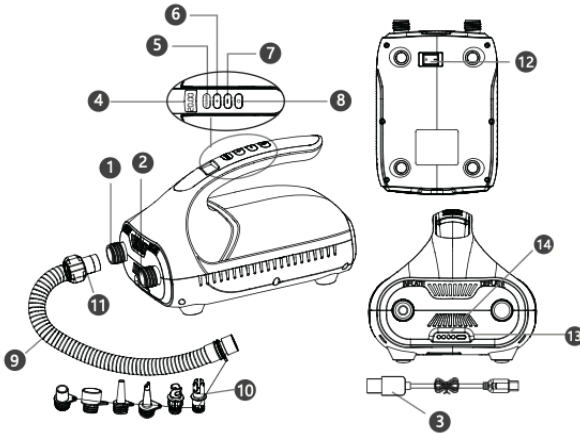

1. Inflation Inlet
2. Deflation Outlet
3. Type-C USB Cable
4. Pressure Value LCD Screen
5. Pressure Unit Toggle Button (PSI / BAR)
6. Pressure Increase Button (+)
7. Pressure Decrease Button (-)
8. On/Off Button
9. Flex Hose
10. Air Valve Adapter
11. Flexible Conduit Adapter
12. Power Switch
13. Type-C USB Charging Port
14. Charging Indicator Light

# 4. Safety Warnings

## WARNING

- Do not expose this product to rain or immerse it in water.
- If you are standing in water or have wet hands, do not plug in or unplug this device.
- Disconnect the charging cable before moving, servicing, cleaning, or adjusting the product.

- If the pump or its power cord is damaged it must be repaired/replaced by the manufacturer, their service agent, or similar authorized personnel. Contact Retrospec customer service.
- Do not use this device for balloons.
- Keep this product away from children.
- To prevent tripping, keep the cord visible and in safe surroundings.
- Always check the maximum allowable pressure of the inflatable product before inflating. Over-inflation may cause damage or injury.
- Use this product only for its intended purpose.
- Do not use in flammable or explosive environments.
- Operate only in ambient temperatures below 104°F (40°C).
- Use only the supplied hose and accessories.
- Inspect hose, connectors, switch, and display before each use.
- Keep away from heat sources, humidity, dust, and direct sunlight.
- Do not throw this product into fire; risk of explosion or battery leakage.
- This product contains a non-user-replaceable rechargeable battery.
- Do not expose the battery to crushing, puncture, or extreme heat.

## 5. Charging Instructions

- Charge using the included **Type-C USB cable** only.
- Supported charging inputs: 5V/1A, 5V/2A, or 12V/1.5A.
- The pump cannot be operated while charging.
- Indicator lights will flash during charging and remain solid when fully charged.
- Recharge the pump at least once every 6 months to maintain battery health.

## 6. Inflation Operation

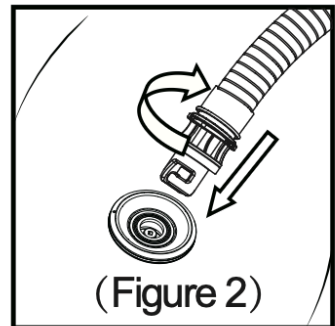
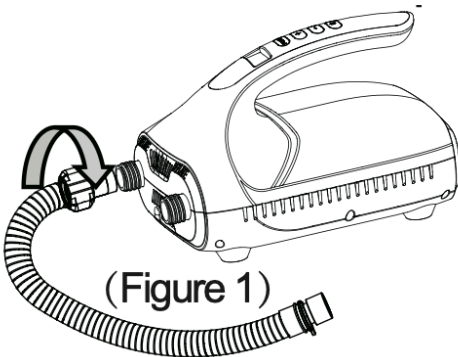

1. Fully charge the Breeze Plus Rechargeable Electric Pump before first use.

2. Attach the flexible conduit adapter to the pump's **Inflation Inlet** and twist clockwise until secure (See Figure 1).
3. Attach the other end of the hose to the inflatable product's air valve and ensure a tight seal (See Figure 2).
4. Turn the **Power Switch** to the ON position (the symbol "-" means "ON", "o" means "OFF").
5. Press the **On/Off Button** to activate the pump.
6. Press the **Pressure Unit Toggle Button** to select PSI or BAR.
7. Use the **Pressure Increase (+)** or **Pressure Decrease (-)** buttons to set the desired pressure (0–20 PSI).
8. Press the **On/Off Button** to start inflation.
9. During inflation, pressure may be adjusted at any time.
10. The pump will automatically stop once the preset pressure is reached.

**Quick Start:** Press and hold the On/Off Button for 3 seconds to immediately start inflation.

**Note:** The factory default pressure is 20 PSI. The pump will display the last-used pressure setting when powered on. Always set the pressure according to the inflatable product recommended PSI. Do not inflate beyond the product's maximum pressure rating.

## 7. Deflation Operation

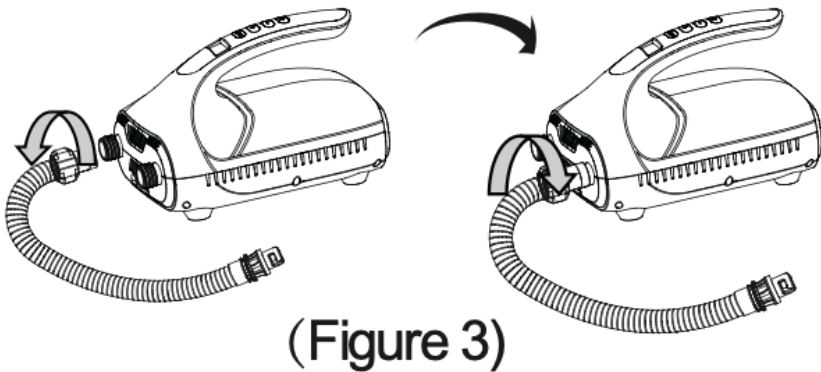

(Figure 3)

1. Remove the hose from the **Inflation Inlet**.
2. Attach the hose to the **Deflation Outlet** and tighten clockwise.
3. Attach the other end to the inflatable product's valve.
4. Press the **On/Off Button** to begin deflation.
5. Once deflation is complete, press the **On/Off Button** to stop and remove the hose.

## 8. Operating Warnings

### WARNING

- Do not block the inflation or deflation outlets.
- Never leave the pump unattended while in use.
- Do not pull or remove the hose while inflating.
- Maximum continuous runtime is 20 minutes. Allow the pump to cool for at least 30 minutes before restarting.
- If any part is damaged, discontinue use and contact authorized service personnel.
- Always face the inflation inlet away from your face and body during operation.
- **Disposal:** This product contains a rechargeable battery and must not be disposed of with household waste. Follow all local electronic waste disposal regulations.

## 9. Troubleshooting

Issue	Inspection	Solution
<b>Pump will not start</b>	Battery low or power off	Charge the pump and ensure it is powered on
<b>Pump stops suddenly</b>	Overheating or overload	Allow pump to cool and restart
<b>Slow or abnormal inflation</b>	Hose blocked or leaking	Clear blockage, replace hose, or reinstall connection
<b>Display shows HOT / E2</b>	Internal temperature $\geq$ 100°C	Allow pump to cool completely
<b>E3 error</b>	Air pressure not increasing	Check for air leaks

If the issue persists, contact Retrospec customer service.

## 10. Storage & Cleaning

- Always power off the pump before storage.
- Allow the pump to cool completely.
- Store in a cool, dry, well-ventilated location.
- Clean with a dry, soft cloth only. Do not use solvents or chemicals.

## 11. Warranty

Retrospec warrants this product against defects in materials and workmanship for **one (1) year** from the date of original purchase. This warranty does not cover damage caused by misuse, unauthorized repairs, or use of non-approved accessories.

For warranty claims or service, contact Retrospec customer support.



# retrospec



## Contact Us

Need some help with your new gear? Just want to say “hey” and talk to someone on our team? We’re here for that too.

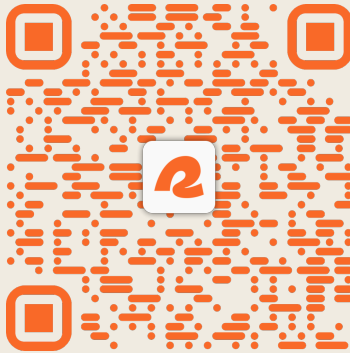

Give us a follow, while you're at it:

@retrospec

#retrospec

#readytooutdoor