

## Pre-rinse Assembly Instructions TP-PR8WDH

Installation should be completed by a licensed plumber who adheres to all industry standards and local plumbing codes.

- Turn off water supply from source.
- Attach faucet body (2) to Nipples (1) and connect to water supply.
  - Note: use plumber's tape (optional) and included washers to seal all connection points.
- Hand tighten the riser bar (3) to the faucet body (2).
- Attach wall support rod (5). The wall support rod should be mounted just below the spring retainer (6). Determine the correct length between the wall and riser (3) and cut the support rod if needed. Drilling into the wall may be required.
- Assemble large coil spring (7) over hose (8) and on to spring retainer (6).
  - Important: Spring must be assembled vertically with large curve of spring to the top.
- Attach the hose grip (9) to the hose assembly (8) to complete the pre-rinse hose assembly.
- Attach the pre-rinse hose assembly (8) to the riser (3), using plumber's tape as required.
- Confirm fitment in place and tighten all connections with a wrench.
- Turn water supply on and ensure there are no leaks.

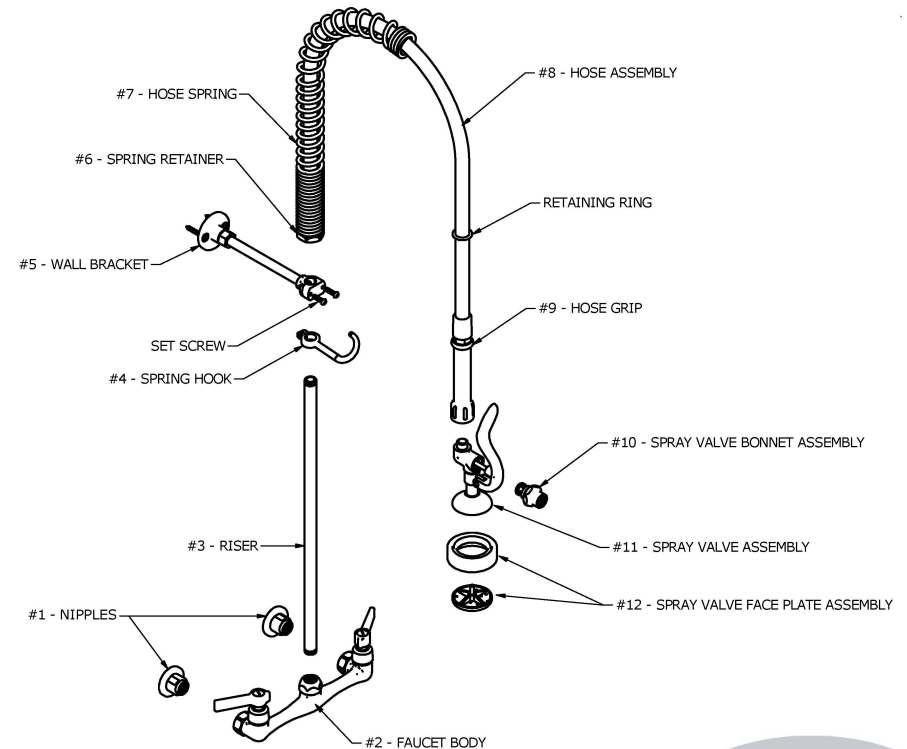

Installation by a licensed plumber is highly recommended.

