

PHILIPS

RO Dispenser

ADD6921

Quick Start Guide & FAQs



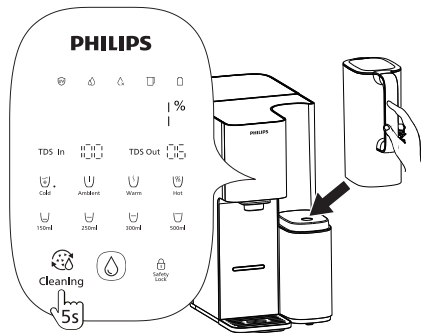

Product setup

1. Rinsing



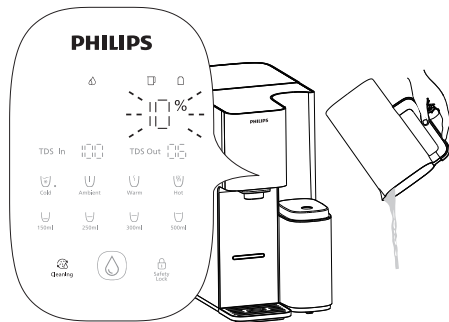

- (1) Fill the tap water tank with tap water, install a filtered water jug, plug in the machine and long press the "  " for 5 seconds.

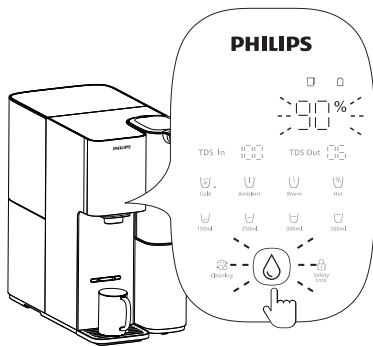

- (2) When the progress percentage is flashing, empty the water from the filtered water jug and then put it back. When "  " is flashing, empty the water from the tap water tank, refill it with tap water up to the "Max" line, and then put it back.

Product setup



(3) When the progress reaches "90%" flashes, there is no need to empty the water. Place a container with volume no less than 2 liters under the water outlet and press "  ". When it shows "100%", it means that the rinsing process completes.

! Please note:

- Please follow the rinsing progress until it reaches "100%". During the rinsing process, in case of special circumstances, you can exit the rinsing program by long-pressing the "  " button for 5 seconds.
- During the first time use, please check if any water leaks from or gathers around the dispenser. If there is any strange noise, burnt smell or smoke coming out from the machine, please disconnect the power cord immediately. Contact customer services if you find any of the situations above.
- During the rinsing process, when air passes through the high-precision filter elements, micro bubbles are generated, causing the water in the filtered water jug appears white and cloudy. This is a normal phenomenon.

Product setup

2. User Interface

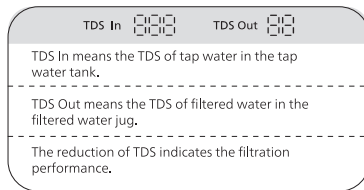
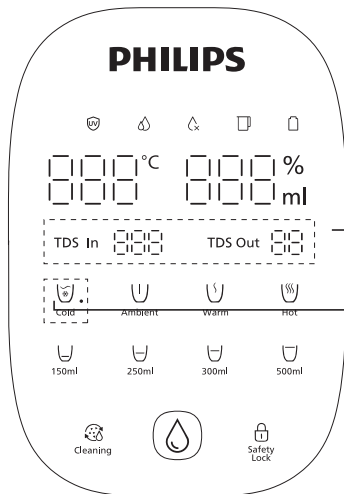

Cold water light		Status
	Light off	Cooling function not activated
	Flashing blue light	Cooling in progress
	Constant blue light	Cooling completed

Product setup

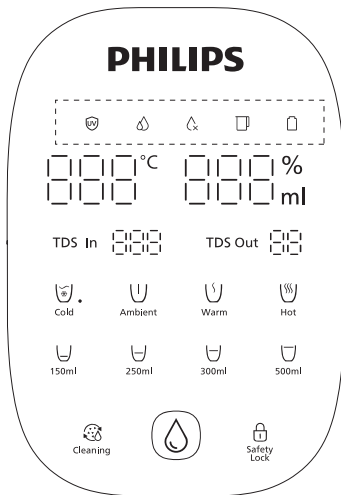

Icon	Status	Meaning
	Constant white light	UV sterilization in progress.
	Constant white light	Filtration process is ongoing, you can still extract water.
	Flashing white light	Filtration process is ongoing, the water level in the filtered water jug is insufficient for extraction.
	Flashing white light	The tap water in the tap water tank has not been replaced for a long time.
	Flashing red light	The tap water in the tap water tank is at a low level or the water quality is poor, please empty the remaining water in the tank and refill it with fresh tap water.
		*When "Tap water" indicator of changing water flashes, the water in the tap water tank needs to be changed. Please discarding the drain water before adding fresh tap water into the tap water tank.
	Constant white light	Filtered water jug is in place.
	Flashing white light	Filtered water jug is not in place. Please put it back.
	Constant white light	More than 10% of the filter cartridge's lifetime remaining.
	Flashing red light	Less than 10% of the filter cartridge's lifetime left. Please replace the filter soon.
	Red light on	Less than 7 days of the filter cartridge's lifetime remaining. Please replace the filter as soon as possible.



Register your product and learn more in the website link below:

<https://www.philips.com>

Specifications are subject to change without notice

© 2023 AquaShield

All rights reserved.

Philips and the Philips Shield Emblem are registered trademarks of Koninklijke Philips N.V. and are used under license.

This product has been manufactured by and is sold under the responsibility of Hong Kong AquaShield Health Technology Company Limited and Hong Kong AquaShield Health Technology Company Limited is the warrantor in relation to this product.

Rev A JUL 23

