

N-Series Permeate Flush Kit

INSTALLATION GUIDE

ENSURE THE WATER SUPPLY TO THE SYSTEM IS TURNED OFF UNTIL INSTALLATION IS COMPLETE



ITEM NUMBER / LETTER	DESCRIPTION
1	SOLENOID AND CHECK VALVE ASSEMBLY
2	ELBOW ASSEMBLY
A	CHECK VALVE TO ELBOW CONNECTION (FEMALE)
B	CHECK VALVE TO ELBOW CONNECTION (MALE, TEFLON WRAPPED)
C	ELBOW TO SYSTEM CONNECTION (MALE, TEFLON WRAPPED)
D	PERMEATE FLUSH PORT
E	PERMEATE SUPPLY (1/2" FNPT)

1. Installation:

- 1.1. Turn off the water supply to the system and disconnect the power.
- 1.2. Locate the permeate flush port on the system.
- 1.3. Remove the plug. Ensure there is no Teflon tape left in the port.
- 1.4. Thread connection point C on the elbow assembly into the connection point D on the system.
- 1.5. Thread connection point A on the solenoid and check valve assembly onto connection point B on the elbow assembly.

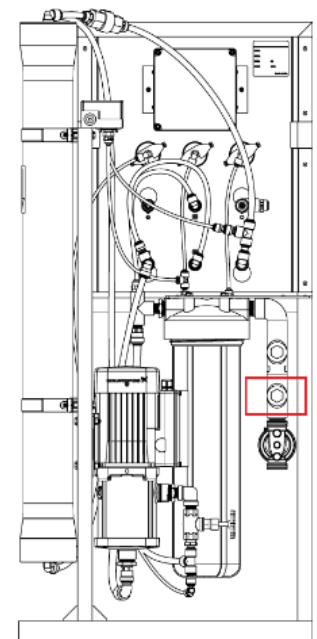
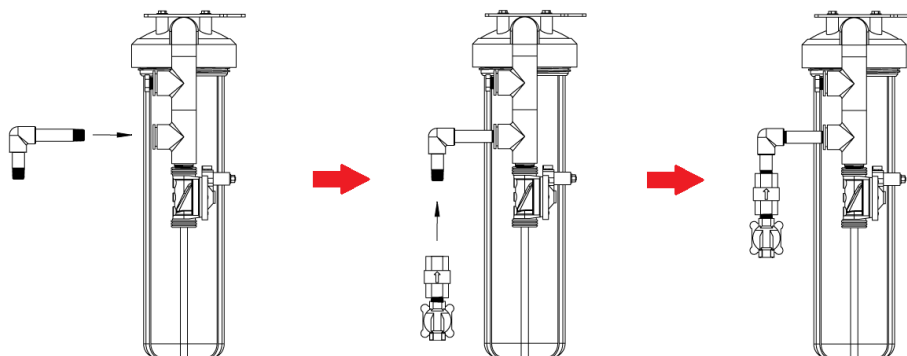

2. Electrical Connection:
 - 2.1. Locate the provided solenoid connection. This will be coiled behind the RO controller.
 - 2.2. Remove the DIN connector cover on the flush solenoid.
 - 2.3. Connect the DIN connector. Secure the connection by tightening the screw.

3. Permeate Water Connection:
 - 3.1. Connect the pressurized permeate supply to the permeate feed (Connection E).

4. Changing the Flush Mode on the Controller:
 - 4.1. Re-connect the power and turn the feed water back on. Press and hold the up and down arrows to access the menu.
 - 4.2. The controller should display “RO Presets Program 4”. Press the “Manual Run / Flush” key.
 - 4.3. Press and hold the up and down arrows on the controller, while holding, press the “Manual Run / Flush” key to access the controller menu. Change to “RO Presets Program 3”. The flush mode has been changed. The standard flush time upon system shut down is 2 minutes.
 - 4.4. To revert to a standard feed flush. Repeat these steps and return to “RO Presets Program 4”.

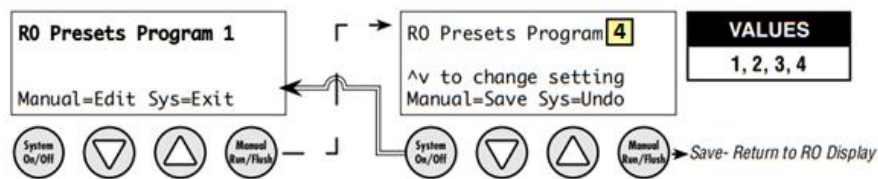
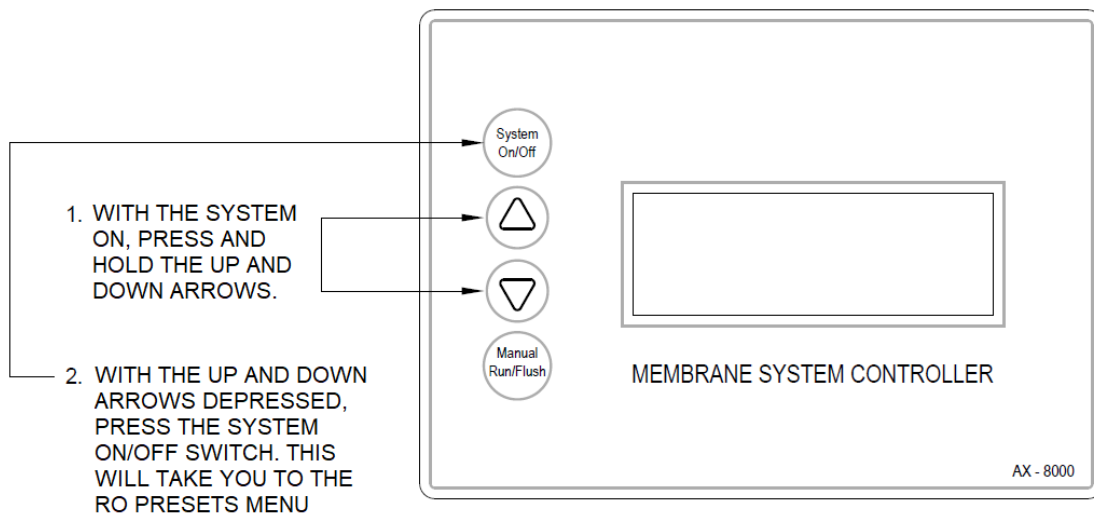

CAREFULLY INSPECT YOUR SYSTEM BEFORE INITIAL START UP. CHECK THAT ALL THE PLUMBING AND ELECTRICAL CONNECTIONS ARE IN PLACE AND SECURELY FASTENED. PLEASE REFER TO THE SYSTEM PURGING / INITIAL START UP SECTION OF YOUR MANUAL PRIOR TO RESTARTING THE SYSTEM.