

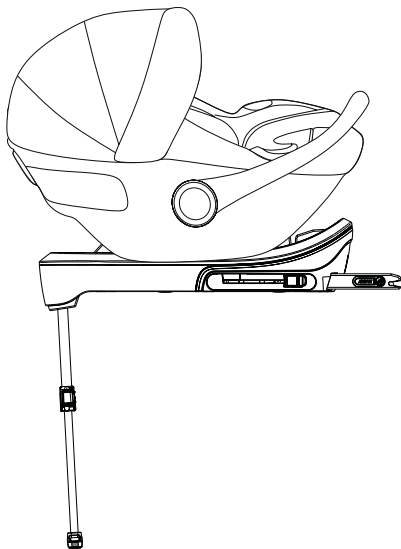

life without limit™



## protect™ i-Size instructions

for detailed instructions please visit:  
[mountainbuggy.com](http://mountainbuggy.com)

## warning

This child safety seat has passed UN Regulation No.129/03.

Please read the full instructions before assembling and using this product.

1. The rigid items and plastic parts of an Enhanced Child Restraint System (ECRS) shall be located and installed so that they are not liable, during everyday use of the vehicle, to become trapped by a movable seat or in a door of the vehicle.
2. Do not use carry-cots perpendicular to the longitudinal axis of the vehicle.
3. Any straps holding the restraint to the vehicle should be tight, any support-leg should be in contact with the vehicle floor, any straps or impact shields restraining the child should be adjusted to the child's body, and straps should not be twisted.
4. It is important to ensure that any lap strap is worn low down.
5. The Enhanced Child Restraint System should be replaced when it has been subject to violent stresses in an accident.
6. It is dangerous to make any alterations or additions to the device without the approval of the Type Approval Authority, and it is also dangerous not following closely the installation instructions provided by the Enhanced Child Restraint System manufacturer.
7. Be sure that children are not left in their ECRS unattended.

8. Any luggage or other objects liable to cause injuries in the event of a collision shall be properly secured.
9. The Enhanced Child Restraint System shall not be used without the cover.
10. The Enhanced Child Restraint System cover should not be replaced with any other than the one recommended by the manufacturer because the cover constitutes an integral part of the restraint performance.
11. Refer to the vehicle manufacturer's handbook for the use of an "i-Size ECRS".

**NOTICE:** This is an i-Size Enhanced Child Restraint System. It is approved according to UN Regulation No.129, for use in, i-Size compatible vehicle seating positions as indicated by vehicle manufacturers in the vehicle users manual.

If in doubt, consult either the Enhanced Child Restraint System manufacturer or the retailer.

Do not use the ECRS in seating positions where there is an active frontal airbag installed.

## **warranty**

All of our products have a one year warranty from date of purchase against defects in material and workmanship.\*

Additionally, when you register your product online within 30 days of purchase, you are eligible for a 2 year warranty free of charge.

Once registered, you can further extend the warranty to 3 years by purchasing an extended warranty within 30 days of purchase.

The warranty period starts from the purchase and is valid for a period of 12 months.

The warranty is only applicable to the original owner and is not transferable. The warranty is only applicable to products which have not been modified by the user. In the case of any defects, the owner is required to return the product to the retailer.

## **no warranty given if:**

There is no purchase receipt.

Defects are caused by misuse or maintenance which differs from that indicated in the instruction manual.

Repairs are carried out by third parties.

Defects are caused by neglect.

5

Damage or removal of any serial number is found.

For normal wear and tear which may be expected in daily use.

The stated warranty terms and conditions have not been satisfied.

Please register your product purchase online now.

\*you may be entitled to other rights in some countries.

# know your infant carrier

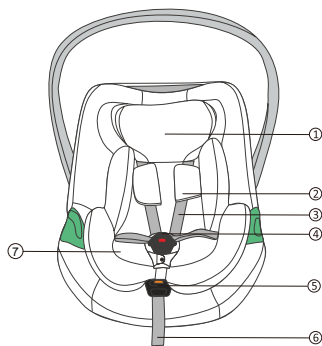

1. headrest
2. shoulder pad
3. shoulder strap
4. harness buckle
5. harness release button
6. harness strap
7. newborn insert

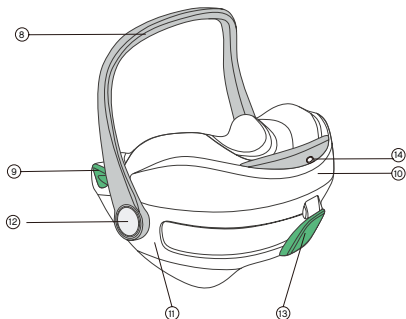

8. handle
9. lap belt guide
10. sunhood plastic cover
11. seat shell
12. handle adjuster
13. diagonal belt guider
14. headrest adjuster

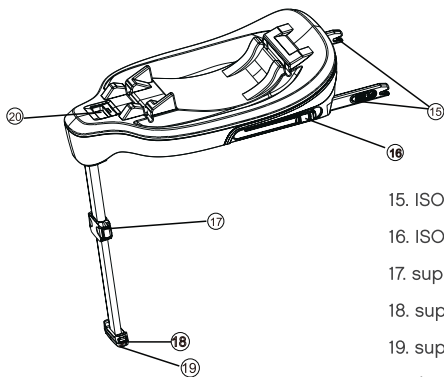

- 15. ISOFIX connector
- 16. ISOFIX Release button
- 17. support leg adjusting button
- 18. support leg block
- 19. support leg indicator
- 20. base unlocking handle

# 1. certification



...as a child safety seat installed in a vehicle

protect™ base child safety seat	tested and certified according to ECE*R129	
	applicable size range	body weight
<b>protect™</b>	height from 40cm to 87cm	up to 13kg

\*ECE = European Standard for Safety Equipment

The child safety seat has been designed, tested and certified according to the requirements of the European Standard for Child Safety Equipment (ECE R129).

The seal of approval E (in a circle) and the approval number are located on the approval label (sticker on the child safety seat).

This approval will be invalidated if you make any modifications to the child safety seat. Only the manufacturer is permitted to make modifications to the child safety seat.



## 2. use in the vehicle

### Warning:

Never use this child restraint system in seating positions where an active airbag is installed. An active frontal airbag may cause death or serious injury of your child in an accident. Please read the instructions carefully and keep safely for future reference. There is an instruction compartment in the back of the child car seat for storage of the instruction manual.

**You can use your child car seat as follows:**

9

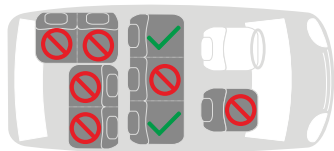
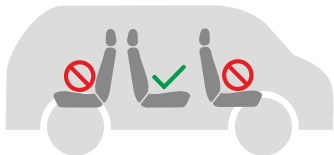

## 3. securing your baby

### 3.1 securing your baby using the newborn insert



#### for the protection of your baby

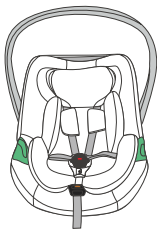

The newborn insert gives your baby the necessary support while he or she is still small. The newborn insert is used to provide extra comfort for very small babies.

**Caution!** Please use the newborn insert attached to this infant carrier when your baby's height is less than 75cm

- Always secure your baby in the infant carrier using the harness.
- Never leave your baby unattended in the infant carrier when placing it on elevated surfaces (e.g. a table, nappy changing unit, etc.).
- Never allow the strap end to become caught in moving parts (e.g. automatic doors, escalators, etc.).
- Caution! The plastic parts of the infant carrier heat up in the sun,

so that your baby may get burnt. Protect your baby and the infant carrier against intensive solar radiation (e.g. by putting a light cloth over the seat).

- The infant carrier requires only one seating position in the car. This advantage means, however, that your baby must be in a semi-reclined position.
- Take your baby out of the infant carrier as often as possible to relieve its spine. We recommend frequent breaks during long journeys. Even outside of the car, please avoid leaving your baby in the infant carrier for too long.

### 3.2 adjusting the handle

You can engage the adjuster in four positions

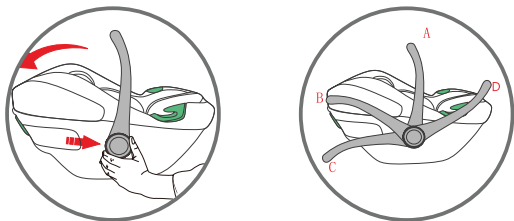

Simultaneously press both buttons on the handle. Then whilst holding the adjustor pressed turn the handle backwards until it engages in the desired position.

- A.** Only available for carrying, can not be used when installing on the vehicle seat. Caution! Ensure that the handle is securely engaged before you pick up the infant carrier.
- B.** For placing your baby into the infant carrier. Tip! You can move the handle from one position to another by pushing a button.
- C.** For setting the infant carrier down safely outside the car.
- D.** For use when installing on the vehicle seat.

### **3.3 adjusting the headrest**

**A correctly adjusted headrest ensures your baby's optimal posture in the infant carrier.**

The headrest must be adjusted so that the shoulder straps are at the same level as your baby's shoulders or slightly above.

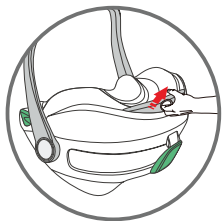

**To adjust the height of the headrest to fit your baby:**

Tilt the headrest adjuster until it disengages. Slide the headrest adjuster until the shoulder straps are at the correct height and re-engage.

**3.4 loosening the shoulder straps**

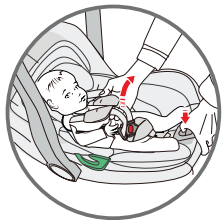

Press the harness release button and at the same time pull both shoulder straps forward.

### 3.5 securing your baby using the harness

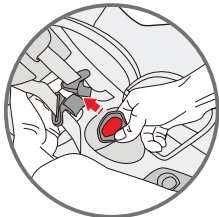
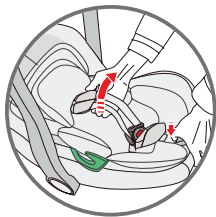

- Loosen the shoulder straps.
- Open the harness buckle (press the red release button).

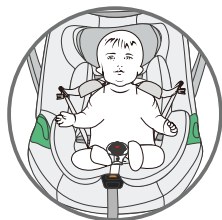

- Place your baby into the infant carrier.
- Put the shoulder straps over the shoulders of your baby, then put the buckle tongues together and engage in the harness buckle with an audible "click".

**Caution!** Do not twist or interchange the shoulder straps.

### 3.6 tightening the harness



Pull the strap end

**Caution!** Pull the strap end straight towards you, not upwards or downwards. Please pay attention to the strap end. Whilst travelling (especially outside the car) it should always be attached to the cover.

### 3.7 checklist to ensure that your baby is buckled up correctly



**For the safety of your baby, please check that...**

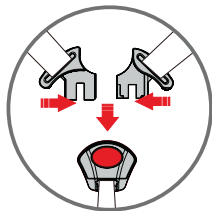

- The shoulder straps of the infant carrier are comfortable but **FIRM** fit around your child.
- The shoulder straps are adjusted correctly.
- The shoulder straps are not twisted.
- The buckle tongues are engaged in the harness buckle.

## 4. installation in the vehicle



**Please do not leave your child unattended in the child safety seat in the vehicle.**



**For the protection of all vehicle occupants**

In the case of an emergency stop or an accident, unsecured persons or objects may cause injury to other vehicle occupants. Please always check that...

- The backrests of the vehicle seats are locked (i.e. that a foldable rear seat bench latch is engaged).
- All heavy or sharp-edged objects in the vehicle (e.g. on the parcel shelf) are secured.
- All persons in the vehicle have their seat belts fastened.
- The child safety seat is always secured when it is in the vehicle, even if no child is being transported.

### **To protect your vehicle**

Some vehicle seat covers of sensitive materials (e.g. velour, leather, etc.) may develop wear marks when child seats are used. This can be avoided by placing a blanket or towel under the child seat.





The newborn insert is only suitable for infants from 40 to 75CM in height. If your child is taller than 75CM, please take out the newborn insert

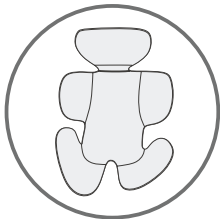

## 4.1 installation instructions for stature 40-87cm, rearward facing, ISOFIX + support leg + harness

### Method 1

First install the base on the seat, then put the infant carrier into the base.

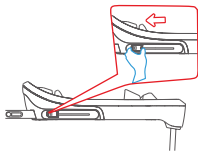
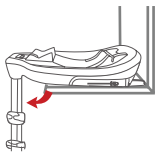

Unfold support leg until it locks in place. Press the ISOFIX release button to slide the ISOFIX connectors to the end.

**Caution:** Please only move to next step when ISOFIX has been slid to the end and the red marks have appeared.

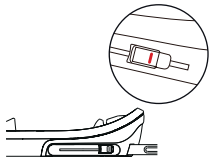

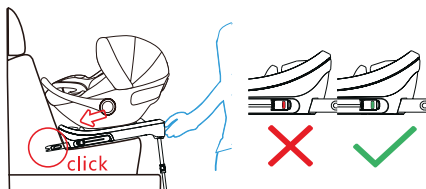

Push the ISOFIX connectors directly into the anchorages until you hear an audible "click" sound. Grasp the seat base to check if the seat is fastened tightly or shakes, meanwhile observe the ISOFIX red/green indicator. If the seat shakes and the ISOFIX connectors are pulled out, please repeat the above steps and install it again.

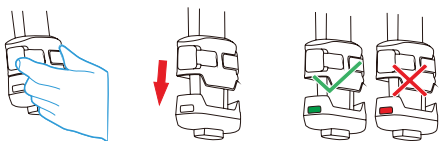

Squeeze the support leg adjusting button, pull out the support leg until it rests firmly on the floor. Observe the ISOFIX red/green indicator to confirm the installation status.



Match the infant carrier with the base, press down on the front and back until there are two "click" sounds. Make sure it is connected correctly by gently shaking and lifting the infant carrier. Ensure that the handle is in its upper position D.

## Method 2

First install infant carrier into the base, and then install both on the seat.

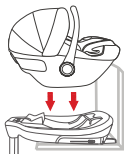

Put the infant carrier into the base.

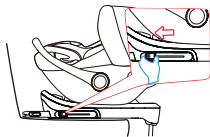

Unfold support leg until it locks in place. Press the ISOFIX release button to slide the ISOFIX connectors to the end.

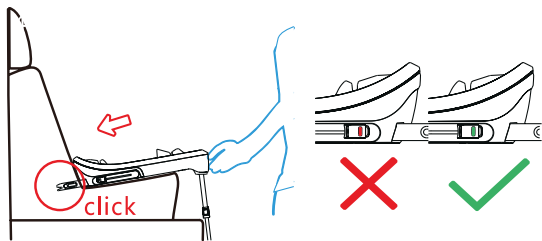

Push the ISOFIX connectors directly into the anchorages until you hear an audible "click" sound. Grasp the seat base to check if the seat is fastened tightly or shakes, meanwhile observe the ISOFIX red/green indicator. If the seat shakes and the ISOFIX connectors are pulled out, please repeat the above steps and install it again.

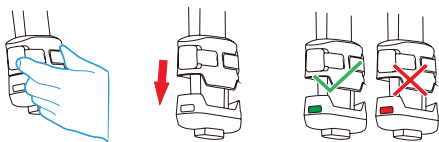

Squeeze the support leg adjusting button, pull out the support leg until it rests firmly on the floor. Observe the ISOFIX red/green indicator to confirm the installation status.

## 5. removing from the vehicle

### Method 1

First remove the infant carrier from the base, then remove the base.

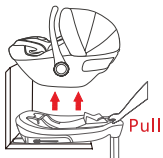

Pull the handle on the base to unlock.

Remove the infant carrier from the base.

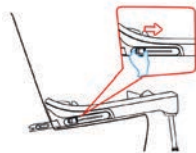

Press the ISOFIX release button to slide the ISOFIX connectors to separate the base and the seat.

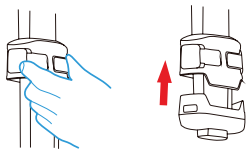

Squeeze the support leg adjusting button to retract the support leg.

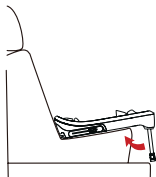

Finally, rotate the support leg and insert it into the slot at the bottom of the seat.

## Method 2

First remove the infant carrier and the base from the seat together.

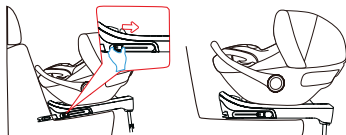

Press the ISOFIX release button to slide the ISOFIX connectors to separate the base and the seat.

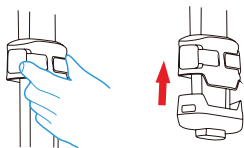

Squeeze the support leg adjusting button to retract the support leg.

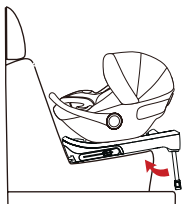

Finally, rotate the support leg and insert it into the slot at the bottom of the seat

## 6. fitting the sunhood

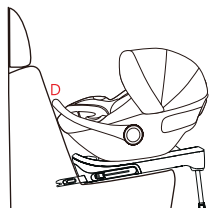

Ensure that the handle is in its upper position D.

### 6.1 pull the plastic cover to extend/fold the sunhood

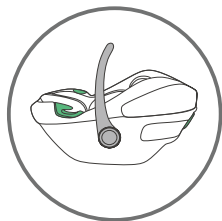

**folded**

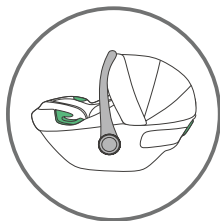

**extended**

## 7. separate blackout cover



### **Warning:**

Use only under parent supervision.

Monitor child to avoid overheating, especially in sunny weather and when using in the vehicle.



## 8. care instructions



### To retain the protective effect

- In an accident at a collision speed above 10 km/h the child safety seat could suffer damage which is not necessarily obvious.
- In such cases it is extremely important that you replace the child seat. Please dispose of it properly.
- Regularly check all important parts for damage.
- Ensure the correct operation of all mechanical components.
- To prevent damage or breakage, ensure that the child seat does not become jammed in the car door, seat runners, etc.
- Should the child seat be damaged (for example after dropping it) it must be inspected by the manufacturer.

### 8.1 care for the harness buckle

The function of the harness buckle is important for the safety of your child. Malfunctions of the harness buckle are mostly attributable to accumulation of dirt and dust.

## 8.2 method of cleaning fabric cover

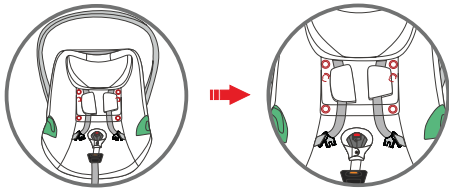
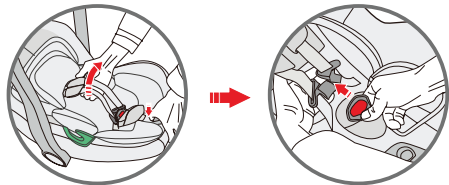
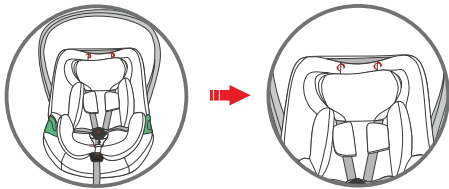
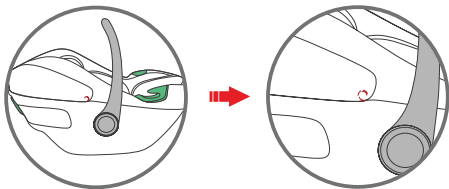

1. Undo the snaps on the side part of the cover.
2. Undo the snaps on the main cover.
3. Press the harness release button and at the same time pull both shoulder straps forward.
4. Undo the snaps on the main cover and remove the shoulder pads.
5. Take off the fabric cover and wash it.

### 8.3 refitting the cover

To refit the cover on the seat please follow the above steps in reverse.

### 8.4 cleaning

Please be sure to use only original replacement seat covers, as the seat cover is important to the proper functioning of the system. Replacement seat covers are available from your retailer.



**The child seat must not be used without the seat cover.**

- The **cover** can be removed and washed with a mild detergent using the delicate cycle on the washing machine (30°C). Please observe the instructions on the washing label of the cover. The colours of the cover may fade if washed at more than 30°C. Do not spin, wring or iron and never tumble dry in an clothes dryer (the fabric may separate from the padding).
- The **plastic parts** can be cleaned using soapy water. **Do not** use harsh cleaning agents (such as solvents).
- The harness can be removed and washed in lukewarm soapy water.

**Caution!** Never remove the buckle tongues from the straps.

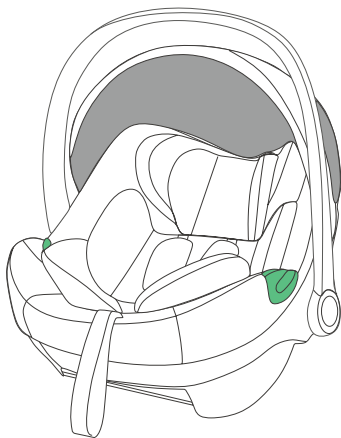

**protect™ installing without base, using belt.**

This child safety seat has passed UN Regulation No. 129/03. Please read the full instructions before assembling and using this product.

## **notice**

This is Universal Belted Enhanced Child Restraint System. It is approved according to UN Regulation No. 129, for use primarily in "Universal seating positions" as indicated by vehicle manufacturers in the vehicle user's manual.

If in doubt, consult either the Enhanced Child Restraint System manufacturer or the retailer.

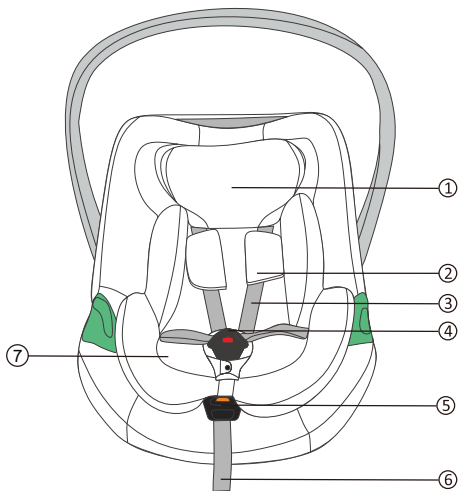

1. headrest
2. shoulder pad
3. shoulder strap
4. harness buckle
5. harness release button
6. harness strap
7. newborn insert

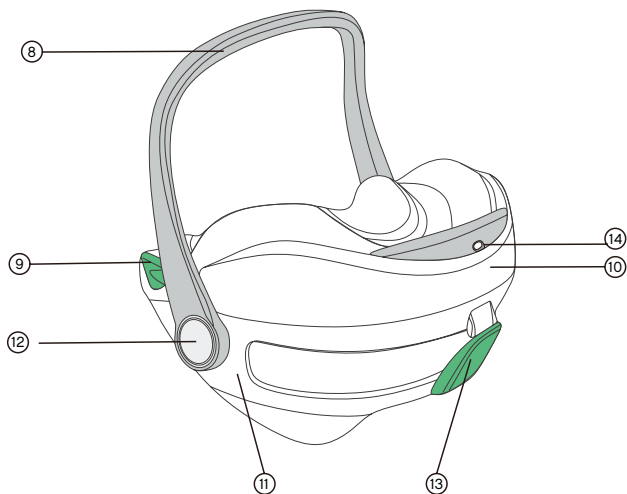

8. handle

9. lap belt guide

10. sunhood plastic cover

11. seat shell

12. handle adjuster

13. diagonal belt guider

14. headrest adjuster



## 1. use in the vehicle



**DO NOT use on a passenger seat with a front airbag!**

**Danger!** An airbag hitting the infant carrier can cause serious injuries to your child, possibly resulting in death. Please observe the instructions in your vehicle manual for the use of child seats.

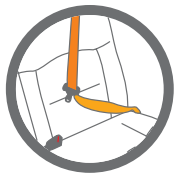

**DO NOT use with 2-point belt.**

**Use only with the vehicle's 3 point seatbel**

Please observe the regulations applicable to your particular country. Do not use with 2-point belt. The safety belt must be approved to ECE R 16 or a comparable standard.

Do not use on passenger seats with a front airbag! Can be used if the vehicle seat is equipped with a 3-point belt.

## with the vehicle's 3-point seatbelt

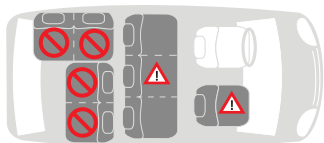

### You can use your child car seat as follows:

in the direction of travel	no
against the direction of travel	yes
with 2-point belt	no 1)
with 3-point belt	yes 2)
on front passenger seat	yes 3)
on outer rear seat	yes
on centre rear seat	no 4)

(Please observe the regulations applicable to your particular country).

- 1) The use of a 2-point belt substantially increases the risk of injury to your child in the event of an accident.
- 2) The safety belt must be approved to ECR R 16 or a comparable standard (see test label on belt with an "E" or "e" in a circle).
- 3) Do not use on passenger seats with front airbag!
- 4) Can be used if the vehicle seat is equipped with a 3-point belt.

## 2. adjusting the headrest

**A correctly adjusted headrest ensures your baby's optimal posture in the infant carrier.**

The headrest must be adjusted so that the shoulder straps are at the same level as your baby's shoulders or slightly above.

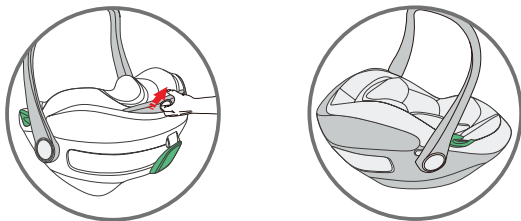

### To adjust the height of the headrest to fit your baby:

Tilt the headrest adjuster until it disengages.

Slide the headrest adjuster until the shoulder straps are at the correct height and re-engage.

## 3. loosening the shoulder straps

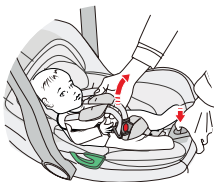

Press the harness release button and at the same time pull both shoulder straps forward.

## 4. securing your baby using the harness

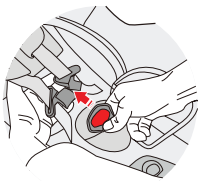
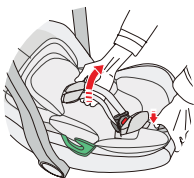

- Loosen the shoulder straps
- Open the harness buckle (press the red release button)

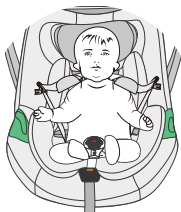

- Place your baby into the infant carrier.
- Put the shoulder straps over the shoulders of your baby, then put the buckle tongues together and engage in the harness buckle with a "click" sound.

**Caution!** Do not twist or interchange the shoulder straps.

## 5. tightening the harness

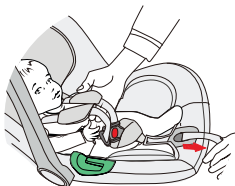

Pull the strap end.

**Caution!** Pull the strap end straight towards you, not upwards or downwards. Please pay attention to the strap end.

Whilst travelling (especially outside the car) it should always be attached to the cover.

## 6. checklist to ensure that your baby is buckled up correctly



**For the safety of your baby, please check that...**

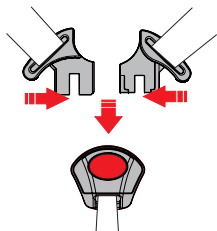

The shoulder straps of the infant carrier are comfortable but **FIRM** fit around your child.  
The shoulder straps are adjusted correctly.  
The shoulder straps are not twisted.  
The buckle tongues are engaged in the harness buckle.

## 7. installation in the vehicle



**Please do not leave your child unattended in the child safety seat in the vehicle.**



**For the protection of all vehicle occupants**

In the case of an emergency stop or an accident, unsecured persons or objects may cause injury to other vehicle occupants. Please always check that...

- The backrests of the vehicle seats are locked (i.e that a foldable rear seat bench latch is engaged).
- All heavy or sharp-edged objects in the vehicle (e.g on the parcel shelf) are secured.
- All persons in the vehicle have their seatbelts fastened.
- The child safety seat is always secured when it is in the vehicle, even if no child is being transported.

### **To protect your vehicle**

Some vehicle seat covers of sensitive materials (e.g velour, leather, etc.) may develop wear marks when child seats are used. This can be avoided by placing a blanket or towel under the child.

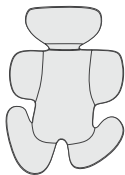

The newborn insert is only suitable for infants with height from 40 to 75CM. If your child is taller than 75CM, please take out the newborn insert.

## 8. securing the infant carrier in your vehicle

To secure the infant carrier using the 3-point belt of your vehicle proceed as follows:

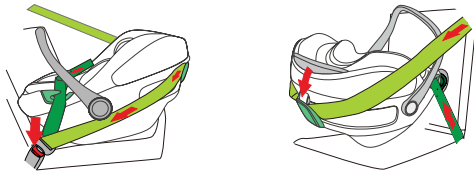

Place the infant carrier rearward-facing on the vehicle seat (baby is facing backwards).

**TIP!** In certain cases it is possible that the infant carrier does not rest securely or is inclined too steeply on the vehicle seat.

- Ensure that the handle is in its upper position D.  
Pull out the vehicle seat belt and place it across the infant carrier.
- Engage the buckle tongue in the vehicle seat buckle.
- Place the lap belt section in the green belt guides on both sides of the infant carrier.



**Caution!** Do not twist the belt.

Tighten the lap belt section by pulling the diagonal belt section. Pull the diagonal seat belt section behind the top end of the infant carrier.

## 9. checklist for the correct installation of the infant carrier in your car



**For the safety of your baby, please check that...**

- The infant carrier is installed rearward-facing.
- The infant carrier is only installed on the front passenger seat if no front airbag can strike the infant carrier.
- The infant carrier is only secured using 3-point belt.
- The lap belt section runs through both green belt guides on the infant carrier.
- The diagonal belt section runs through the light green belt guides on the infant carrier.
- The vehicle belt is tightened up and not twisted.



© 2023 Phil and Teds Design Limited.

Phil and Teds Design Limited owns the intellectual property rights in the brands, designs and inventions featured in this publication as licensed to Phil and Teds Most Excellent Buggy Company Limited. These include, without limitation, the Mountain Buggy, life without limit trade marks and product names. Phil and Teds actively pursue people who infringe on its intellectual property.





life without limit™

## **AUS/NZL**

Mountain Buggy Australasia  
102-112 Daniell Street  
Newtown, Wellington 6021  
New Zealand  
+64 4 3800 833

## **USA/CAN**

Mountain Buggy USA  
323 S. College Avenue  
Fort Collins, CO 80524  
USA  
+1 800 839 4985

## **GBR**

Mountain Buggy UK  
71-73 Victoria St  
Windsor, Berkshire  
SL4 1EH, United Kingdom  
+44 20 3051 9264

## **EUR/FRA**

Mountain Buggy Spain  
Calle Linaje, 3  
Malaga 29001,  
Spain  
+34 91 290 14 82

## **CHN**

Mountain Buggy China  
No.10 East Chuangyeyuan  
Road, Yangzhou  
China  
+86 514 8763 4533

Designed in New Zealand. Made in China  
Conçu en Nouvelle-Zélande. Fabriqué en Chine

Conforme aux exigences de sécurité

8500-02