

Arame Wall Light Installation Instructions

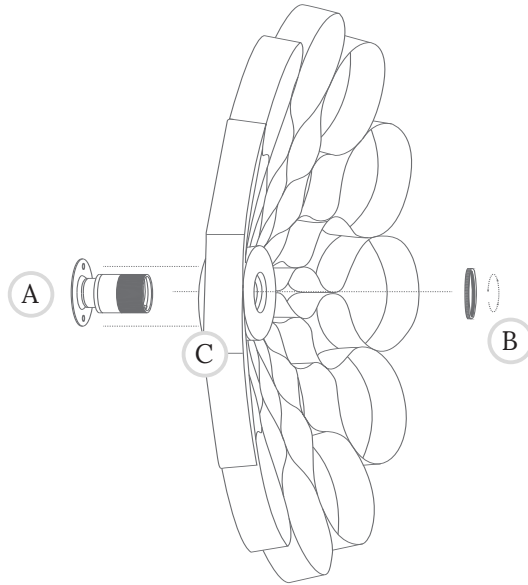

Only qualified persons should assemble the luminaire. If in doubt, consult a suitably qualified person. Installation MUST be carried out in accordance and compliance with current building regulations.

Ensure the electrical supply is turned OFF at the fuse board.

1. Identify if there are any hidden pipes or electrical cables in the wall to avoid causing damage or risk of electrical shock during installation. Connect the lamp holder (A) to the electricity supply (**220-240V AC 50-60Hz**) by unscrewing the threaded collar and connect the supply wires to the screw terminals on the ceramic connector. Replace the threaded collar. These ES lamp holders are constructed in such a manner that they lock together when fully tightened. To release in this situation depress the outside tongue of the central strip contact. During assembly ensure that the interior earth tag is aligned with notches on the brass body.
2. Determine the fixing method appropriate to the wall structure and secure the back plate of the brass lamp holder to the wall using the brass dome slot head screws provided. (A)
3. Undo the shade ring (B) and fit the Arame Wall Light shade (C) onto the brass lamp holder. Ensure the shade is flush against the wall and secure in place by replacing the shade ring.
4. Screw in the light bulb included. The lampshade has been designed to work with an **E27 LED** light bulb, up to a maximum of **25 Watts**.
5. Turn the power supply on to complete installation.