



# PL-FC3118WS

*Farmhouse Series*  
Fireclay Sink

## Features

- Single Bowl
- Nonporous Gloss - Hygienic
- Graduated Ledge for Accessory Placement
- Includes a Custom Wood Cutting Board, Roll-Out Drying Rack, Bottom Grid, and Stainless Steel Strainer

## Material

- Clay and Various Minerals

## Installation

- Apron Front, Undermount



## Available Color/Finishes

Intended for reference only

Color	Description
<input type="checkbox"/>	White
<input type="checkbox"/>	Matte Grey
<input type="checkbox"/>	Matte Grey

6140 Ulmerton Road Clearwater, FL 33760

Phone: (727) 388-9895

Fax: (727) 362-1281

For the most current Specification Sheet, go to [www.buildpelican.com](http://www.buildpelican.com)





# PL-FC3118WS

Farmhouse Series  
Fireclay Sink

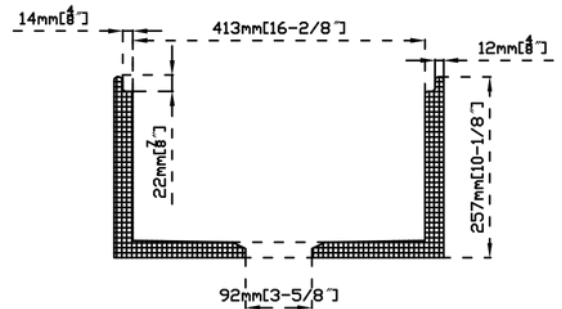
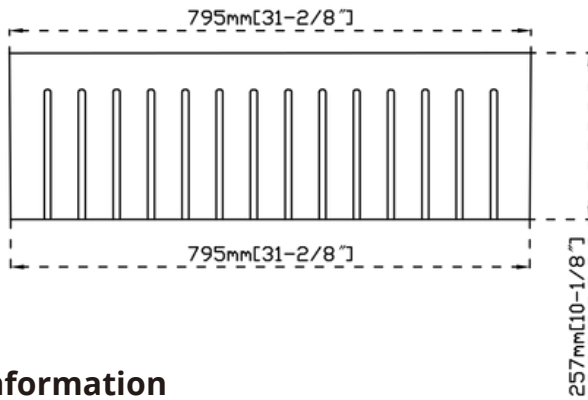
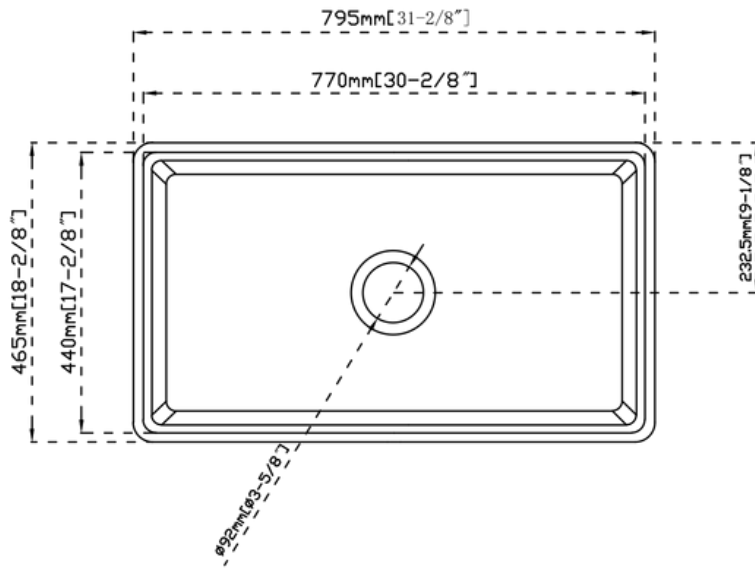

### Technical Information

All product dimensions are nominal  
 Exterior Measurements: 31 2/8" x 18 2/8" x 10 1/8"  
 Interior Measurements: 30 2/8" x 17 2/8" x 10 1/8"  
 Bowl Configuration: Single

### Installation Information

Pelican recommends Fireclay sinks be installed by a professional, experienced installer.

### Limited Lifetime Warranty

See website for detailed warranty information.

### JOB INFORMATION

JOB NAME: \_\_\_\_\_ MODEL SPECIFIED: \_\_\_\_\_ QUANTITY: \_\_\_\_\_  
 DATE: \_\_\_\_\_ ARCHITECT/ENGINEER: \_\_\_\_\_  
 CUSTOMER: \_\_\_\_\_ CONTRACTOR: \_\_\_\_\_

6140 Ulmerton Road Clearwater, FL 33760  
 Phone: (727) 388-9895  
 Fax: (727) 362-1281

For the most current Specification Sheet, go to [www.buildpelican.com](http://www.buildpelican.com)

