

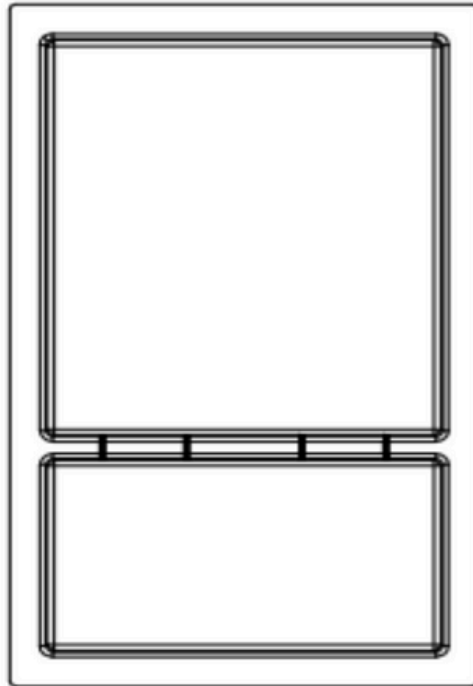

INSTALLATION INSTRUCTIONS

SHOWER NICHE



IMPORTANT

- Prior to commencing installation please carefully read this installation guide in full. Determine the desired configuration before starting any installation work.
- Carefully open the packaging. Take care when you unpack the product and make sure that you do not inadvertently damage or discard any parts.
- Follow the other manufacturer's safety instructions when you use any silicone sealant or degreasing agents, floor tanking systems or wet room membrane installations.
- All joints between the niche and walls must be waterproofed

INSTALLATION

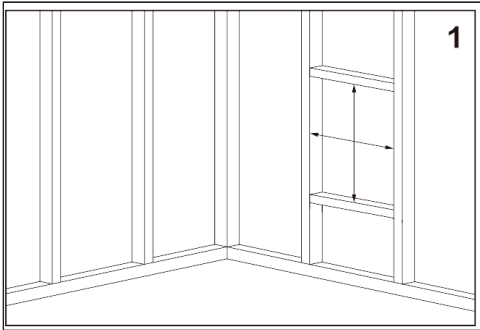

1. Measure the height of the niche and install noggins to suit. The distance between the vertical and horizontal studs must match the dimensions of the niche.

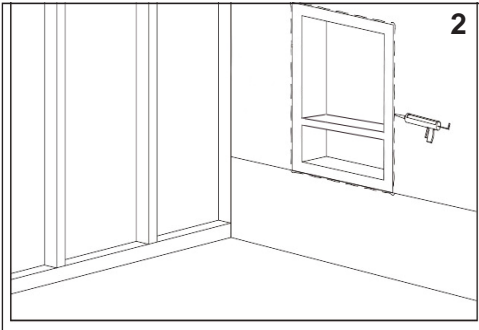

2. Place the shower niche. Apply a suitable silicone sealant to fill the gap between the niche and the sheeting .

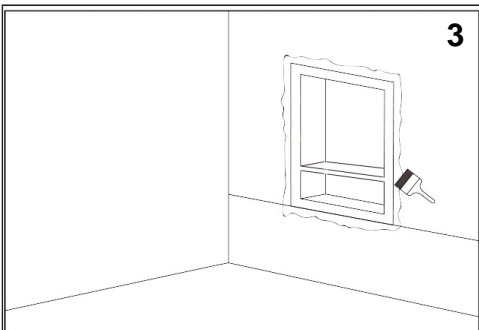

3. Apply waterproofing around all edges of the niche.