



INSTALLATION INSTRUCTIONS

SMC WALL PANEL



ATTACH YOUR RECEIPT HERE

Purchase Date _____

SAFETY INFORMATION

Please read and understand this manual before attempting to install the product.

WARNING



To avoid product damage or personal injury, please follow all the details of this paper before installation. Failure to follow the steps may probably lead to bad results that the panels are detached from the wall surface after installation or personal injury occurs.



Use the appropriate lifting devices to move the load. A two-people cooperation is required when lifting heavy or bulky cartons. DO NOT attempt to lift objects that are over weighted by hands.



Make sure to install this product in a waterless environment. Before installation, dry all surfaces (including the floor) with a cloth or paper towel. Any water or spilled fluids accidentally brought in shall be cleaned up immediately.



Make sure to use personal protective equipment like sturdy work boots, steel toes, gloves and hard hat for your safety.



Open the package and allow the panels to adjust to room temperature for at least six hours before installation. Attention that the wall panels are not allowed to be installed under freezing (32°F). They should be installed in areas where the temperature is no lower than 55°F.

CAUTION

DO NOT damage the panels when opening the package. Lay panels in a flat area to avoid warping until the time of installation. DO NOT store the panels outside of the original packaging in a vertical position.

INSPECT BEFORE CUTTING

Make sure no electrical wiring or plumbing is present before cutting into a wall to install any accessories. Inspect the walls before installing the panels. Never install panels over damp walls or an existing mold condition.

WALL SURFACE PREPARATION

Use the following sections when installing this product.

- Drywall / (Gypsum and Paper Material)
- Moisture Resistant Drywall (Green board)
- Marine Grade Plywood
- Cement Backer Board
- Concrete Walls

WARNING



DUST HAZARD
FUMES HAZARD

CAULKING JOINTS

Inspect caulking joints monthly for damage or any signs of separation from the mating surface. Cracks in the caulking will allow water to leak into the surrounding surfaces. Re-apply caulking to any joint showing signs of wear or cracking

CLEANING AND MAINTENANCE

Simply wipe the surface with a damp towel to remove watermarks and stains. For basic stains, clean with mild detergent or general purpose cleaner. For corners and seams cleaning, spray with mildew cleaner.

WARRANTY

Huasmc is not responsible for any lack of operation or performance of goods (or loss or damage) where the goods have been subject to misuse, negligence or improper installation. All products carry a 5-year warranty.

Wall panels and Accessories

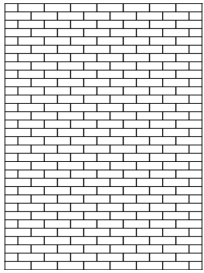

0803 BRICK

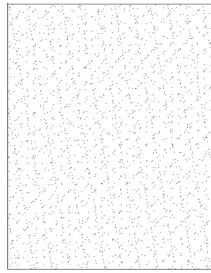

SLATE STONE

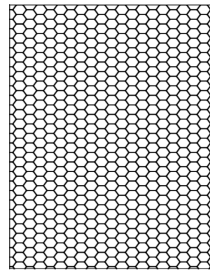

HEXAGON

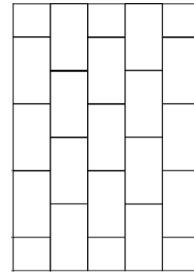

2412 WOOD GRAIN

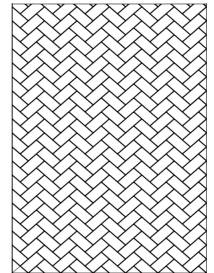

HERRING BONE

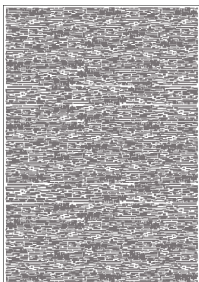

STRIPED ROCK



01

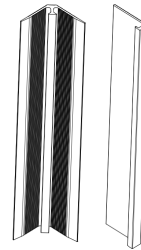

02

OPTIONAL ACCESSORIES
ALUMINIUM ALLOY JOINT AND TRIM KIT

Tools and Materials



SECURITY EQUIPEMENTS
100% CLEAR SILICONE SEALANT
CONSTRUCTION ADHESIVE



GRINDER
CHOICE OF SAW
RUBBER MALLET

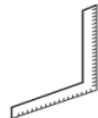
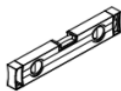

PENCIL
LEVEL
SQUARE
MEASURING TAPE



HOLESAW
UTILITY KNIFE
DRILL WITH 3/8 INCH DRILL BIT
MASKING TAPE
DOUBLE SIDED FOAM ADHESIVE TAPE



LUMBER,AS REQUIRED FOR BRACING
MILD DETERGENT
DENATURED ALCOHOL
CLEAN PAPER TOWELS OR SHOP TOWELS



INSTALLING THE WALL PANEL

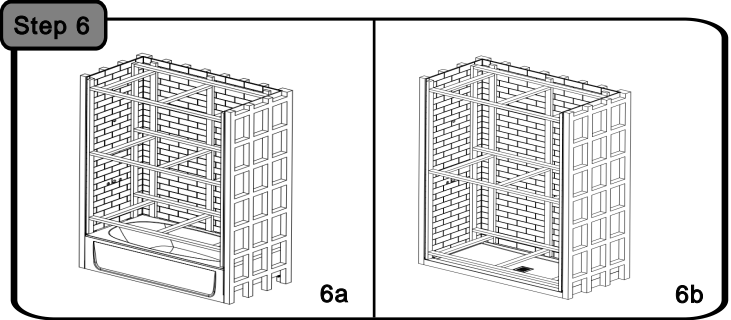
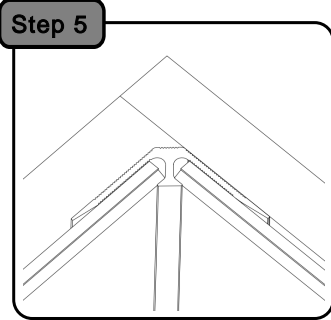
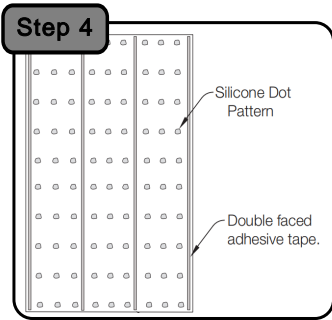
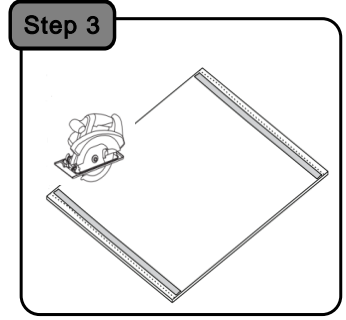
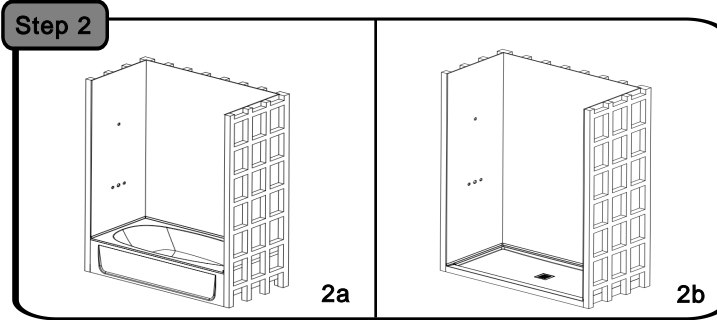
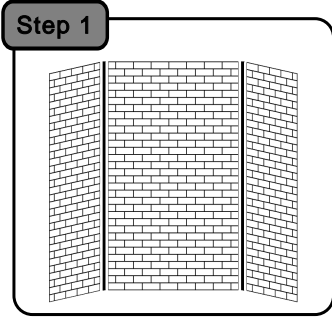

1. Check and Caulk

Open the package, check and make sure all required components are included in. Allow the contents to adjust to room temperature for at least six hours before installation. The wall panels should be installed with the temperature no lower than 55°F while the working space shall be dry. The wall surface must be dry, smooth and free of any dust, soap scum or any other contaminants. And any seams or gaps must be filled with thin set material before panel installation.

2. Wall Surface Preparation

Measure and cut out openings for the faucets, bathtub spout and/or shower head. Reserve space according to the bathtub (2a) or shower tray (2b). Install 1/2 inch moisture-resistant cement board or green board over back, front and rear wall surfaces of the rough opening.

3. Cut and Drill

Place the wall panel, finished side facing up on a flat surface. Place pieces of masking tape over the area where the saw contacts the finished surface of the panel. Cut wall panels according to actual conditions. Drill or cut from the finished side (facing up) of the panel. For best results when drilling, place a scrap of wood beneath the hole to ensure a clean cut. Dry fit the panel and make any necessary adjustments.

4. Secure with Construction Adhesive

Clean the backs of each panel with denatured alcohol or another non oil-based cleaning solvent. Select the panel you are going to install, (usually the back panel). Secure the wall panels with construction adhesive as in Step 4. Carefully align the panel, then press firmly into place against the wall. It is important to apply hand pressure to the entire surface of the panel to bond it into place. Press along all edges to be sure the adhesive tape is secured.

5. Treatment of Splicing Place

For the splicing place between the two wall panels, there are two options: you can use aluminum alloy strips to connect and fix with construction adhesive(see step 5) or directly apply silicone sealant transparent adhesive to seal the joint between the two wall panels.

6. Lumber, as Required for Bracing

Install the temporary bracing to hold the wall panels in place until the silicone sealant is completely set (usually 24 hours). This will allow proper curing of the silicone.