

SPIKA NG 130

115 V / 60 Hz

SELF-CONTAINED ICE CUBE MACHINE

WARRANTY:
ICE MAKERS - 3 YEARS PARTS AND LABOR
EVAPORATOR - 5 YEARS PARTS AND LABOR
COMPRESSOR - 5 YEARS PARTS

FEATURES

- ▶ PRODUCES FULL DICE ICE CUBES OR HALF DICE ICE CUBES.
- ▶ STIF: STRONG INOX FRAME. SOLID MACHINE STRUCTURE IN 4 COLUMNS WITH AISI 304 STAINLESS STEEL FRAME.
- ▶ STRONGEST DOOR IN THE MARKET. MADE OF STAINLESS STEEL. OPENING AND DAMPING SYSTEM PATENTED BY ITV.
- ▶ SMART FRONT VENTILATION SYSTEM, (SFVS) ALLOWS BUILT-IN INSTALLATION OF THE UNIT.
- ▶ CLEANING SWITCH: ALLOWS CIRCULATION OF WATER WITH DESCALING PRODUCT (CALKIN OR SIMILAR) WITHOUT COOLING.
- ▶ "NEVER STOP" MOTOR PUMP DEVELOPED BY ITV. PUMP WITHOUT SEALS, WHICH AVOIDS DETERIORATION IN HARD WATER.
- ▶ EASI: EASY ACCESS FOR SERVICE & INSTALLATION. ALL PANELS CAN BE DISASSEMBLED SEPARATELY.
- ▶ ELECTRONIC CONTROL THAT ENHANCES THE PERFORMANCE OF THE MACHINE AND ALLOWS IT TO ADAPT TO EXTREME CLIMATES.
- ▶ NATURAL GAS R290 WITH VERY LOW GLOBAL WARMING POTENTIAL WHICH ALSO REDUCES THE ENERGY CONSUMPTION.
- ▶ LED ON/OFF SWITCH / PCB MOUNTED AT THE BOTTOM.
- ▶ TROPICALIZED MACHINES (T CLASS) / STAINLESS STEEL ADJUSTABLE LEGS.



	24 H	70°F/20°C 50°F/10°C	90°F/32°C 70°F/21°C	lbs (Kg)	in (mm)	in (mm)	SPIKA HALF DICE 0.9" (W) x 0.43" (D) x 1.02" (H) 23 mm (W) x 11 mm (D) x 26 mm (H) Average dimensions
SPIKA NG 130 A		134 (61)	101 (47)	44.1 (20)	Width 21.07" (535) Depth 23.43" (595) Height* 31.07" (789)	Width 24.02" (610) Depth 25.79" (655) Height 35.83" (910)	SPIKA FULL DICE 1.02" (W) x 0.9" (D) x 1.02" (H) 26 mm (W) x 23 mm (D) x 26 mm (H) Average dimensions
SPIKA NG 130 W		-	-				

* WITH LEGS 35"/37"

ACCESSORIES

INCLUDED



10" FILTER ANTI-LIMESCALE + ANTI-CHLORINE
PRO-10 K
 #33738



10" REPLACEMENT CARTRIDGE ANTI-LIMESCALE + ANTI-CHLORINE
PRO-10
 #33742



SCALE KLEEN
 #4033



ONE FOOT PAD
 ITEM #4144

TECHNICAL SCHEME

SPIKA NG 130

FRONTAL VIEW

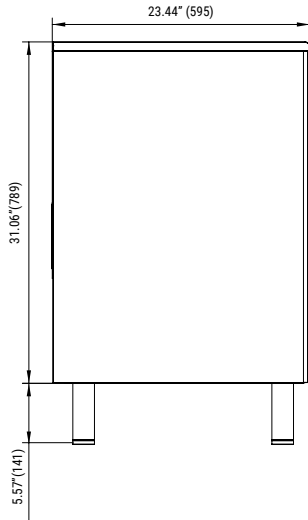

SIDE VIEW

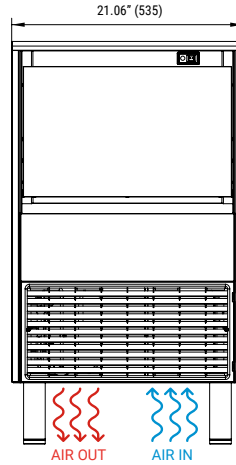

REAR VIEW

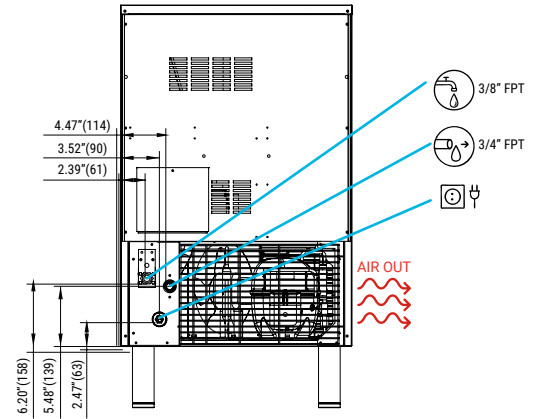

* All dimensions in inches (and mm)

OPERATING CONDITIONS

PRODUCTION (LBS) 60Hz

±10% V

41°F/109°F

41°F/95°F

14.5 psi (1 bar) / 87 psi (6 bar)

75/150 Ice cubes/cycle

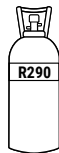

V	Hz	ph
115	60	1N



FULL DICE
SPIKA NG 130 AIR COOLED

	50° 10°	60° 15°	70° 21°	86° 30°
50° 10°	141	130	121	110
68° 20°	139	126	112	99
90° 32°	134	112	101	90
109° 43°	108	82	71	60



FULL DICE
SPIKA NG 130 WATER COOLED

	50° 10°	60° 15°	70° 21°	86° 30°
50° 10°	-	-	-	-
68° 20°	-	-	-	-
90° 32°	-	-	-	-
109° 43°	-	-	-	-

MODELS

SPIKA NG 130 A

SPIKA NG 130 W

	ASHRAE CONDITIONS (BTU/h) (W)	(W) 109°F	(AWG/mm ²) (n.)	FUSE	100lbs 90°F / 70°F (Kwh/100 lbs)	gal 100lbs (l/h)	HEAT REJECTED (BTU/h) (W)	(lbs)	(lbs)
SPIKA NG 130 A	2,943 862	375	16/1.5 3	16	8.7	1.24 4.7	1,605 470	106	123,5
SPIKA NG 130 W	-	-	-	-	-	-	-	-	-



ITV Ice Makers, Inc.
9550 Satellite Blvd, Suite 100
Orlando, FL 32837
Phone: 1 407 826 1860 | Fax: 1 407 826 1861
Toll Free: 1 888 488 1423
sales@itvice.com | www.itvice.com

SERVICE
service@itvice.com
Skype: service@itvice.com
PHONE: +1 888 488 1423
FROM 8AM TO 5PM EST

WARRANTY:
ICE MAKERS - 3 YEARS PARTS AND LABOR
EVAPORATOR - 5 YEARS PARTS AND LABOR
COMPRESSOR - 5 YEARS PARTS

