



ICE QUEEN IQ F 900

115 V / 60 Hz

MODULAR FLAKE ICE MACHINE

3 YEARS WARRANTY
PARTS & LABOR

FEATURES

- ▶ PRODUCES FLAKE ICE
- ▶ HIGH EVAPORATOR EFFICIENCY: LOWER ENERGY CONSUMPTION AND HIGHER ICE PRODUCTION
- ▶ FRONT LED DISPLAY FOR QUICK DIAGNOSTICS
- ▶ I-CHECK SMART SYSTEM CONTROLS AND DETECTS PARAMETERS AND FAULTS
- ▶ ELECTRONIC CONTROL. ON/OFF LIGHTED SWITCH IN FRONT PANEL
- ▶ STAINLESS STEEL AUGER TO MAXIMIZE LIFESPAN
- ▶ POWERFUL GEAR MOTOR
- ▶ AISI 304 STAINLESS STEEL BODY
- ▶ OPTICAL PINPOINT CONTROL SYSTEM TO SET ICE STOCK LEVEL
- ▶ EASY ACCESS FOR SERVICE AND INSTALLATION



! THE INSTALLATION OF AN ANTI-SCALE FILTER AND PERIODIC CLEANING ARE RECOMMENDED IN AREAS WITH MEDIUM OR HIGH LIMESCALE CONTENT (HARD WATER)

- EASI**
Easy Access for Service & Installation
- STIF**
Strong Innox Frame
- FRONT VENTILATION**

	lbs 24 H	70°F/21°C 50°F/10°C	90°F/32°C 70°F/21°C	in (mm)	in (mm)
		lbs (Kg)	lbs (Kg)		
IQ F 900 A		860 (390)	664 (301)	Width 22" (559) Depth 24.5" (622) Height 28" (712)	Width 25" (636) Depth 27.4" (695) Height 32.9" (835)
IQ F 900 W		-	-		



ACCESSORIES

NOT INCLUDED (OPTIONAL)



10" FILTER
ANTI-LIMESCALE + ANTI-CHLORINE
CS-101 K



10" REPLACEMENT CARTRIDGE
ANTI-LIMESCALE + ANTI-CHLORINE
CS10



SCALE KLEEN

RECOMMENDED BINS



S400-22 + IQ F 900

S500 + IQ F 900

S750 + IQ F 900

S900 + IQ F 900

S1050 + IQ F 900

SCS350 + IQ F 900

SCS700 + IQ F 900

SCD900 + IQ F 900

SCD1400 + IQ F 900

SCD1800 + IQ F 900

TECHNICAL SCHEME

ICE QUEEN F 900

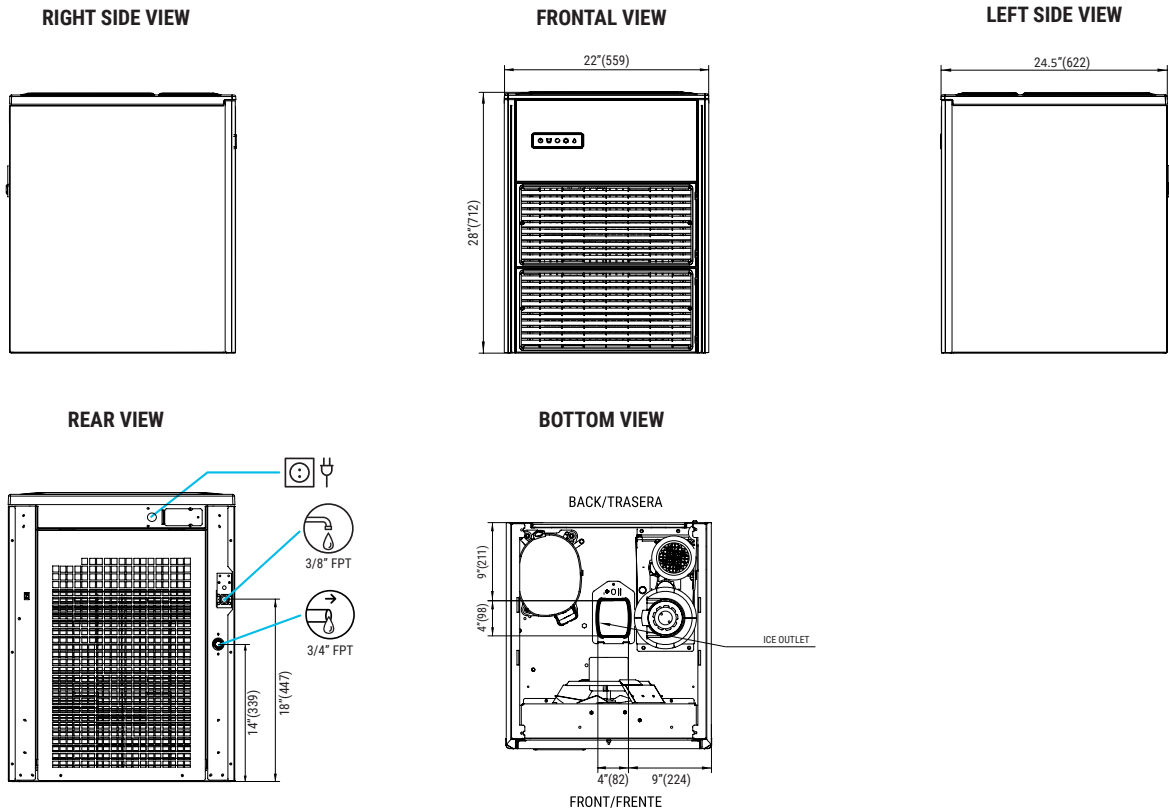

* All dimensions in inches (and mm)

OPERATING CONDITIONS

PRODUCTION (LBS) 60Hz

Voltage	Frequency	Pressure	IQF 900 AIR COOLED					IQF 900 WATER COOLED				
			50° 10°	60° 15°	70° 21°	86° 30°	50° 10°	60° 15°	70° 21°	86° 30°		
±10% V	60 Hz	14.5 psi (1 bar) / 87 psi (6 bar)	904	860	728	617	-	-	-	-		
50°F/109°F			860	818	699	586	-	-	-	-		
41°F/100°F			833	776	664	545	-	-	-	-		
			761	728	635	498	-	-	-	-		

MODELS	Temp. Ev. (°F)	ASHRAE CONDITIONS (BTU/h)	(W)	(W) 109°F	(AWG/mm ²)	(n.)	FUSE	100lbs 90°F / 70°F (Kwh/100 lbs)	gal 100lbs (l/h)	HEAT REJECTED (BTU/h)	(W)	(lbs)	(lbs)
IQ F 900 A	5°	12,325	3,612	1,480	16/1.5	3	20	5.9	11.9 12.5	6,190	1,814	185	205
IQ F 900 W	-	-	-	-	-	-	-	-	-	-	-	-	-



3 YEARS WARRANTY PARTS & LABOR



ITV Ice Makers, Inc.
9550 Satellite Blvd, Suite 100
Orlando, FL 32837
Phone: 1 407 826 1860 | Fax: 1 407 826 1861
Toll Free: 1 888 488 1423
sales@itvice.com | www.itvice.com

SERVICE
service@itvice.com
Skype: service@itvice.com
PHONE: +1 888 488 1423
FROM 8AM TO 5PM EST

2 ADDITIONAL YEARS ON COMPRESSOR & EVAPORATOR
Read our warranty policy to know more about limitations and exclusions

Intertek

