

**MODEL: IMD-ERV36IISD / IMD-ERV25IISD
 IMD-ERV84IISD**

BACK BAR COLLERS: NARROW BACK BAR COOLERS



General Strengths

- ✓ **Sanitation.** Quick ability to take off shelves and slides for interior cleaning.
- ✓ **Doors.** All doors include door gaskets, easy to remove and snap in.
- ✓ **Control systems.** Higher precision in managing temperature settings. Greater ability for the adjustment of temperatures ranges as per the end user's requirement.
- ✓ **100% Tested.** All condenser units are tested 100%, in helium chambers for refrigerant leak detections.
- ✓ **Certified.** Audited and Certified by **INTERTEK** for compliance with UL 471 and NSF 7. EQA audited and certified by internationally recognized firm. ISO 9001:2015 (Quality); ISO 14001:2015 (Environmental); ISO 45001:2018 (Prevention and Worker Safety)
- ✓ **Lighting.** LED lighting in cabinet sides reduces the energy consumption by 80% and 90% compared to a traditional bulb. Provides a much better light quality.



STANDARD FEATURES

➤ **Exterior**

- AISI 430 Stainless Steel.
- Leveling feet.

➤ **Interior**

- AISI 430 Stainless Steel.
- Sealed interior floors.

➤ **Doors**

- Doors built in thermopane double glass.
- Self closing doors with stay open feature.
- Stainless Steel heavy-duty hinges.
- Triple chamber snap in door gaskets for easy removal and cleaning.
- Doors locks.
- Door opening: 19-5/8" x 26-7/8" (500x682 mm).

➤ **Insulation**

- Polyurethane with high density 40kg/m³, CFSs free, zero ODP and low GWP.

➤ **Shelving**

- (2) Plastic coated wire shelves per section.
- Set of Stainless Steel shelf brackets.
- Easy remove for cleaning.

➤ **Refrigeration**

- Digital temperatura controller with automatic defrost system.
- Energy-saving non-electric condensate pan.
- Front-breathing refrigeration system.
- Electric fans.
- Evaporative pan.
- Evaporator coil coated with anti-corrosion material.
- Refrigeration capacity:
 IMD-ERV36IIGD - 867 Btu/h (14°F) / 254W (-10°C)
 IMD-ERV60IIGD - 867 Btu/h (14°F) / 254W (-10°C)
 IMD-ERV84IIGD - 1348 Btu/h (14°F) / 395W (-10°C)

OPTIONAL FEATURES

- ✓ Set of 2" Casters, front locking
- ✓ Electrical connection is 220-230 V / 1ph / 50Hz (plug type varies).
- ✓ Electrical connection is 220-230 V / 1ph / 60Hz (plug type varies).

➤ **Electrical**

- Cord and NEMA 5-15P plug,
- Electrical connection is 115 V / 1ph / 60 Hz.



**MODEL: IMD-ERV36IISD / IMD-ERV25IISD
 IMD-ERV84IISD**

BACK BAR COLLERS: NARROW BACK BAR COOLERS

MODELS	(inches) (mm)			Doors	Shelves	Ref.	Ref.Weight (Lbs.) (gr.)	Temperature Range (°F) (°C)	Unit	(Cu.Ft.) (L)	Amps 115V	weight (Lbs.) (Kg.)
	W	D	H									
IMD-ERV36IIGD	36-1/4 (922)	23-3/4 (604)	34-1/2 (877)	1	2	R290	0,24 (110)	33 °F/ 38 °F (+2°C/+8°C)	1/5	5 (162)	3,59	290 132
IMD-ERV60IIGD	60-3/4 (1543)	23-3/4 (604)	34-1/2 (877)	2	4	R290	0,26 (120)	33 °F/ 38 °F (+2°C/+8°C)	1/5	8 (362)	5,2	390 177
IMD-ERV84IIGD	53-1/8 (1350)	20-1/8 (510)	35-3/4 (907)	3	6	R290	0,26 (120)	33 °F/ 38 °F (+2°C/+8°C)	1/3	11,6 (562)	6	500 227

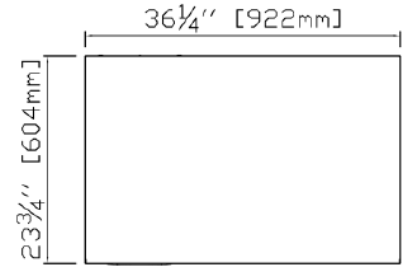
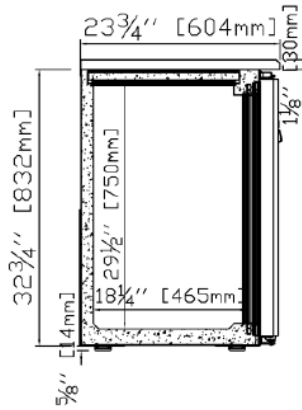
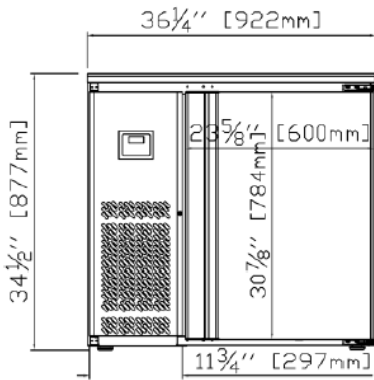

IMD-ERV36IIGD

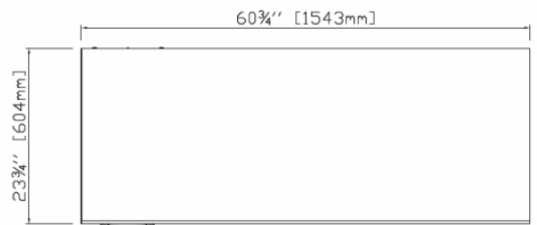
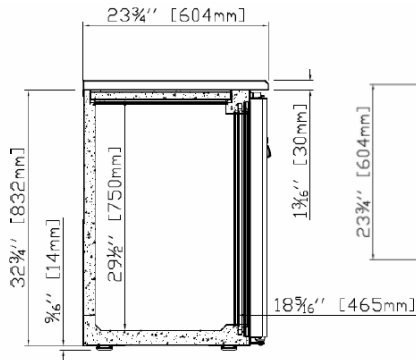
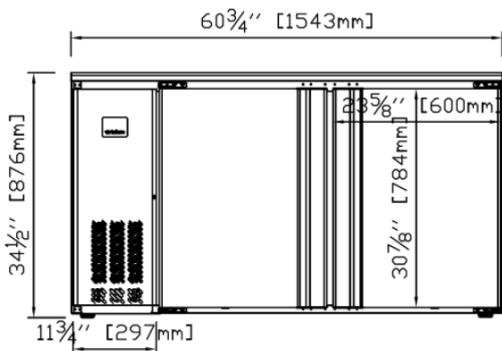

IMD-ERV60IIGD



Project: _____

Location: _____

Item #: _____ Quantity: _____

Model #: _____

MODEL: **IMD-ERV36IIGD / IMD-ERV25IIGD**
IMD-ERV84IIGD

BACK BAR COLLERS: NARROW BACK BAR COOLERS

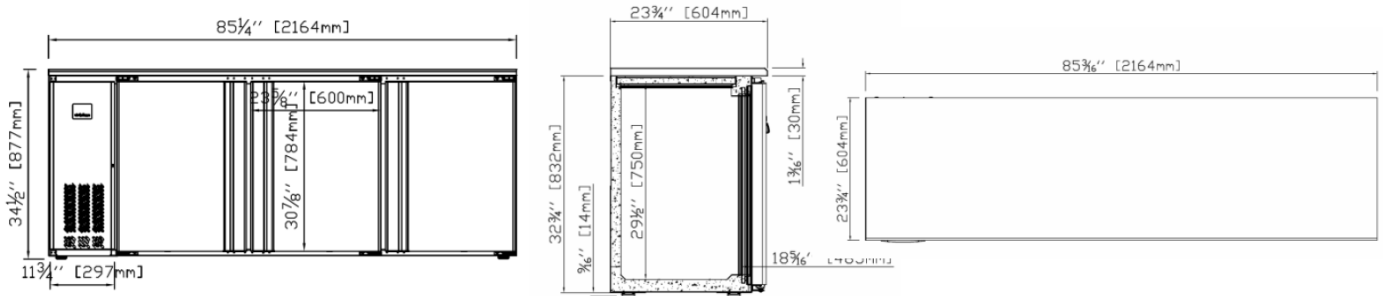

IMD-ERV84IIGD

Review:03 Date: 02/11/2024 IMD-ERV36_60_48_IISD

ETL LISTED TO UL471 STANDARD AND SANITATION CLASSIFIED TO NSF7 – WE RESERVE THE RIGHT TO CHANGE SPECIFICATIONS WITHOUT PRIOR NOTICE



INFRICO-North America Corporate División
1409NW 84th Avenue, Doral FL 33126
(305) 777 9599 ext.700 / f (305) 777 9598
Toll Free 855-340-4637

www.infrico.us
sales@infrico.com